

FRONT BODY PILLAR (CUT)

REMOVAL (With the cowl top side panel removed.)

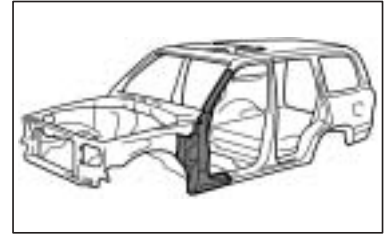

Cut and Join Location
(Cut Location for Supply Parts)

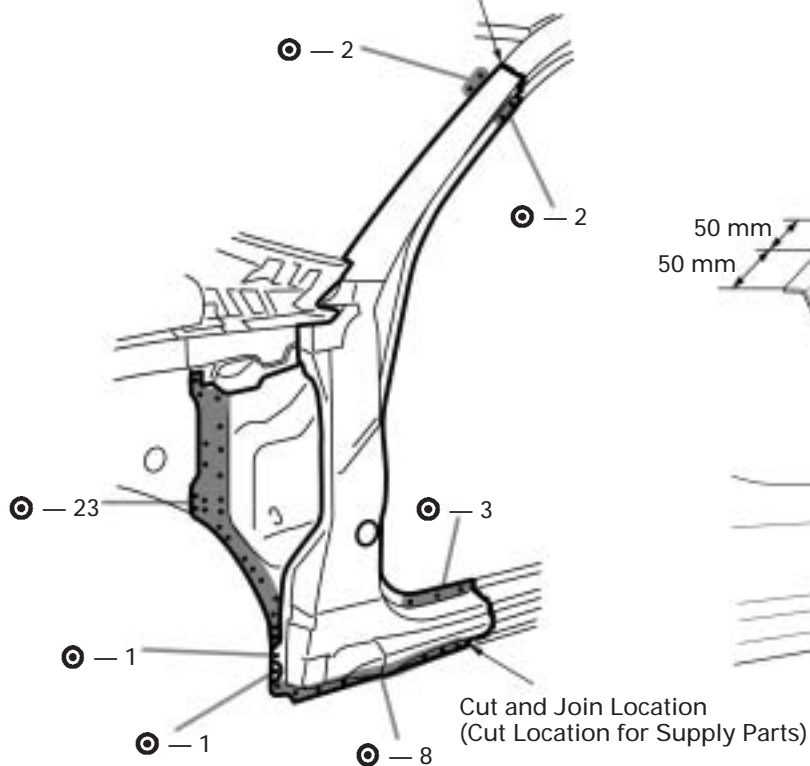

[Cut and Join Locations]

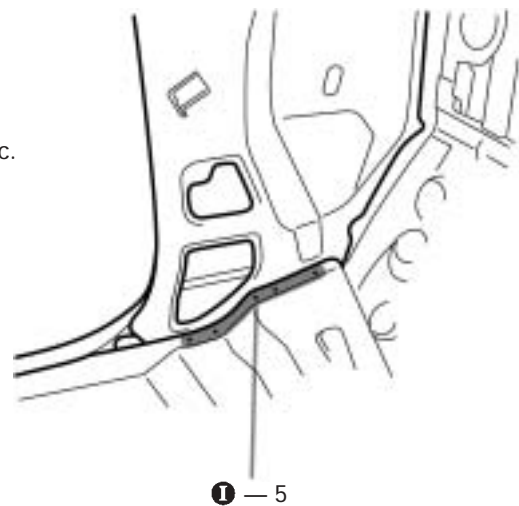
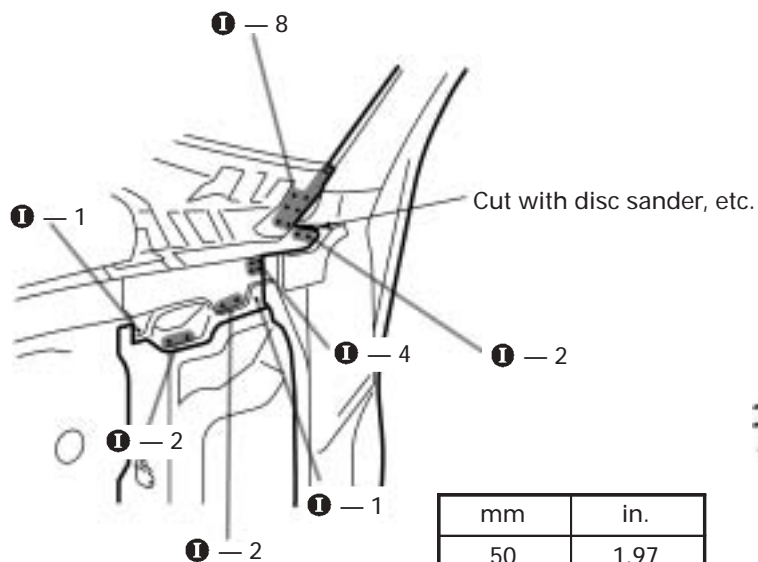
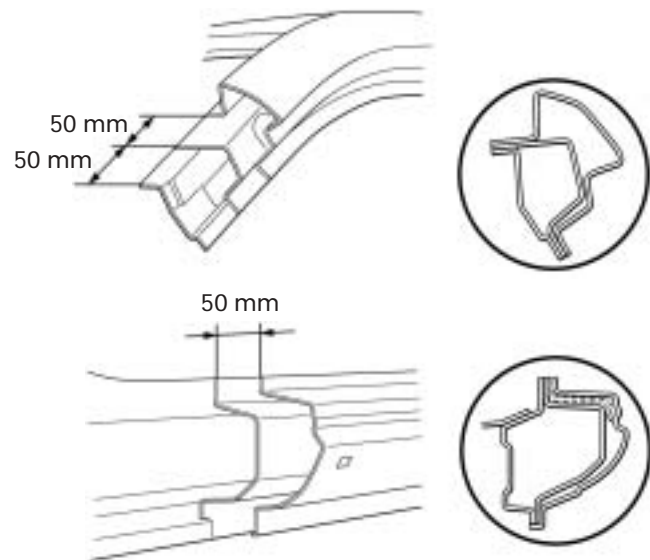

mm	in.
50	1.97

1. Cut and join the parts at the locations as shown above.
2. Cut and join the outer pillar and reinforcement and inner pillar at position shifted about 50 mm (1.97 in.)
3. Cut and join the rocker outer panel and rocker panel reinforcement at position shifted about 50 mm (1.97 in.)

INSTALLATION

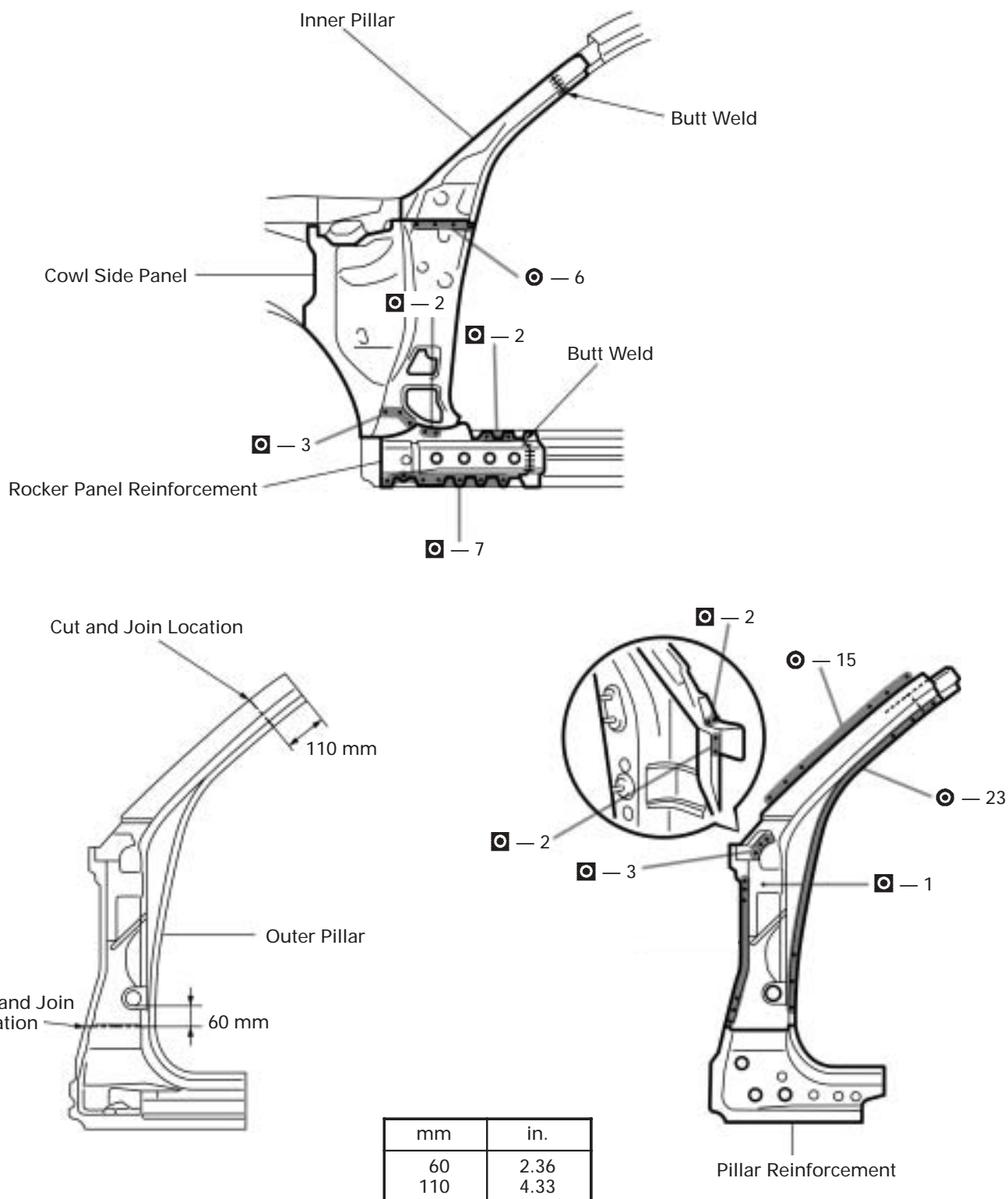

1. Install the inner pillar and rocker panel reinforcement to the vehicle side.
2. Cut the new parts for the outer pillar at the locations as shown above.
3. Before temporarily installing the new parts. Weld the pillar reinforcement and outer pillar with standard points.

HINT: After welding the pillar reinforcement finally attach it to the cut and join location tips.

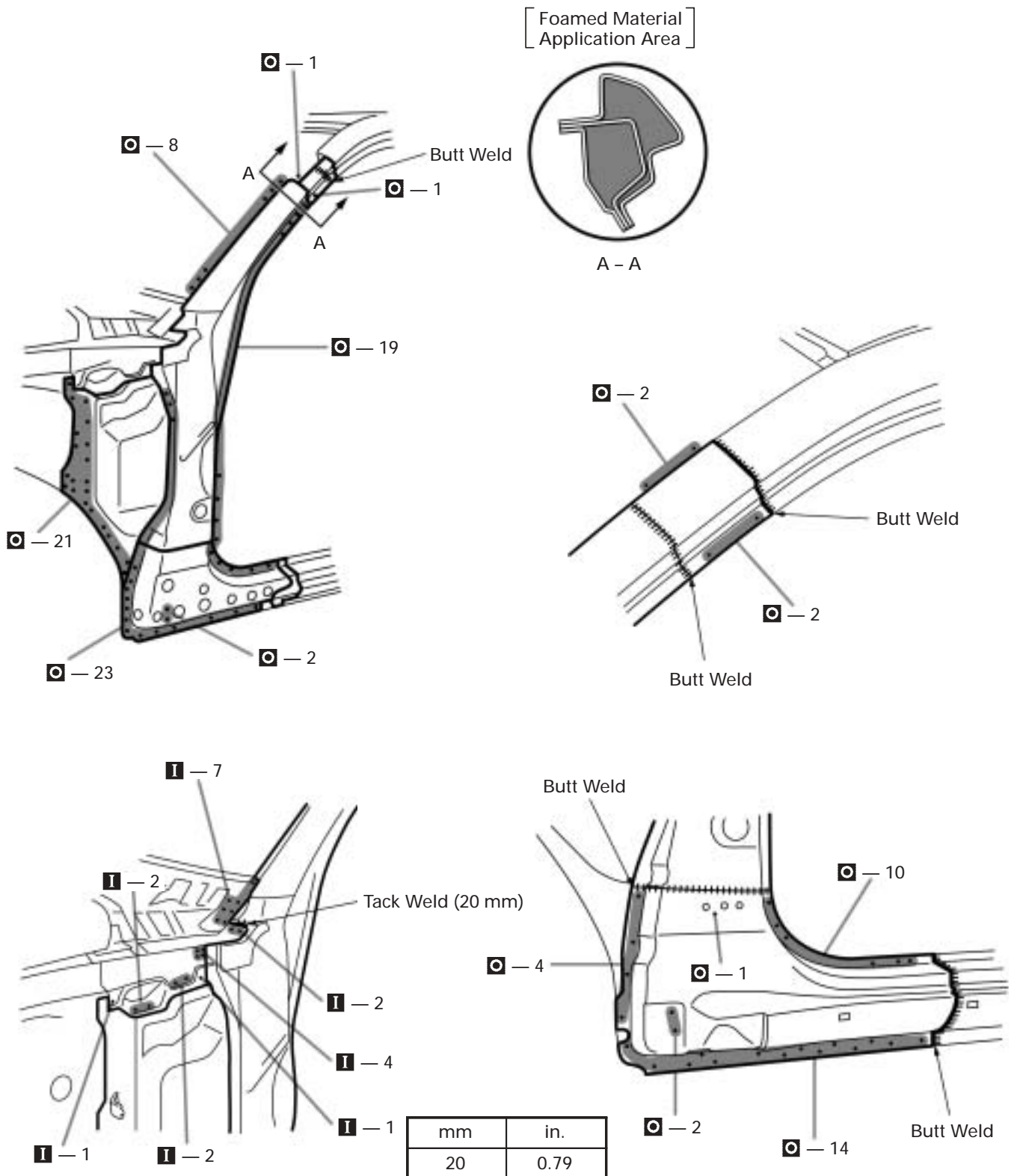

4. Temporarily install the new parts and measure each part in accordance with the body dimension diagram.
5. Before welding the new parts, check the fit of the front door, front fender and windshield glass.
6. Apply foamed material to the pillar section.