

## FRONT DOOR OUTER PANEL (ASSY)

### REMOVAL

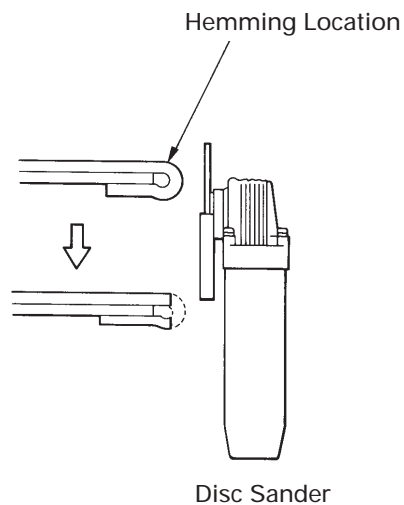
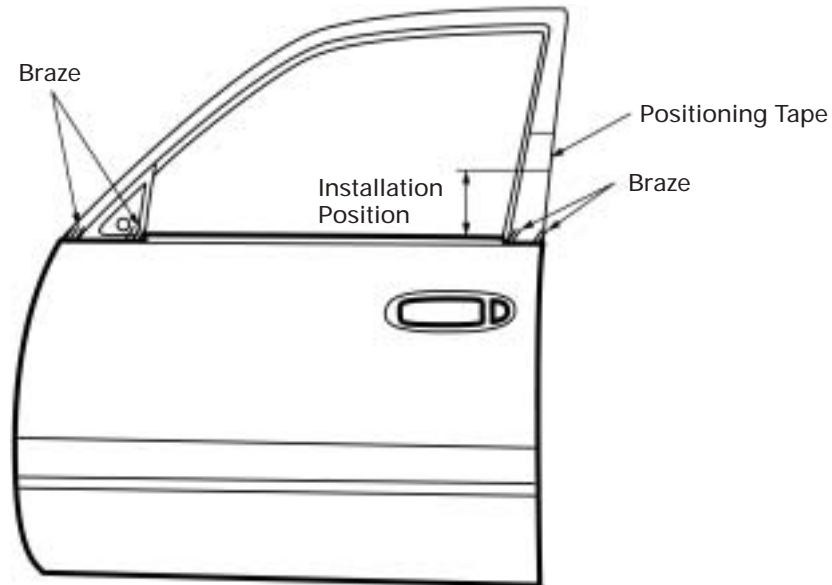
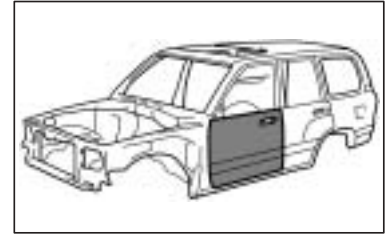

1. Before removing the outer panel, make the installation position with a tape.
2. After grinding off the hemming location, remove the outer panel.

## INSTALLATION

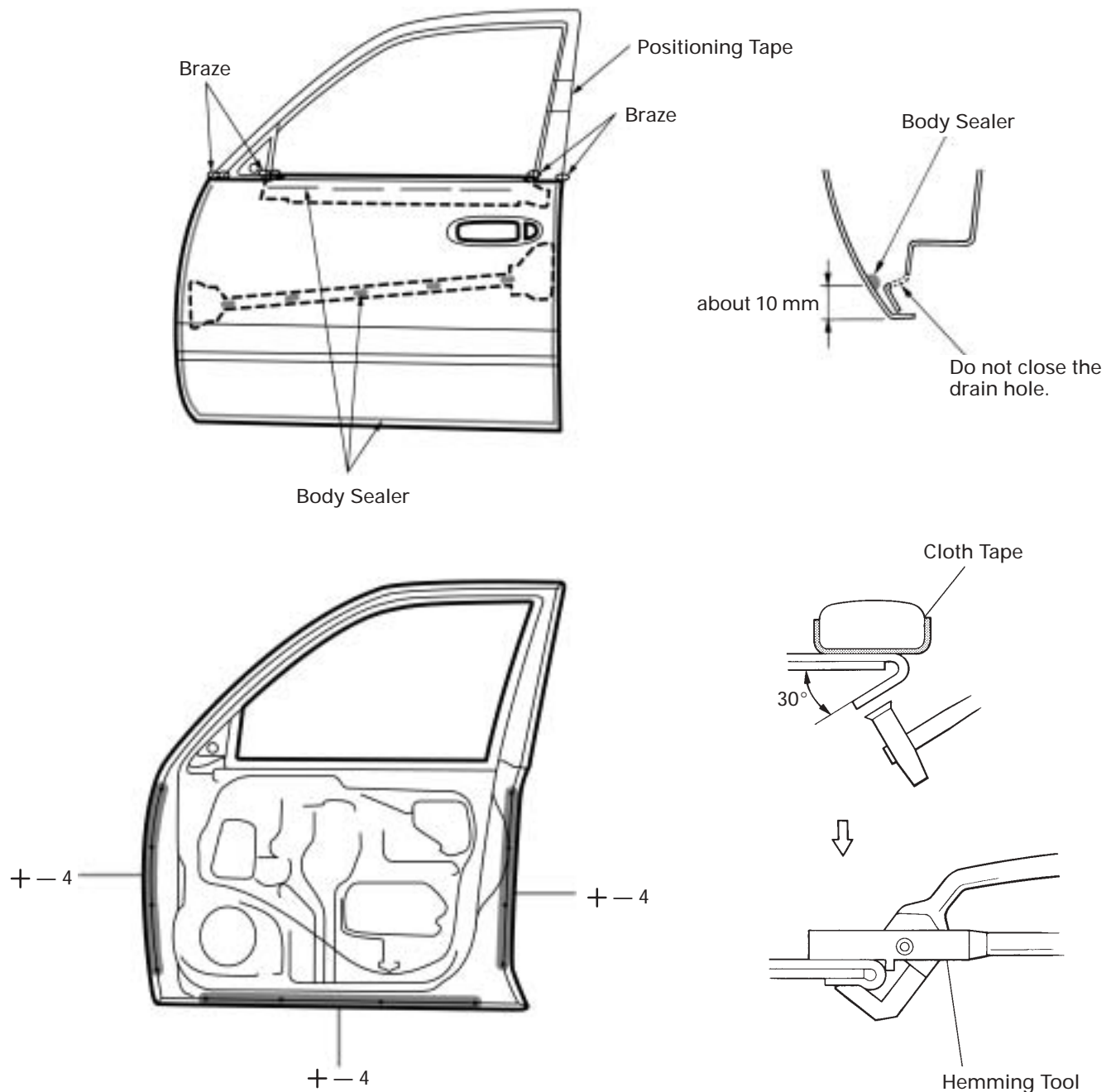

mm	in.
10	0.39

1. Before temporarily installing the new parts, apply body sealer to the reinforcement, side impact protection beam and back side of the new parts.

**HINT:**

- 1) Apply sealer evenly about 10 mm (0.39 in.) from the flange and 3 mm (0.12 in.) in diameter to the outer panel and apply just enough sealer for the reinforcement and side impact protection beam to make contact.
- 2) For other sealing points, refer to section AR.

2. Bend the flange hem about 30° with a hammer and dolly, then fasten tightly with a hemming tool.

**HINT:**

- 1) Perform hemming in three steps, being careful not to warp the panel.
- 2) If a hemming tool cannot be used, hem with a hammer and dolly.