

QUARTER PANEL (CUT)

REMOVAL

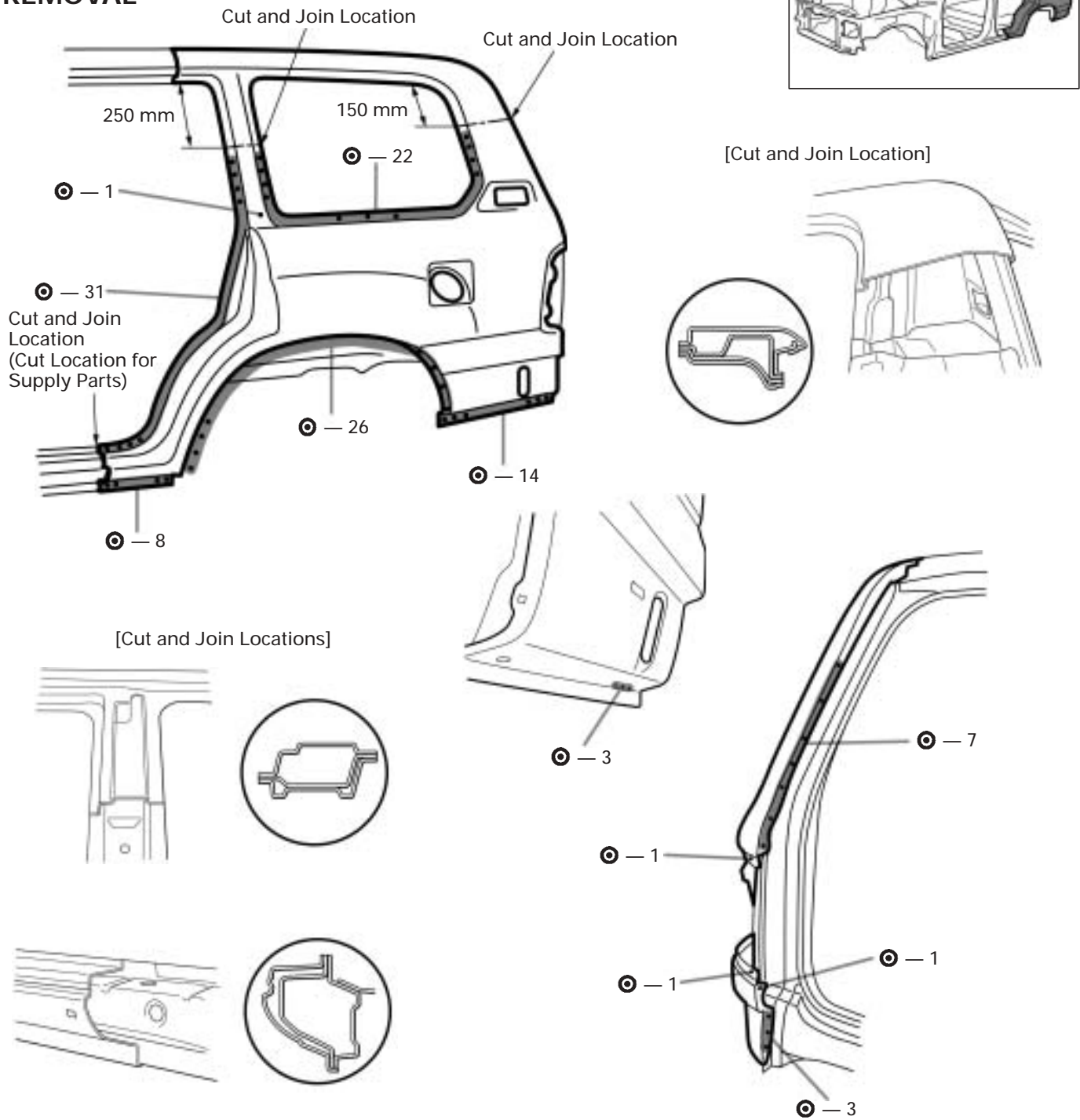

1. Cut and join the parts at the locations as shown above.

mm	in.
150	5.91
250	9.84

INSTALLATION

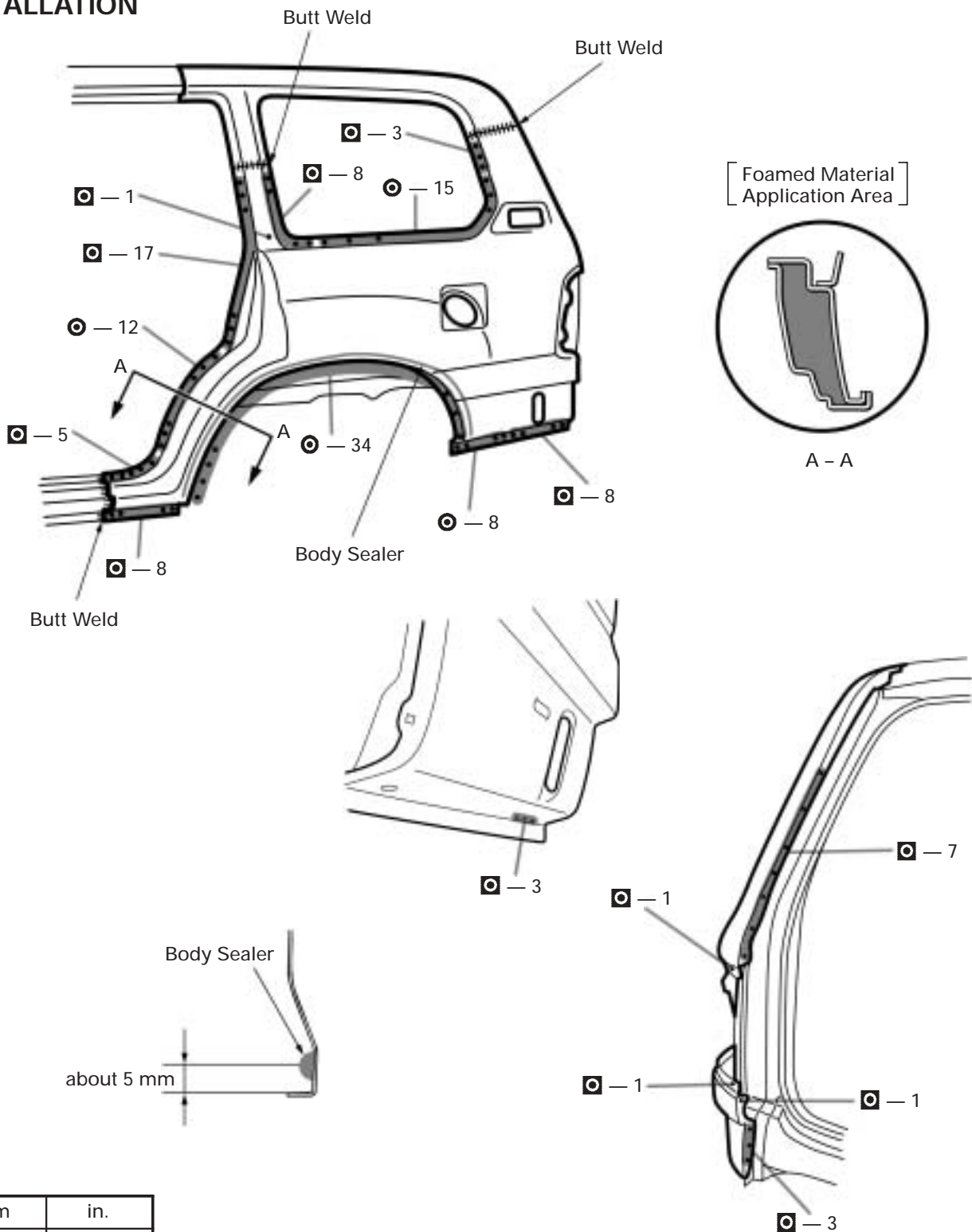

mm	in.
5	0.20

- Before temporarily installing the new parts, apply body sealer to the wheel arch.
 - Temporarily install the new parts and check the fit of the rear door, back door, tail gate or back door and rear combination light.
 - After installing the new parts, apply foamed materials.
- HINT:**
- Apply body sealer about 5 mm (0.20 in.) from the flange, avoiding any oozing.
 - Apply sealer evenly, about 3 - 4 mm (0.12 - 0.16 in.) in diameter.
 - For other sealing points, refer to section AR.