

QUARTER PANEL (CUT-P)

REMOVAL

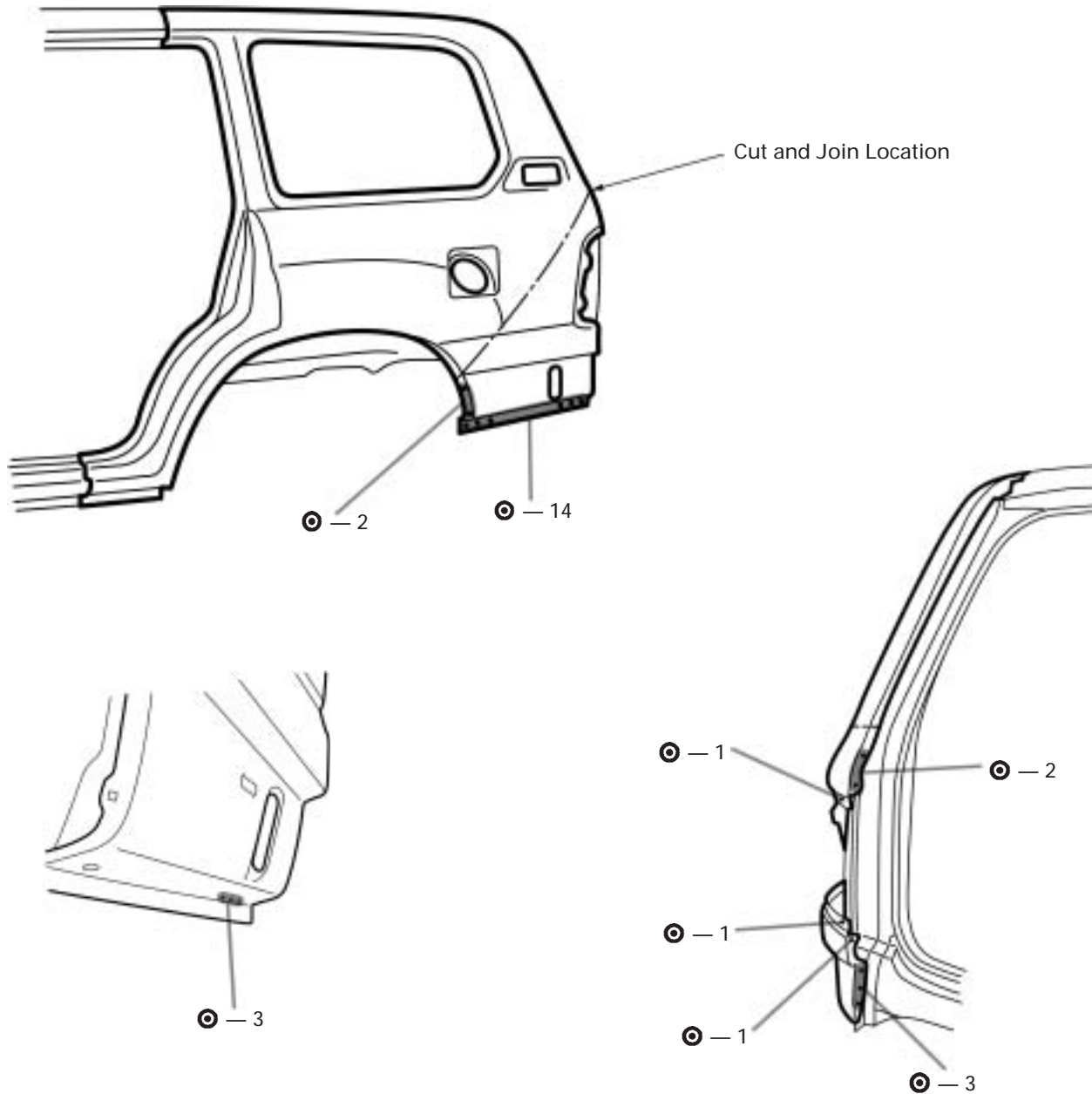
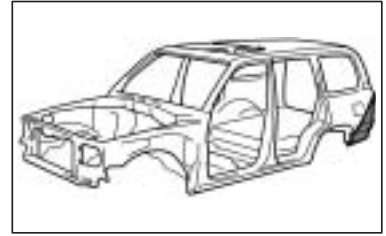

1. Cut and join the parts at the location as shown above.

INSTALLATION

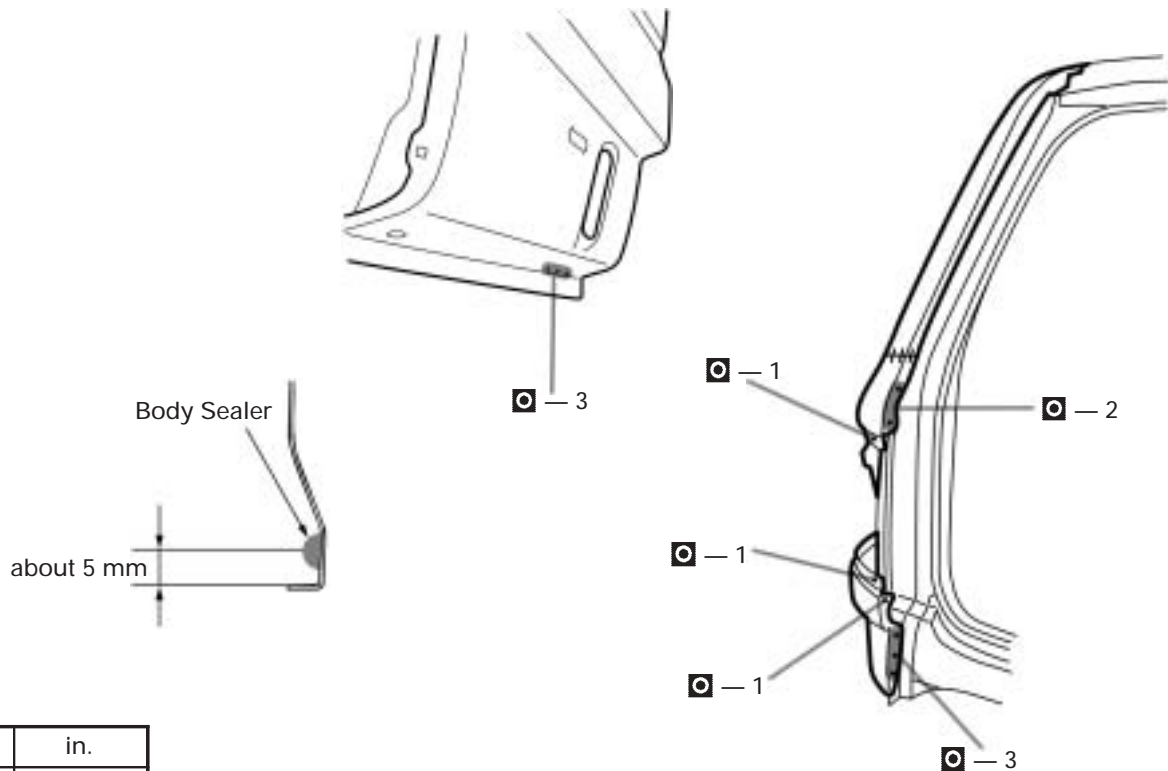
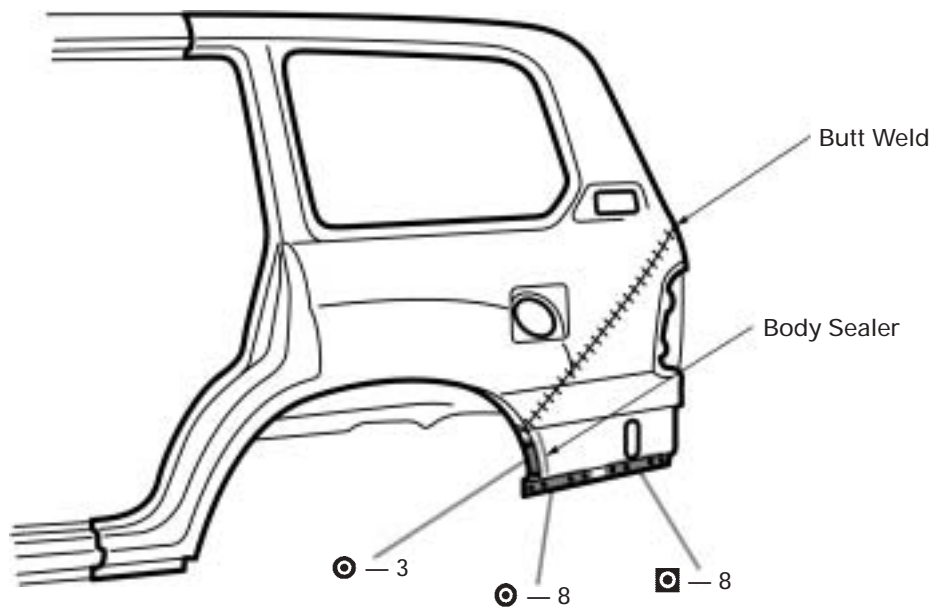

mm	in.
5	0.20

- Before temporarily installing the new parts, apply body sealer to the wheel arch.
- Temporarily install the new parts and check the fit of the tail gate or back door and rear combination light.

HINT:

- Apply body sealer about 5 mm (0.20 in.) from the flange, avoiding any oozing.
- Apply sealer evenly, about 3 – 4 mm (0.12 – 0.16 in.) in diameter.
- For other sealing points, refer to section AR.