

## ROOF PANEL (ASSY): Moon Roof

### REMOVAL

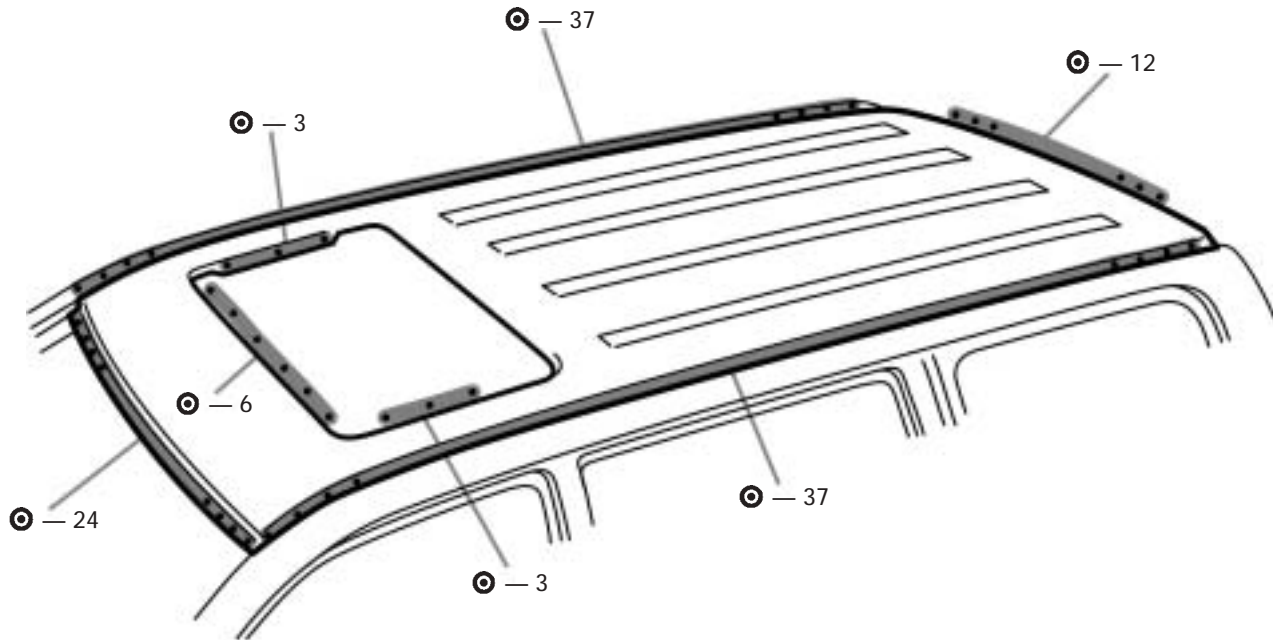

[If reusing the roof panel reinforcement]

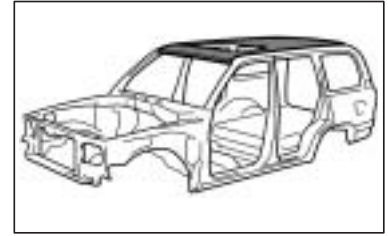
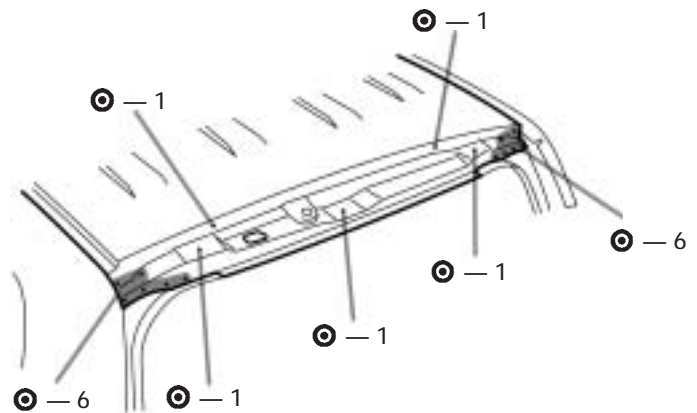
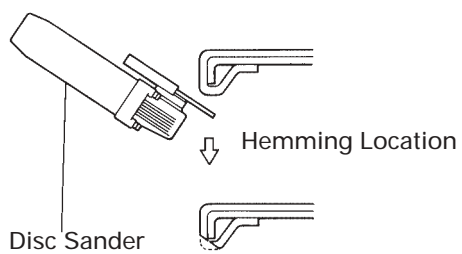

## INSTALLATION

[Foamed Material  
Application Area]

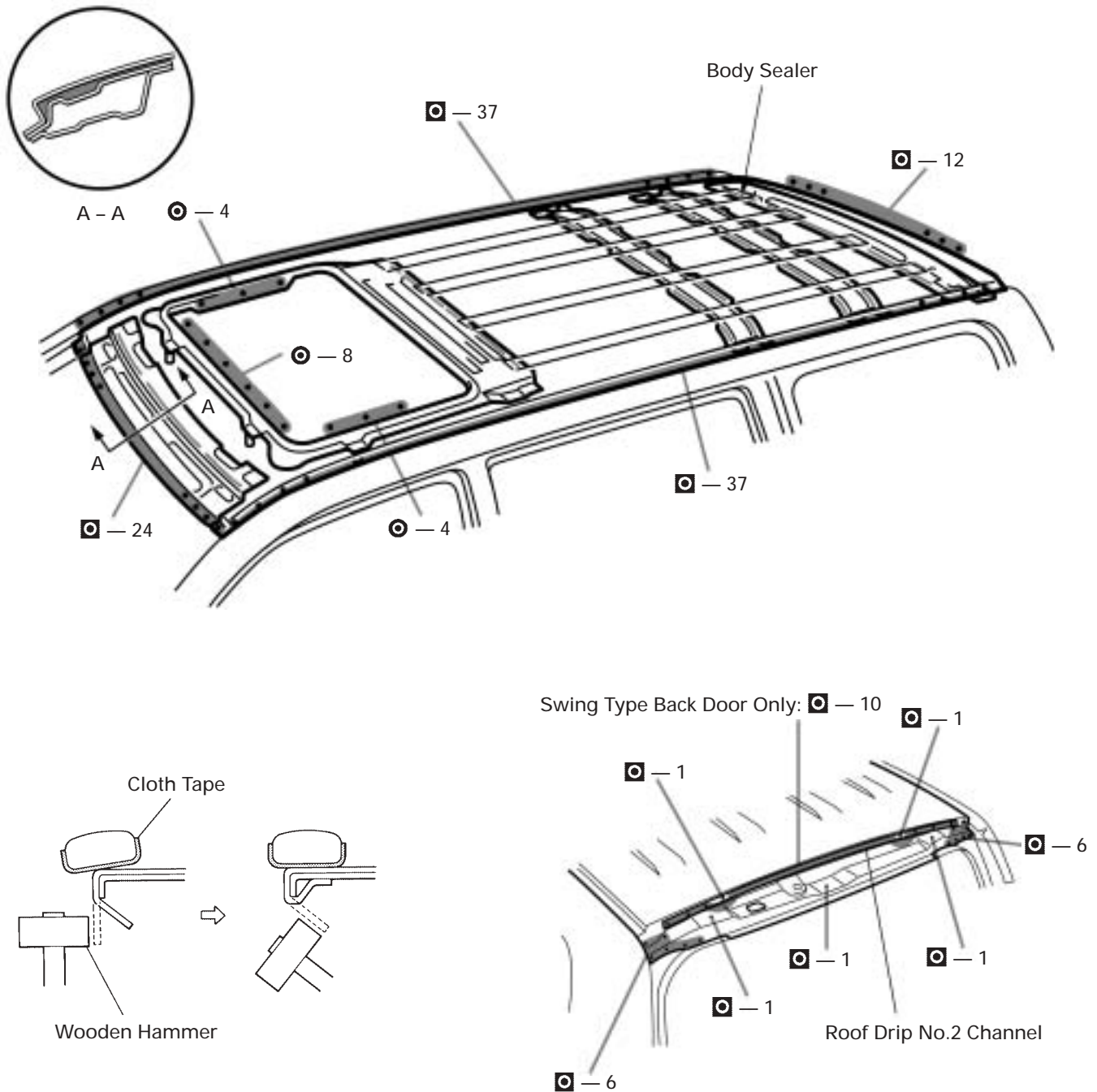

1. Before temporarily installing the new parts, apply body sealer to the windshield header panel, roof panel reinforcement and back window frame.

**HINT:**

- 1) Apply just enough sealer for the new parts to make contact.
- 2) For other sealing points, refer to Section AR.

2. Bend the flange hem with a wooden hammer and dolly.

**HINT:** Perform hemming three steps, being careful not to warp the panel.

3. After installing the new parts, apply foamed materials.