

STEERING

■ DESCRIPTION

- As in the previous model, the engine revolution sensing type recirculating ball type power steering is used for the rigid axle front suspension model.
- The engine revolution sensing type rack and pinion power steering is used for the independent front suspension model.
- A compact and lightweight tilt mechanism is used.
- A power tilt and power telescopic mechanism is optional equipment for the independent front suspension model except 1FZ-FE engine model for G.C.C. Countries and the swing type back door model for General Countries.
- An energy absorbing plate type energy absorbing mechanism is used in the steering column.

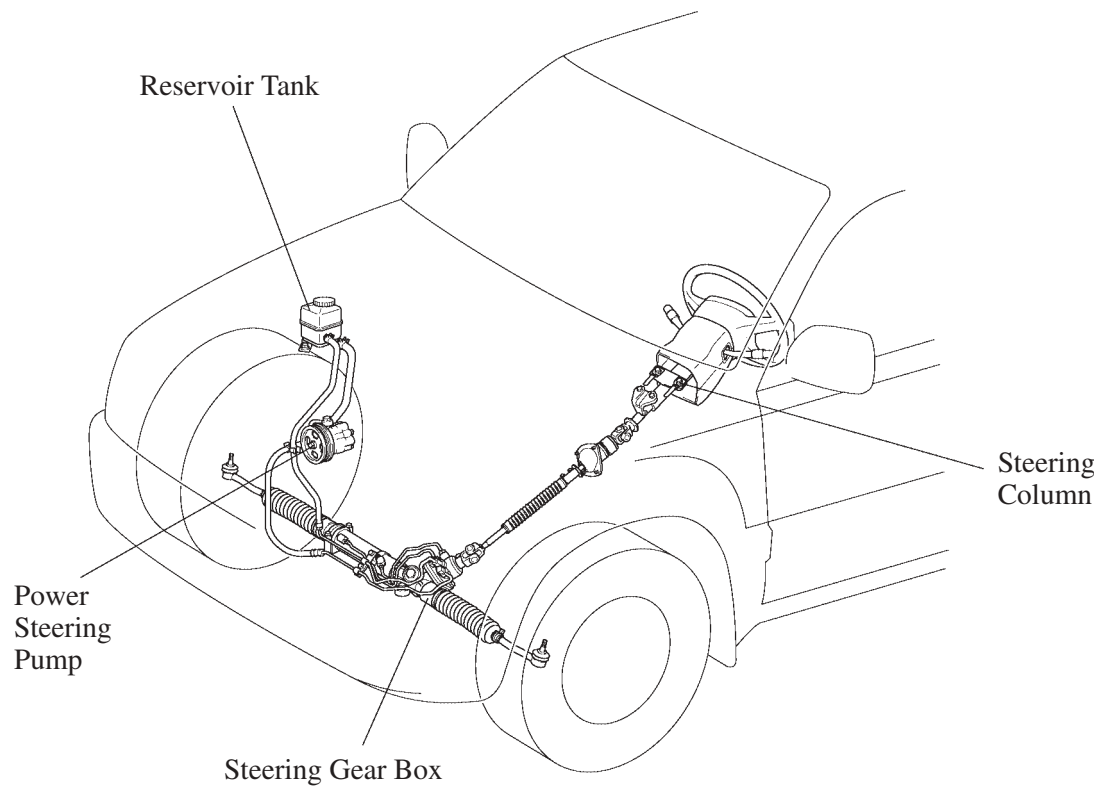

156CH31

LHD Model with 2UZ-FE Engine

► Specifications ◀

Steering Gear Type	Recirculating Ball Type	Rack and Pinion Type
Gear Ratio (Overall)	18.59	19.8
No. of Turns Lock to Lock	3.4	3.8
Rack Stroke mm (in.)	—	178 (7.01)
Fluid Type	ATF Type DEXRON®II or III	←