

■ TILT STEERING

A tilt mechanism consists of a column upper tube, lower tube, pawl, tilt retainer, tilt lever and tension springs etc.

The pawl is attached to the column upper tube. Under spring tension, the pawl is pushed by the tilt retainer against the ratchet in the lower tube, thus locking the tilt steering.

By operating the tilt lever, the tilt retainer moves in unison to release the pawl. The pawl disengages from the ratchet in the lower tube, allowing the steering to tilt.

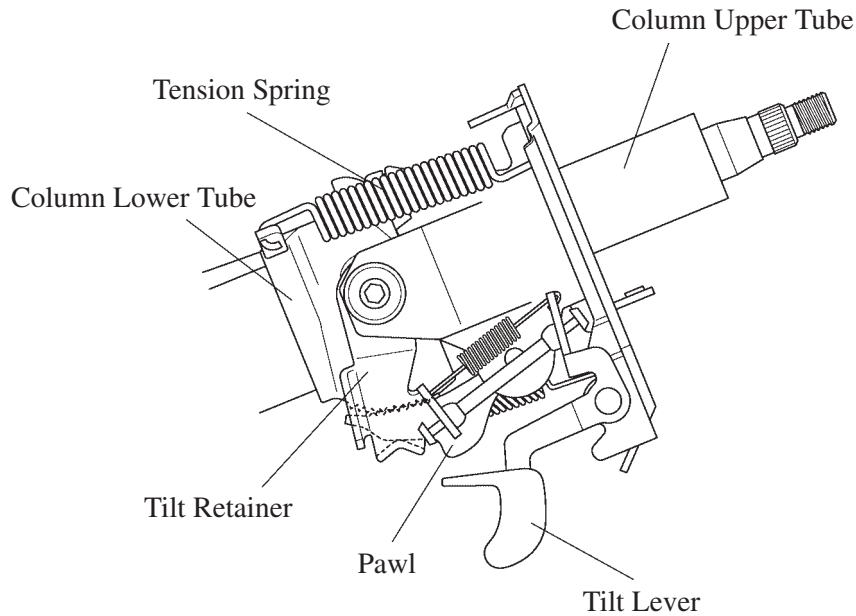

156CH02

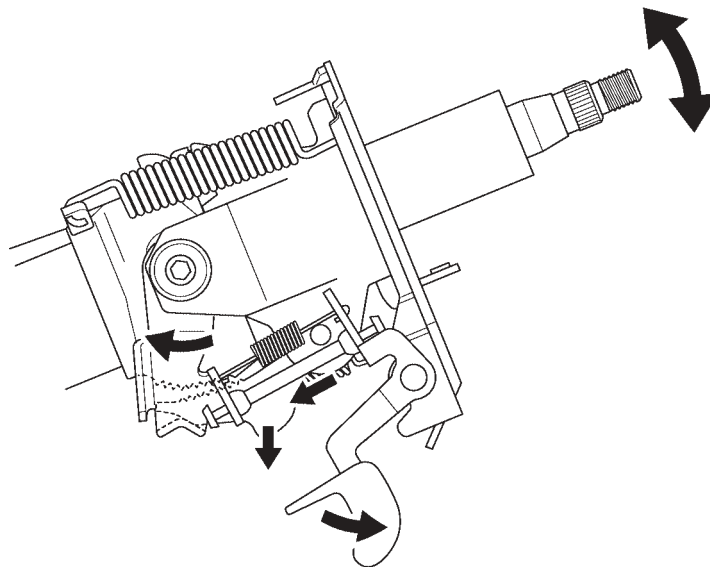

156CH03