

INSTALLATION

1. w/o VGRS:

INSTALL NO.2 HOLE COVER, HOSE CLAMP AND HOLE COVER TO COLUMN ASSEMBLY

Temporarily tighten the hose clamp.

2. INSTALL SLIDING YOKE

- Check that the front wheels are facing straight ahead.
- Install the thrust stopper.
- Temporarily tighten the bolt.

3. INSTALL STEERING COLUMN ASSEMBLY

- Torque the 4 column assembly set nuts.
Torque: 24.5 N·m (250 kgf·cm, 18 ft·lbf)
- Connect the connector.

4. INSTALL LOWER DUST COVER

Install the clamp.

5. INSTALL NO.2 INTERMEDIATE SHAFT ASSEMBLY

Temporarily tighten the bolt.

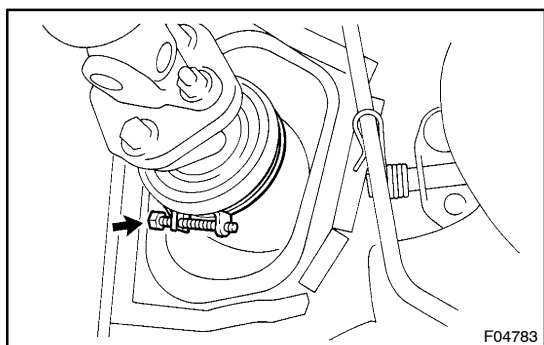

6. w/o VGRS:

CONNECT HOLE COVER

- Torque the 4 bolts.
Torque: 13 N·m (130 kgf·cm, 9 ft·lbf)
- Tighten the hose clamp.

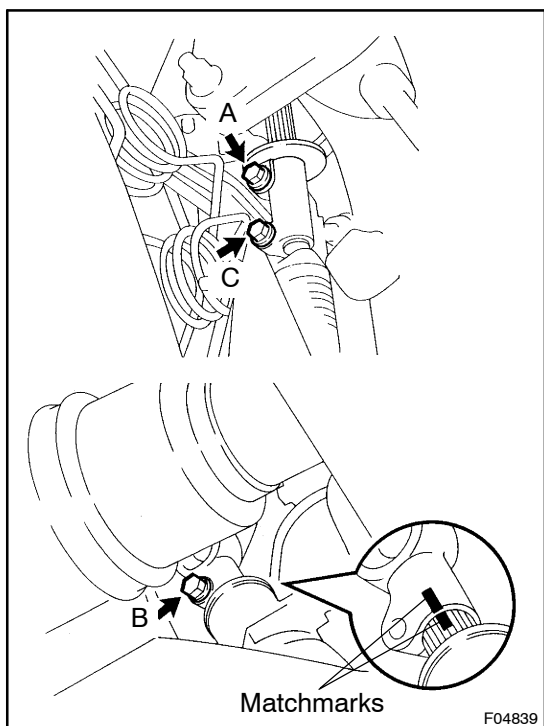

7. CONNECT NO.2 INTERMEDIATE SHAFT ASSEMBLY

- Align the matchmarks on the intermediate shaft and control valve shaft.
- Torque the bolt C.
Torque: 34 N·m (350 kgf·cm, 25 ft·lbf)
- Torque the bolt B.
Torque: 34 N·m (350 kgf·cm, 25 ft·lbf)
- Torque the bolt A.
Torque: 34 N·m (350 kgf·cm, 25 ft·lbf)

8. INSTALL NO.2 HEATER TO REGISTER DUCT

Tighten the screw.

9. INSTALL LOWER NO. 1 PANEL

- Connect the connector.
- Tighten the pad set screw.
- Connect the fuel lid release lever with the 2 screws.
- Connect the hood lock release lever with the 2 screws.

10. INSTALL CLUSTER FINISH PANEL

Connect the connector.

11. INSTALL COWL TRIM

Install the clip.

12. INSTALL SCUFF PLATE**13. INSTALL SPIRAL CABLE****14. INSTALL COMBINATION SWITCH WITH SPIRAL CABLE**

- (a) Tighten the 3 screws.
- (b) Connect the airbag connector.
- (c) Connect the 3 connectors.
- (d) w/ Power tilt and power telescopic steering column:
Connect the 5 connectors.

15. INSTALL COLUMN UPPER AND LOWER COVERS

Tighten the 3 screws to the lower cover.

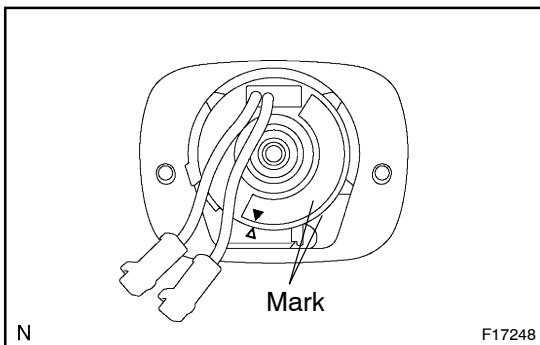
**16. CENTER SPIRAL CABLE**

- (a) Check that the front wheels are facing straight ahead.
- (b) Turn the cable counterclockwise by hand until it becomes harder to turn.
- (c) Then rotate the cable clockwise about 2.5 turns to align the marks.

HINT:

The cable will rotate about 2.5 turns to either left or right of the center.

17. INSTALL STEERING WHEEL

- (a) Align the matchmarks on the wheel and main shaft.
- (b) Torque the wheel set nut.
Torque: 34 N·m (350 kgf·cm, 25 ft·lbf)
- (c) w/ Airbag:
Connect the connector.

18. INSTALL STEERING WHEEL PAD**NOTICE:**

- Make sure the wheel pad is installed to the specified torque.
- If the wheel pad has been dropped, or there are cracks, dents or other defects in the case or connector, replace the wheel pad with a new one.
- When installing the wheel pad, take care that the wirings do not interfere with other parts and are not pinched between other parts.

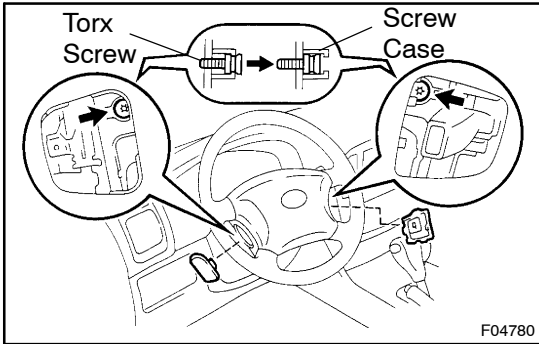

- (a) Connect the connector.
- (b) Connect the airbag connector.
- (c) Install the pad after confirming that the circumference groove of the torx screw is caught on the screw case.
- (d) Using a torx socket wrench, torque the 2 screws.

Torque: 8.8 N·m (90 kgf·cm, 78 in·lbf)

- (e) Install the steering wheel lower No.2 and No.3 covers.

19. CHECK AND ADJUST STEERING WHEEL CENTER POINT (See page DI-91)

20. PERFORM STEERING CENTER POINT CALIBRATION (See page DI-91)