

FUEL PUMP FUEL PUMP REMOVAL

EG0UU-01

EG

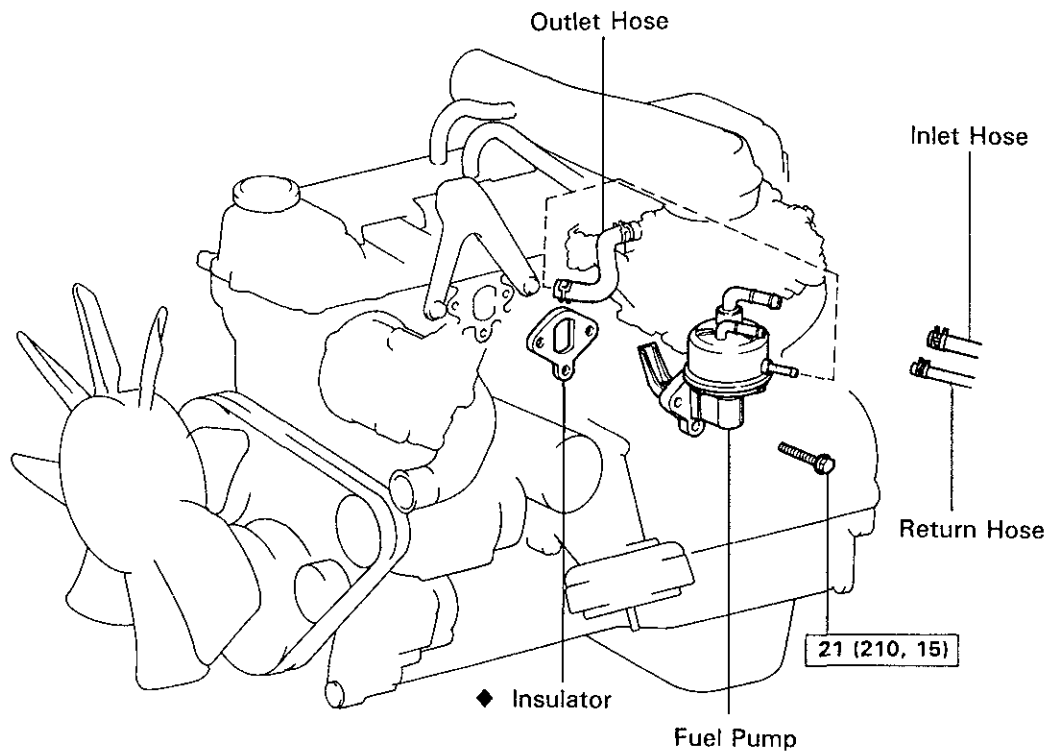

N·m (kgf·cm, ft·lbf) : Specified torque

◆ Non-reusable part

P05421

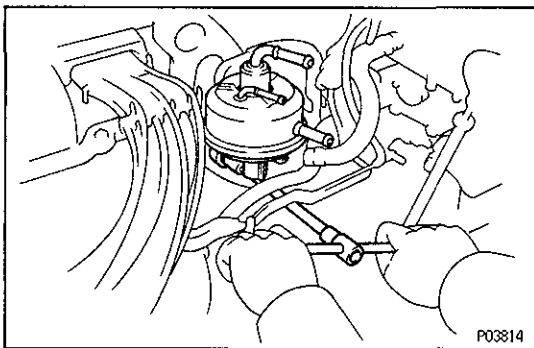

P03814

1. **DISCONNECT FUEL HOSES FROM FUEL PUMP**
2. **REMOVE FUEL PUMP**

Remove the three bolts, fuel pump and insulator.

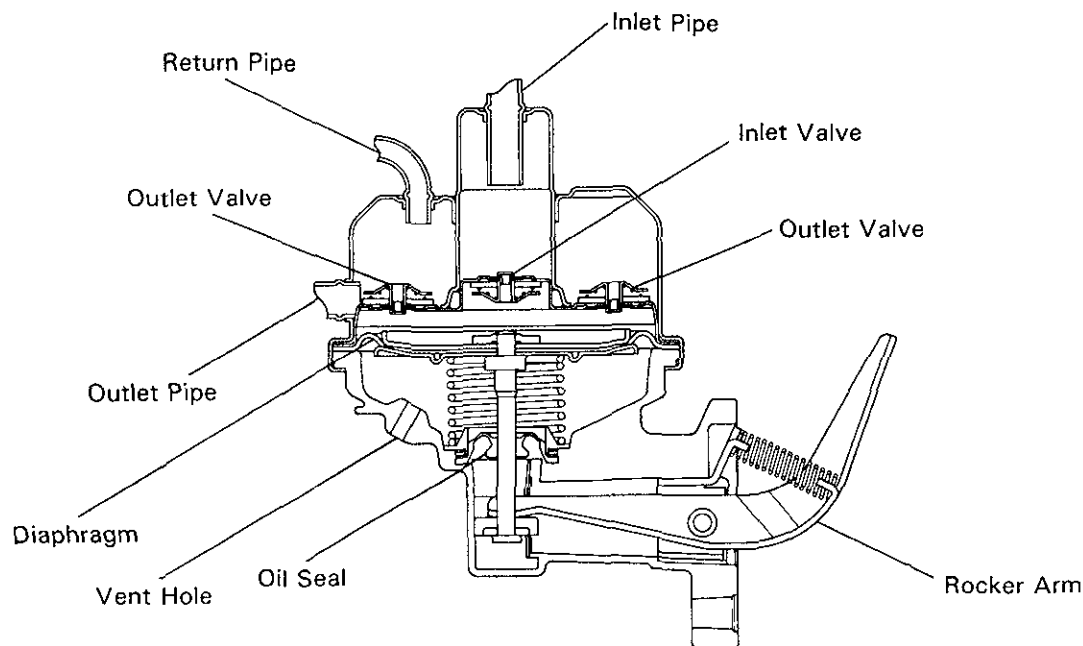
FUEL PUMP INSPECTION (Airtight Test)**CUTAWAY VIEW**

P04972

PRECHECKS

Before performing the following checks on the fuel pump:

- (a) Run some fuel through the pump to insure that the check valves seal tightly (a dry check valve may not seal properly).
- (b) Without blocking off any pipes, operate the rocker arm and check the amount of force necessary for operation and the amount of arm play. This same amount of force should be used in the checks.

1. CHECK INLET VALVE

Block off the outlet and return pipes with your finger and check that there is an increase in rocker arm play and that the rocker arm moves freely (no reaction force).

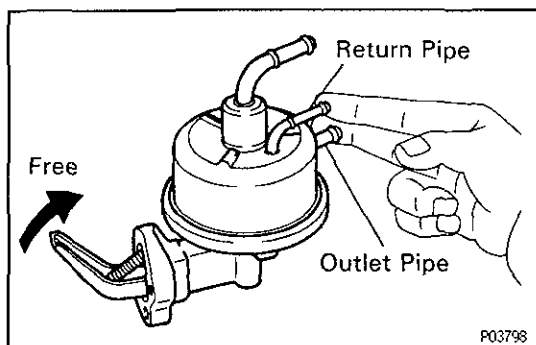

P03798

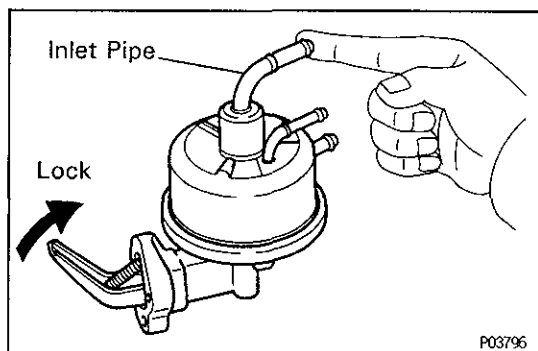
**2. CHECK OUTLET VALVE**

Block off the inlet pipe with your finger and check that the rocker arm locks (does not operate with same amount of force used in the precheck above).

HINT: Never use more force than that used in the precheck. This applies to checks 3 and 4 also.

EG

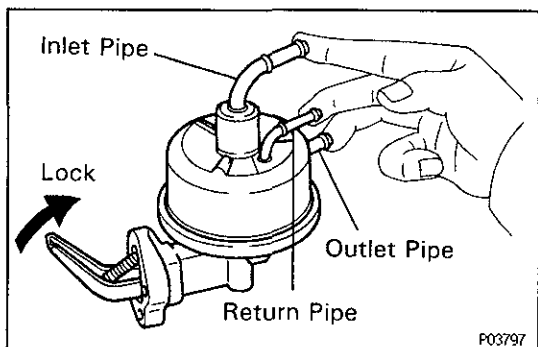
**3. CHECK DIAPHRAGM**

Block off the inlet, outlet and return pipes and check that the rocker arm locks.

HINT: If all three of these checks are not as specified, the caulking (sealing) of the body and upper casing is defective.

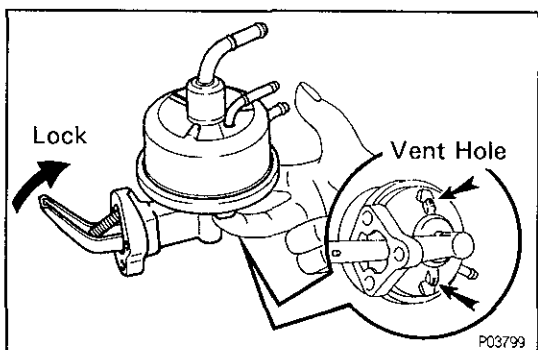
**4. CHECK OIL SEAL**

Block off the vent hole with your finger and check that the rocker arm locks.

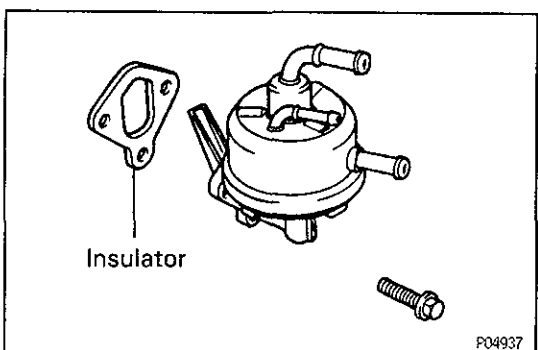
**FUEL PUMP INSTALLATION**

EG0UW-01

1. INSTALL FUEL PUMP

Install a new insulator and fuel pump with the three bolts.

Torque: 21 N·m (210 kgf·cm, 15 ft·lbf)

2. CONNECT FUEL HOSES TO FUEL PUMP**3. START ENGINE AND CHECK FOR LEAKS**