

## AIR MIX SERVOMOTOR (Front A/C for LHD)

### INSPECTION

AC1TO-01

#### 1. REMOVE AIR MIX SERVOMOTOR

- Disconnect the connector.
- Remove the 2 screws and servomotor.

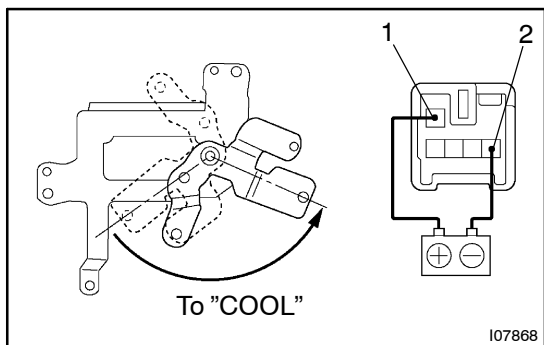

#### 2. Manual A/C:

##### INSPECT AIR MIX SERVOMOTOR

- Inspect servomotor operation.
  - Connect the positive (+) lead from the battery to terminal 1 and negative (–) lead to terminal 2, then check that the arm turns to "COOL" side smoothly.

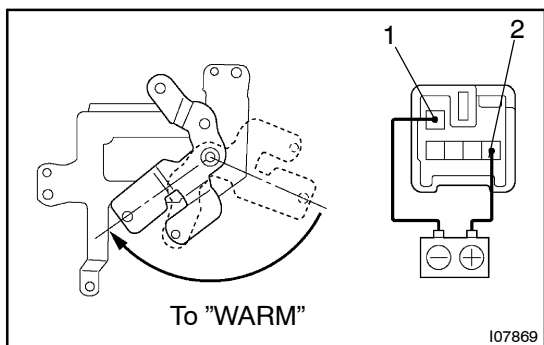

- Connect the positive (+) lead from the battery to terminal 2 and negative (–) lead to terminal 1, then check that the arm turns to "WARM" side smoothly.

If operations are not as specified, replace the servomotor.

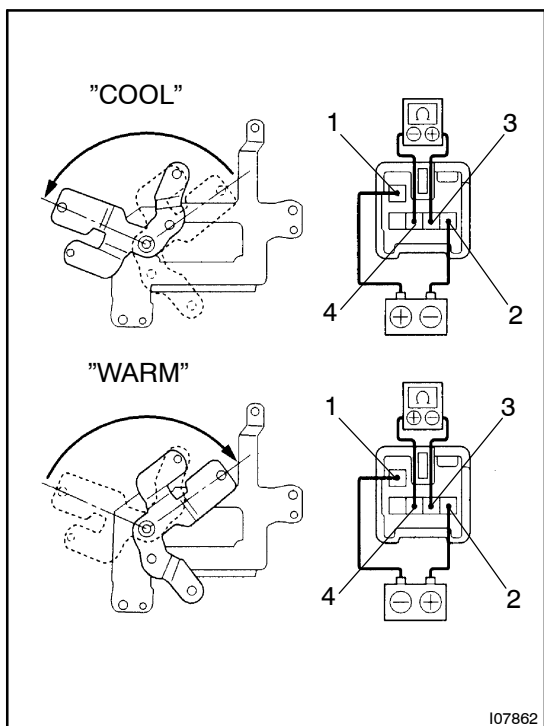

- Inspect position sensor resistance.  
Measure resistance between terminals at servomotor arm each position as shown in the chart.

Tester connection	Condition	Specified condition
4 – 5	Constant	4.2 – 7.8 k $\Omega$
3 – 4	Arm position at "COOL"	0.76 – 1.4 k $\Omega$
3 – 4	Arm position at "WARM"	3.4 – 6.4 k $\Omega$

If resistance is not as specified, replace the servomotor.

#### 3. INSTALL SERVOMOTOR

- Install the servomotor with the 2 screws.
- Connect the connector.