

REAR HEATER HI RELAY (Manual A/C)

INSPECTION

AC1U0-01

1. REMOVE THESE PARTS:

- (a) Front seats
- (b) Rear heater control assembly
(See page AC-198)
- (c) Rear console box
- (d) Front console box cover
- (e) Lower center cluster finish panel
- (f) Front door scuff plate
- (g) Cowl side trims
- (h) Rear door scuff plates
- (i) Center pillar garnishes

2. SLIDE FLOOR CARPET BACKWARD

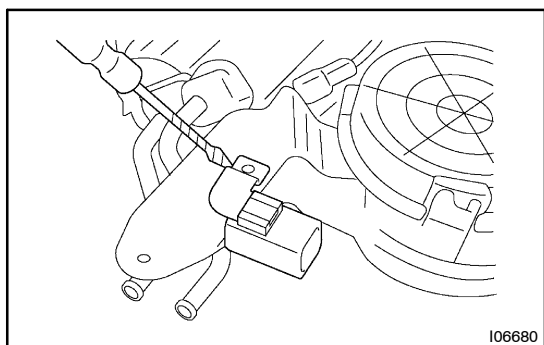

I06680

3. REMOVE REAR HEATER RELAY

- (a) Disconnect the connector.
- (b) Using a screwdriver, release the claw and remove the relay.

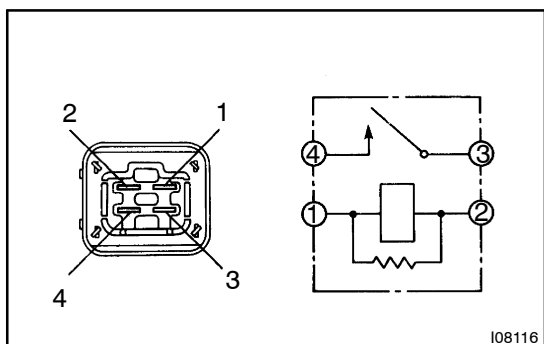

I08116

4. INSPECT REAR HEATER RELAY CONTINUITY

Condition	Tester connection	Specified condition
Constant	1 – 3	Continuity
Apply B+ between terminals 1 and 3.	2 – 4	Continuity

If continuity is not as specified, replace the relay.

5. INSTALL RELAY