

## REAR A/C CONTROL ASSEMBLY (Manual A/C) INSPECTION

AC1UM-01

### 1. REMOVE REAR COOLER CONTROL ASSEMBLY

Using a screwdriver, release the 4 claws and pull out the cooler control assembly, then disconnect the connector.

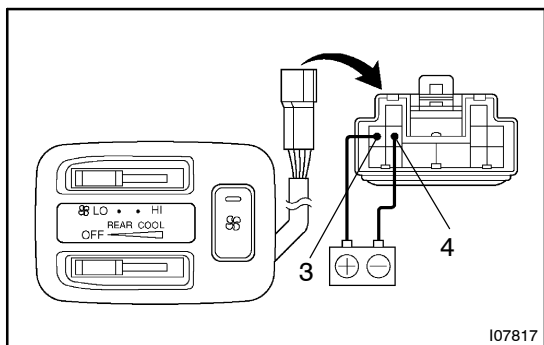

### 2. INSPECT ILLUMINATION OPERATION

Connect the positive (+) lead from the battery to terminal 3 and negative ( - ) lead to terminal 4 then check that the illumination light up.

If operation is not as specified, replace the rear A/C control assembly.

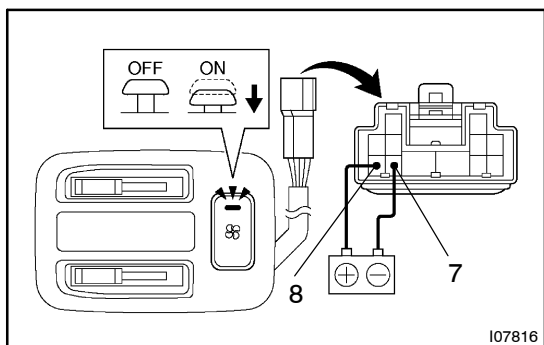

### 3. INSPECT COOLER CONTROL SWITCH INDICATOR

- Connect the positive (+) lead from the battery to terminal 7 and negative ( - ) lead to terminal 8.
- Push the button in and check that the A/C indicator lights up.

If operation is not as specified, replace the rear A/C control assembly.

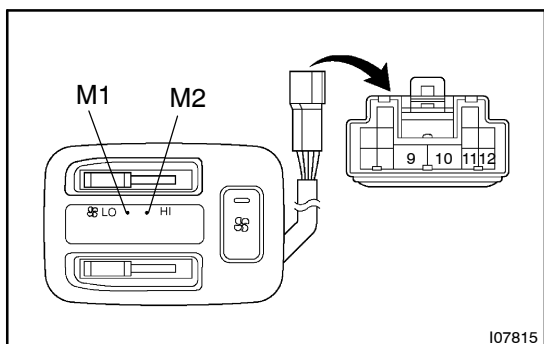

### 4. INSPECT BLOWER SWITCH OPERATION

Check the continuity between terminals while move the switch knob to each position as shown in the chart.

Switch position	Tester connection	Specified condition
LO	-	No continuity
M1	9 - 12	Continuity
M2	9 - 11	Continuity
HI	9 - 10	Continuity

If continuity is not as specified, replace the rear A/C control assembly.

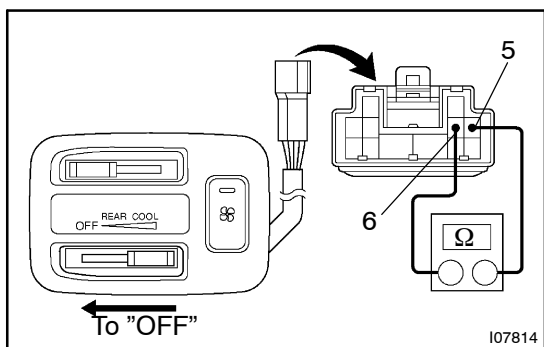

### 5. INSPECT VARIABLE RESISTOR

Gradually move the temperature control lever from "COOL" side to OFF side then check that the resistance between terminals 5 and 6 increase from 0 to 3.0 k  $\Omega$ .

If operation is not as specified, replace the rear A/C control assembly.