

## SPEEDOMETER DRIVEN GEAR ON-VEHICLE REPAIR

AT08S-01

### 1. DISCONNECT NO.1 SPEED SENSOR

- (a) Loosen the serrated collar with pliers.
- (b) Disconnect the No.1 speed sensor.

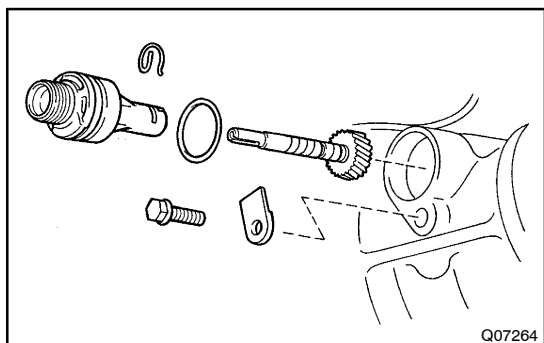

### 2. REMOVE SPEEDOMETER DRIVEN GEAR ASSEMBLY

- (a) Remove the bolt and lock plate.
- (b) Pry the speedometer driven gear assembly.

### 3. DISASSEMBLE SPEEDOMETER DRIVEN GEAR ASSEMBLY

- (a) Remove the O-ring from the speedometer driven gear assembly.
- (b) Remove the clip and speedometer driven gear from the speedometer driven gear sleeve.

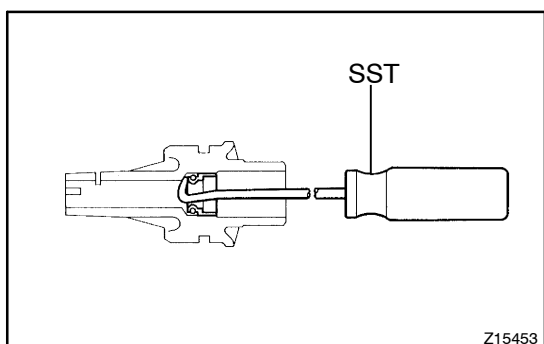

### 4. REMOVE SPEEDOMETER DRIVEN GEAR OIL SEAL

Using SST, remove the oil seal.

SST 09921-00010

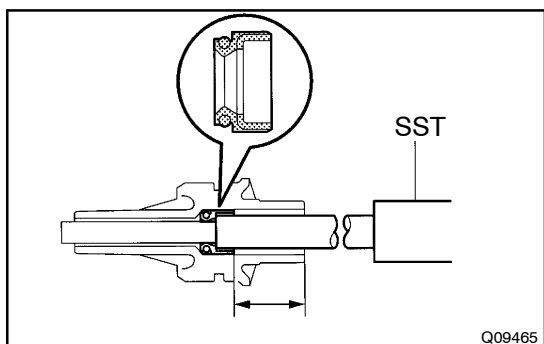

### 5. INSTALL SPEEDOMETER DRIVEN GEAR OIL SEAL

Using SST, install a new oil seal.

SST 09201-10000 (09201-01060)

Drive in depth: 25 mm (0.98 in.)

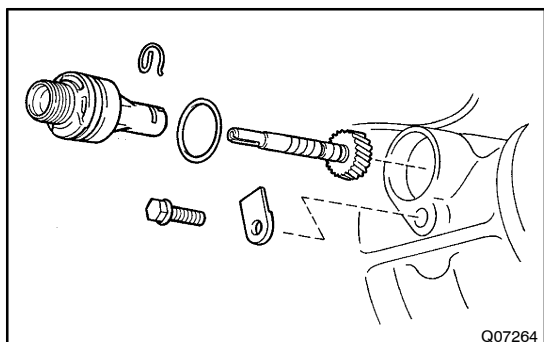

### 6. ASSEMBLE SPEEDOMETER DRIVEN GEAR ASSEMBLY

- (a) Install the speedometer driven gear and clip to the speedometer driven gear sleeve.
- (b) Coat a new O-ring with ATF.
- (c) Install the O-ring to the speedometer driven gear assembly.

**7. INSTALL SPEEDOMETER DRIVEN GEAR ASSEMBLY**

- (a) Install the speedometer driven gear assembly.
- (b) Install the lock plate with the bolt.

**Torque: 16 N·m (160 kgf·cm, 12 ft·lbf)**

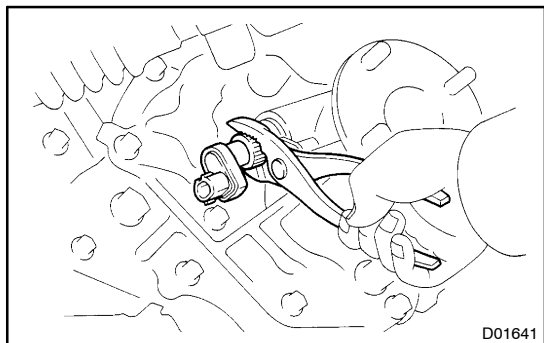
**8. CONNECT NO.1 SPEED SENSOR**

- (a) Connect the No.1 speed sensor.
- (b) Tighten the serrated collar with pliers.