

INSPECTION

1. LHD Models : INSPECT TURN SIGNAL SWITCH CONTINUITY

Switch position	Tester connection	Specified condition
Left turn	2 – 1	Continuity
Neutral	–	No continuity
Right turn	3 – 2	Continuity

If continuity is not as specified, replace the switch.

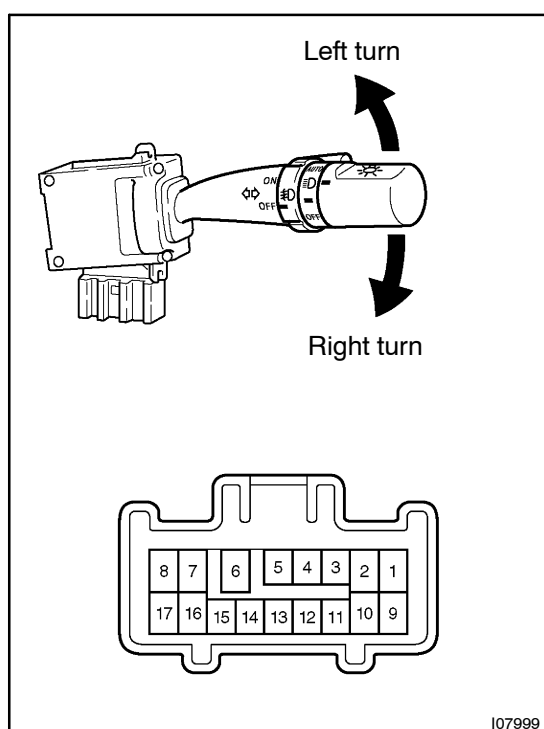

2. RHD Models : INSPECT TURN SIGNAL SWITCH CONTINUITY

Switch position	Tester connection	Specified condition
Left turn	6 – 7	Continuity
Neutral	–	No continuity
Right turn	7 – 8	Continuity

If continuity is not as specified, replace the switch.

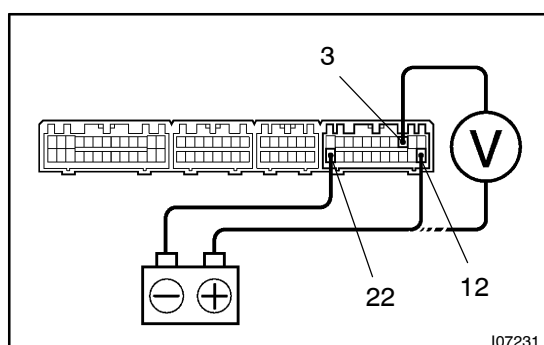

3. INSPECT HAZARD WARNING SWITCH OPERATION

- Connect the positive (+) lead from the battery to terminal 12 and 3 of panel switch connector and negative (-) lead to terminal 22.
- Push the hazard warning switch and check that the voltage is battery positive voltage.

If operation is not as specified, see AC section.

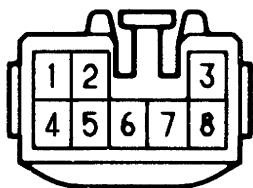
Wire Harness Side

I04046

4. INSPECT TURN SIGNAL FLASHER CIRCUIT

Disconnect the connector from the combination switch and inspect the connector on the wire harness side, as shown.

Tester connection	Condition	Specified condition
2 – Ground	Constant	Continuity
3 – Ground	Constant	Continuity
5 – Ground	Turn signal switch RIGHT or OFF	No continuity
5 – Ground	Turn signal switch LEFT	Continuity
6 – Ground	Turn signal switch LEFT or OFF	No continuity
6 – Ground	Turn signal switch RIGHT	Continuity
7 – Ground	Constant	Continuity
8 – Ground	Hazard warning switch OFF	No continuity
8 – Ground	Hazard warning switch ON	Continuity
1 – Ground	Ignition switch LOCK or ACC	No voltage
1 – Ground	Ignition switch ON	Battery voltage
4 – Ground	Constant	Battery voltage

If circuit is as specified, replace the relay.

If circuit is not as specified, inspect the circuits connected to other parts.