

INSPECTION

1. INSPECT HEADLIGHT CLEANER SWITCH CONTINUITY

Switch position	Tester connection	Specified condition
OFF	–	No continuity
ON	3 – 15	Continuity

If continuity is not as specified, replace the switch.

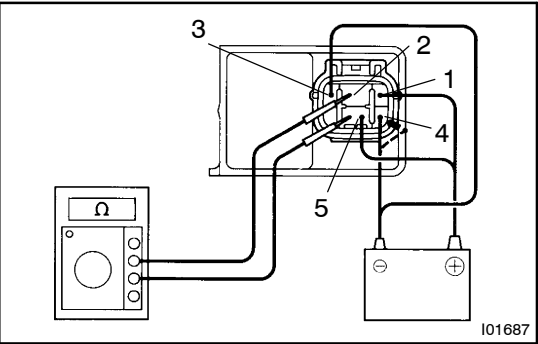

2. INSPECT HEADLIGHT CLEANER RELAY OPERATION

- (a) Check that no continuity exists between terminals 2 and 5.
- (b) Connect the positive (+) lead from the battery to terminals 1 and 5, and the negative (–) lead to terminal 3.
- (c) Connect the negative (–) lead from the battery to terminal 4, and check that continuity exists between terminals 2 and 5 for 0.9 – 1.1 seconds, then no continuity exists.

If operation is not as specified, replace the motor.

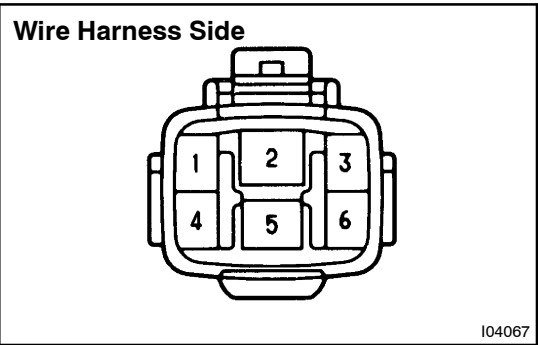

3. INSPECT HEADLIGHT CLEANER RELAY CIRCUIT

Disconnect the connector from the relay and inspect the connector on wire harness side, as shown.

Tester connection	Condition	Specified condition
2 – Ground 3 – Ground	Constant	Continuity
1 – Ground	Ignition switch OFF or ACC	No voltage
1 – Ground	Ignition switch ON	Battery voltage
5 – Ground	Constant	Battery voltage

If circuit is not as specified, inspect the circuits connected to other parts.

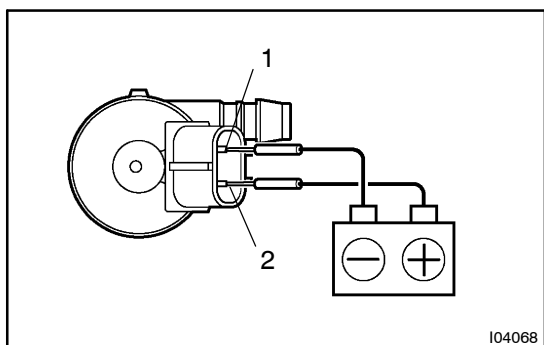

4. INSPECT HEADLIGHT CLEANER MOTOR OPERATION

Connect the positive (+) lead from the battery to terminal 2 and the negative (-) lead to terminal 1, check that the motor operates.

NOTICE:

These tests must be performed quickly (within 20 seconds) to prevent the coil from burning out.

If operation is not as specified, replace the motor.