

INSPECTION

1. LHD Models :

INSPECT FRONT WIPER AND WASHER SWITCH CONTINUITY

| Switch position | Tester connection | Specified condition |
|-----------------|-------------------|---------------------|
| OFF | 7 – 16 | Continuity |
| INT | 7 – 16 | Continuity |
| LO | 7 – 17 | Continuity |
| HI | 8 – 17 | Continuity |
| Washer OFF | – | No continuity |
| Washer ON | 2 – 11 | Continuity |

If continuity is not as specified, replace the switch.

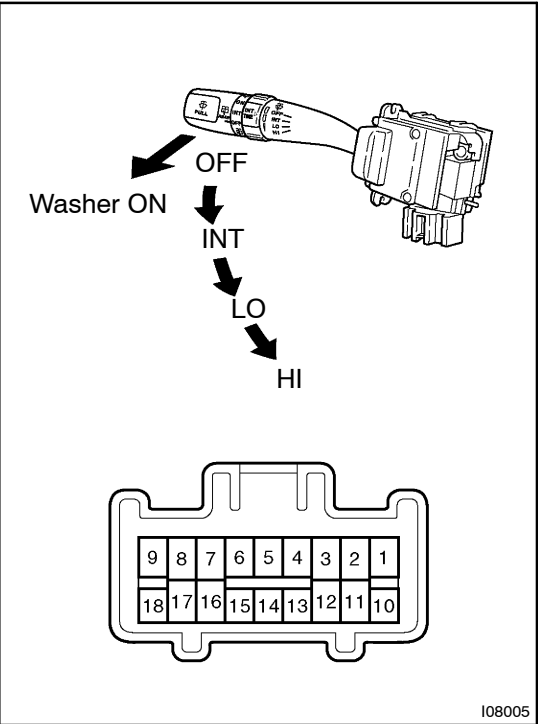

2. RHD Models :

INSPECT FRONT WIPER AND WASHER SWITCH CONTINUITY

| Switch position | Tester connection | Specified condition |
|-----------------|-------------------|---------------------|
| OFF | 3 – 12 | Continuity |
| INT | 3 – 12 | Continuity |
| LO | 3 – 11 | Continuity |
| HI | 2 – 11 | Continuity |
| Washer OFF | – | No continuity |
| Washer ON | 8 – 17 | Continuity |

If continuity is not as specified, replace the switch.

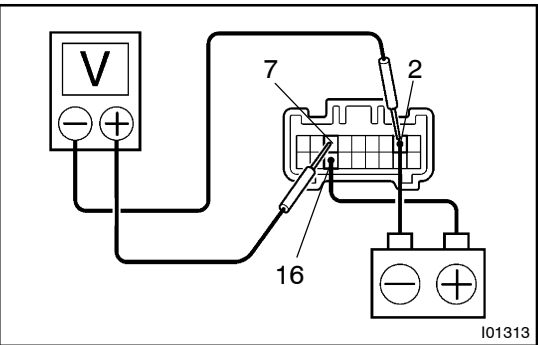

3. LHD Models :

INSPECT FRONT WIPER INTERMITTENT OPERATION

- Turn the wiper switch to INT position.
- Turn the intermittent time control switch to FAST position.
- Connect the positive (+) lead from the battery to terminal 16 and the negative (–) lead to terminal 2.
- Connect the positive (+) lead from the voltmeter to terminal 7 and the negative (–) lead to terminal 2, check that the meter needle indicates battery voltage.

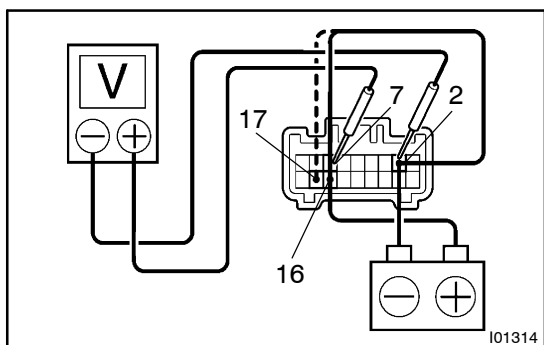

- (e) After connecting terminal 2 to terminal 16, connect to terminal 2 to terminal 17, check the voltage rises from 0 volts to battery voltage within the times, as shown in the table.

| INT time control switch position | Voltage |
|----------------------------------|----------------------|
| FAST | 0.6 – 2.6 sec. |
| SLOW | 5.7 – 15.7 secs. |

If operation is not as specified, replace the wiper and washer switch.

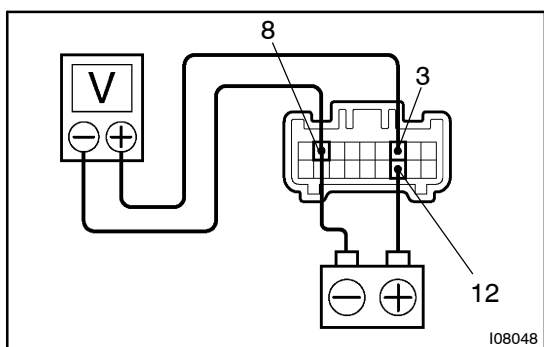

4. RHD Models : INSPECT FRONT WIPER INTERMITTENT OPERATION

- Turn the wiper switch to INT position.
- Turn the intermittent time control switch to FAST position.
- Connect the positive (+) lead from the battery to terminal 12 and the negative (–) lead to terminal 8.
- Connect the positive (+) lead from the voltmeter to terminal 3 and the negative (–) lead to terminal 8, check that the meter needle indicates battery voltage.
- After connecting terminal 8 to terminal 12, connect to terminal 8 to terminal 11, check the voltage rises from 0 volts to battery voltage within the times, as shown in the table.

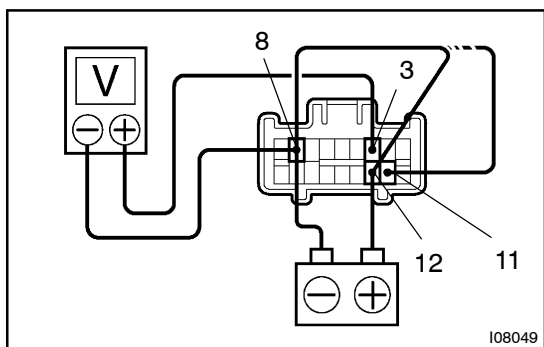

| INT time control switch position | Voltage |
|----------------------------------|----------------------|
| FAST | 0.6 – 2.6 sec. |
| SLOW | 5.7 – 15.7 secs. |

If operation is not as specified, replace the wiper and washer switch.

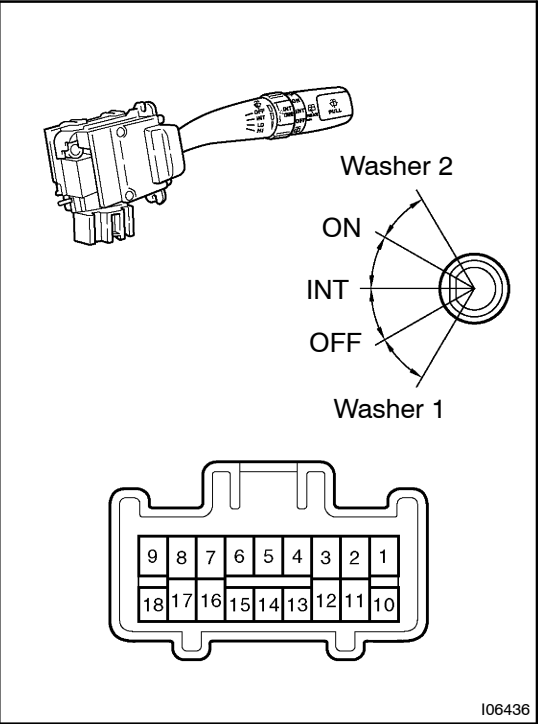

**5. LHD Models :
INSPECT REAR WIPER AND WASHER SWITCH CONTINUITY**

| Switch position | Tester connection | Specified condition |
|-----------------|-------------------|---------------------|
| Washer 1 | 2 – 12 | Continuity |
| OFF | – | No Continuity |
| INT | 2 – 13 | Continuity |
| ON | 2 – 10 | Continuity |
| Washer 2 | 2 – 10 – 12 | Continuity |

If continuity is not as specified, replace the switch.

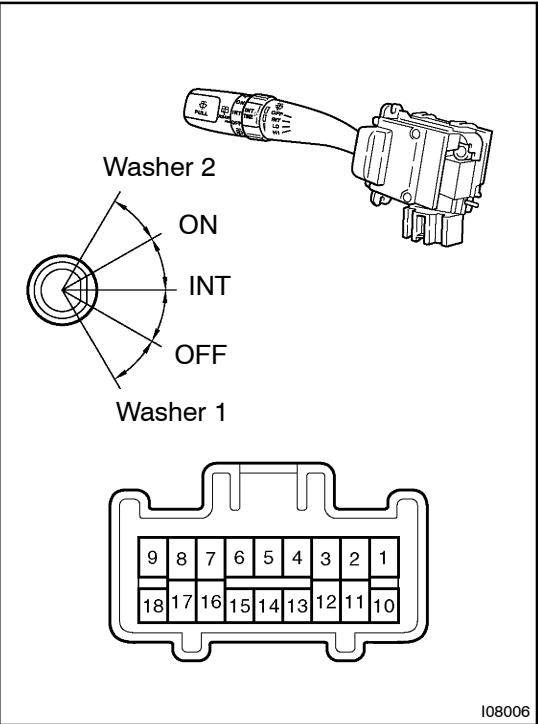

**6. RHD Models :
INSPECT REAR WIPER AND WASHER SWITCH CONTINUITY**

| Switch position | Tester connection | Specified condition |
|-----------------|-------------------|---------------------|
| Washer 1 | 8 – 16 | Continuity |
| OFF | – | No Continuity |
| INT | 8 – 15 | Continuity |
| ON | 8 – 18 | Continuity |
| Washer 2 | 8 – 16 – 18 | Continuity |

If continuity is not as specified, replace the switch.

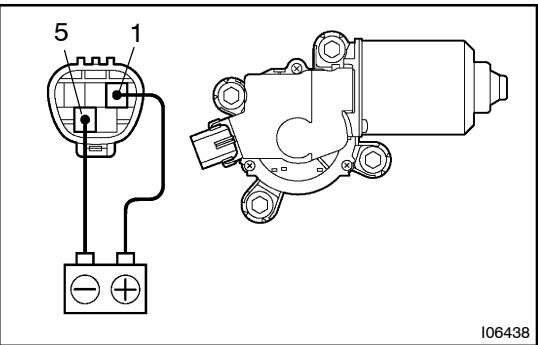

**7. LHD Models :
INSPECT FRONT WIPER MOTOR OPERATION
Low Speed:**

Connect the positive (+) lead from the battery to terminal 1 and the negative (-) lead to terminal 5, check that the motor operates at low speed.

If operation is not as specified, replace the motor.

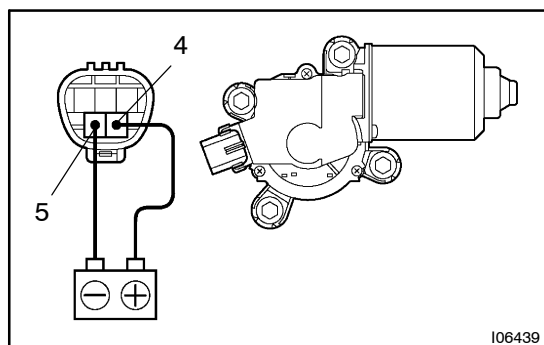

8. LHD Models :
INSPECT FRONT WIPER MOTOR OPERATION
High Speed:

Connect the positive (+) lead from the battery to terminal 4 and the negative (-) lead to terminal 5, check that the motor operates at high speed.

If operation is not as specified, replace the motor.

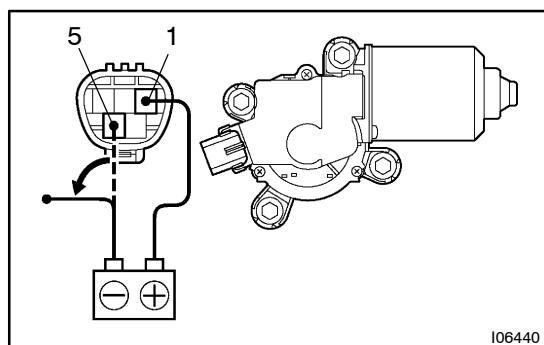

9. LHD Models :
INSPECT FRONT WIPER MOTOR OPERATION
Stopping at Stop Position:

- (a) Operate the motor at low speed and stop the motor operation anywhere except at the stop position by disconnecting positive (+) lead from terminal 1.

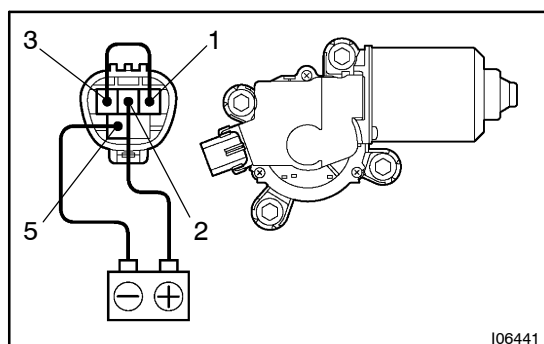

- (b) Connect terminals 1 and 3.

- (c) Connect the positive (+) lead from the battery to terminal 2 and negative (-) lead to terminal 5, check that the motor stops running at the stop position after the motor operates again.

If operation is not as specified, replace the motor.

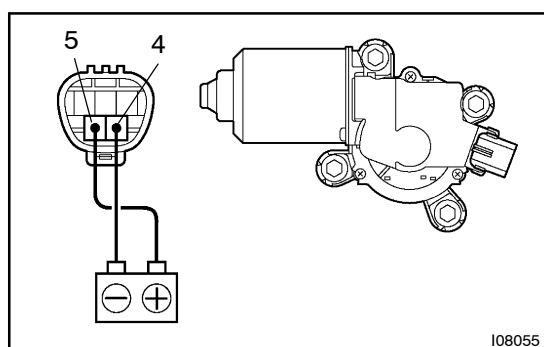

10. RHD Models :
INSPECT FRONT WIPER MOTOR OPERATION
Low Speed:

Connect the positive (+) lead from the battery to terminal 5 and the negative (-) lead to terminal 4, check that the motor operates at low speed.

If operation is not as specified, replace the motor.

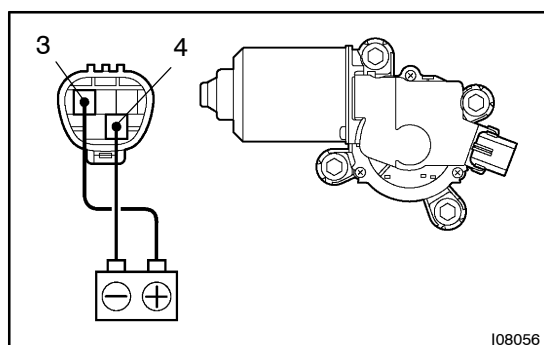

11. RHD Models :
INSPECT FRONT WIPER MOTOR OPERATION
High Speed:

Connect the positive (+) lead from the battery to terminal 3 and the negative (-) lead to terminal 4, check that the motor operates at high speed.

If operation is not as specified, replace the motor.

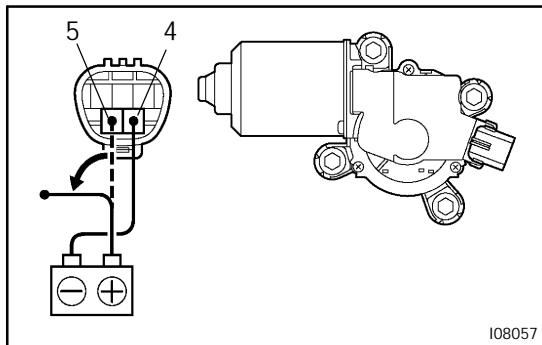
**12. RHD Models :****INSPECT FRONT WIPER MOTOR OPERATION****Stopping at Stop Position:**

- (a) Operate the motor at low speed and stop the motor operation anywhere except at the stop position by disconnecting positive (+) lead from terminal 5.

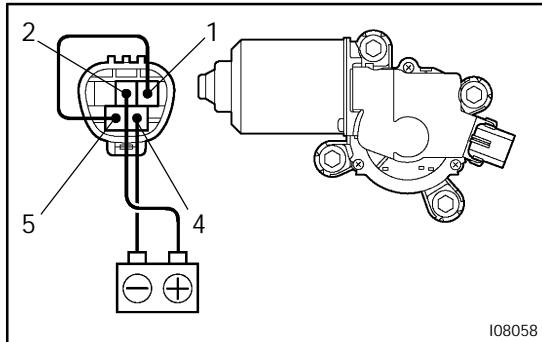

- (b) Connect terminals 1 and 5.

- (c) Connect the positive (+) lead from the battery to terminal 2 and negative (-) lead to terminal 4, check that the motor stops running at the stop position after the motor operates again.

If operation is not as specified, replace the motor.

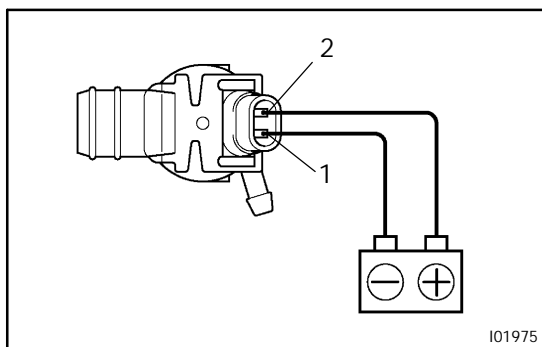
**13. INSPECT FRONT WASHER MOTOR OPERATION**

Connect the positive (+) lead from the battery to terminal 2 and the negative (-) lead to terminal 1, check that the motor operates.

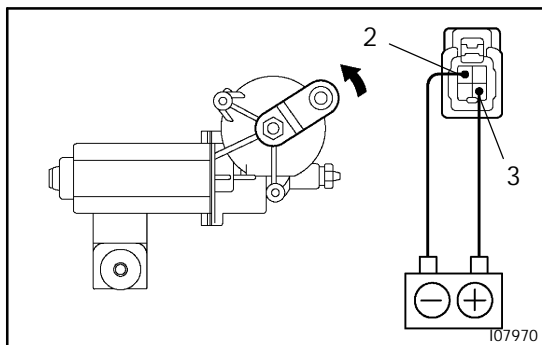
**14. INSPECT REAR WIPER MOTOR OPERATION****Low Speed:**

Connect the positive (+) lead from the battery to terminal 3 and negative (-) lead to terminal 2, check that the motor operates at low speed.

If operation is not as specified, replace the motor.

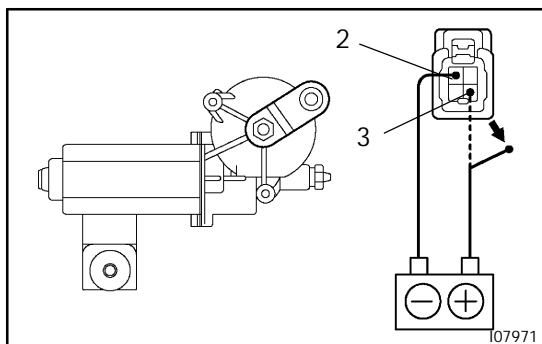
**15. INSPECT REAR WIPER MOTOR OPERATION****Stopping at Stop Position:**

- (a) Operate the motor at low speed and stop the motor operation anywhere except at the stop position by disconnecting positive (+) lead from terminal 3.

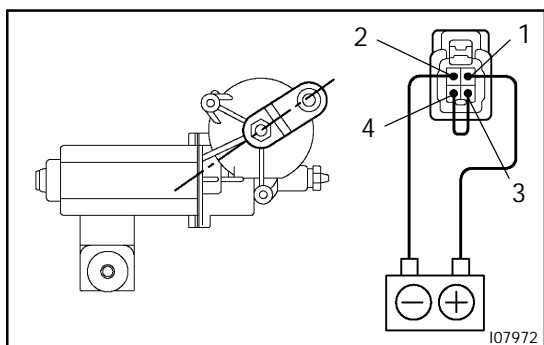

- (b) Connect terminals 3 and 4.
- (c) Connect the positive (+) lead from the battery to terminal 1 and negative (-) lead to terminal 2, check that the motor stops running at the stop position after the motor operates again.

If operation is not as specified, replace the motor.

NOTICE:

These tests must be performed quickly (within 20 seconds) to prevent the coil from burning out.

If operation is not as specified, replace the motor.

16. Swing Out Type RH :

INSPECT REAR WIPER MOTOR OPERATION

Low Speed:

Connect the positive (+) lead from the battery to terminal 3 and negative (-) lead to terminal 2, check that the motor operates at low speed.

If operation is not as specified, replace the motor.

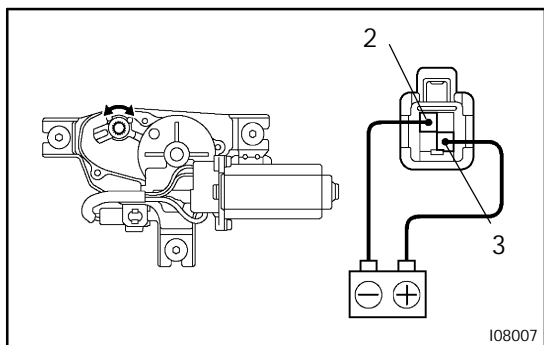

17. INSPECT REAR WIPER MOTOR OPERATION

Stopping at Stop Position:

- (a) Operate the motor at low speed and stop the motor operation anywhere except at the stop position by disconnecting positive (+) lead from terminal 3.

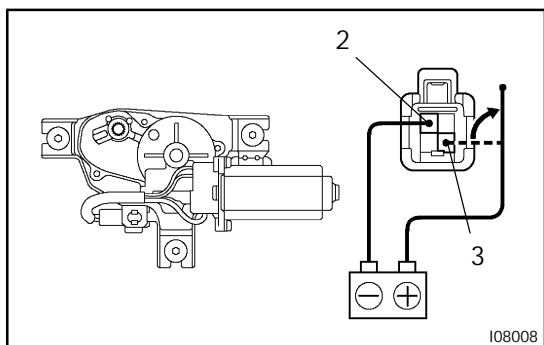

- (b) Connect terminals 3 and 4.
- (c) Connect the positive (+) lead from the battery to terminal 1 and negative (-) lead to terminal 2, check that the motor stops running at the stop position after the motor operates again.

If operation is not as specified, replace the motor.

NOTICE:

These tests must be performed quickly (within 20 seconds) to prevent the coil from burning out.

If operation is not as specified, replace the motor.

18. Swing Out Type LH :

INSPECT REAR WIPER MOTOR OPERATION

Low Speed:

Connect the positive (+) lead from the battery to terminal 3 and negative (-) lead to terminal 2, check that the motor operates at low speed.

If operation is not as specified, replace the motor.

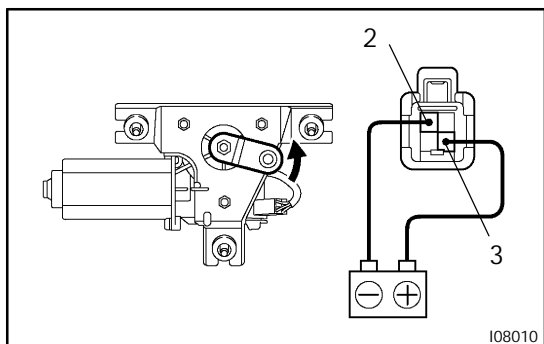

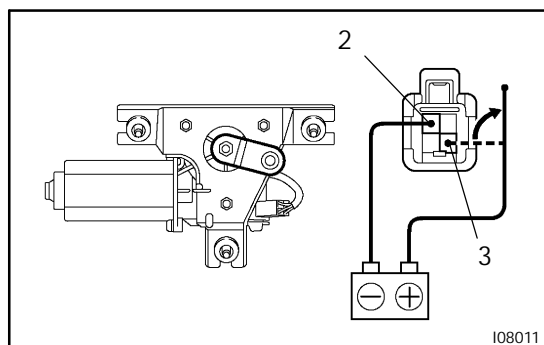
**19. INSPECT REAR WIPER MOTOR OPERATION****Stopping at Stop Position:**

- (a) Operate the motor at low speed and stop the motor operation anywhere except at the stop position by disconnecting positive (+) lead from terminal 3.

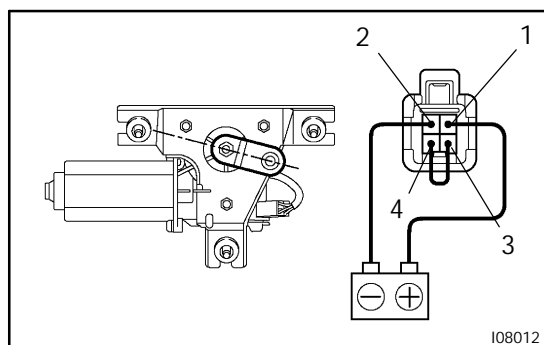

- (b) Connect terminals 3 and 4.
(c) Connect the positive (+) lead from the battery to terminal 1 and negative (-) lead to terminal 2, check that the motor stops running at the stop position after the motor operates again.

If operation is not as specified, replace the motor.

NOTICE:

These tests must be performed quickly (within 20 seconds) to prevent the coil from burning out.

If operation is not as specified, replace the motor.

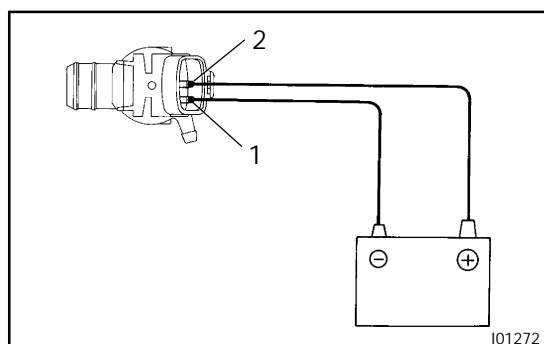
**20. INSPECT REAR WASHER MOTOR OPERATION**

Connect the positive (+) lead from the battery to terminal 2 and the negative (-) lead to terminal 1, check that the motor operates.

NOTICE:

These tests must be performed quickly (within 20 seconds) to prevent the coil from burning out.

If operation is not as specified, replace the motor.

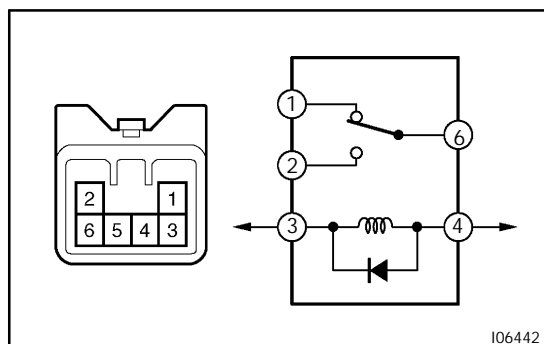
**21. INSPECT REAR WIPER RELAY CONTINUITY**

| Condition | Tester connection | Specified condition |
|-------------------------------------|-------------------|---------------------|
| Constant | 1 – 5 3 – 4 | Continuity |
| Apply B+ between terminals 3 and 4. | 2 – 5 | Continuity |

22. INSPECT REAR WIPER RELAY OPERATION (See page DI-767)**23. INSPECT REAR WIPER RELAY INTERMITTENT OPERATION (See page DI-767)**