

INSTALLATION

1. CLEAN AND SHAPE CONTACT SURFACE OF BODY

- (a) Using a knife, cut away any rough areas on the body.

HINT:

Leave as much of the adhesive on the body as possible.

- (b) Clean the cutting surface of the adhesive with a piece of shop rag saturated in cleaner.

HINT:

Even if all the adhesive has been removed, clean the body.

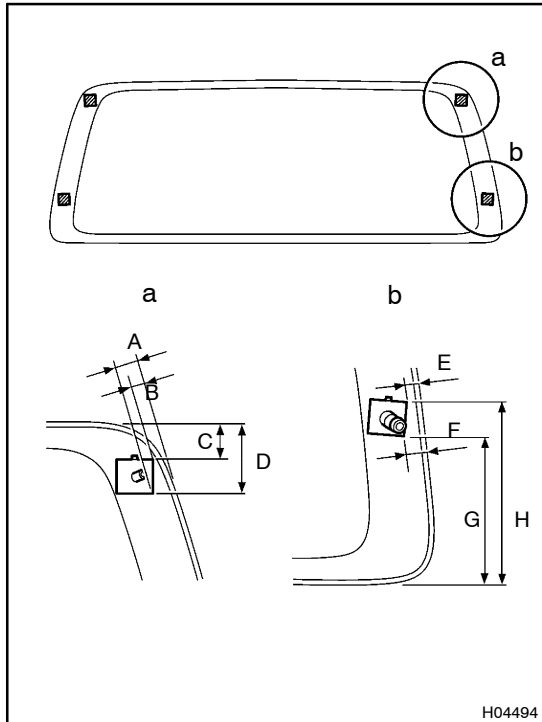

2. REPLACE CLIP AND SPACER

- (a) Remove the damaged clip and spacer.

- (b) Cut off the old adhesive around the clip and spacer installation area.

NOTICE:

Be careful not to damage the back door glass.

- (c) Clean the installation area.

- (d) Install a new clip and spacer onto the glass as shown in the illustration.

A: 24.3 mm (0.957 in.)

B: 18.6 mm (0.732 in.)

C: 33.1 mm (1.303 in.)

D: 52.8 mm (2.079 in.)

E: 14.4 mm (0.567 in.)

F: 18 mm (0.709 in.)

G: 156.6 mm (6.165 in.)

H: 176.8 mm (6.961 in.)

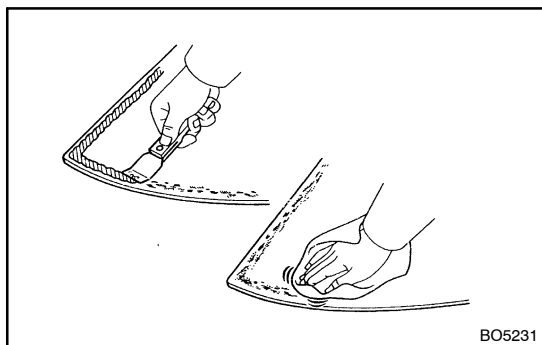

3. CLEAN REMOVED GLASS

- (a) Using a scraper, remove the adhesive sticking to the glass.

- (b) Clean the glass with cleaner.

NOTICE:

Do not touch the glass after cleaning it.

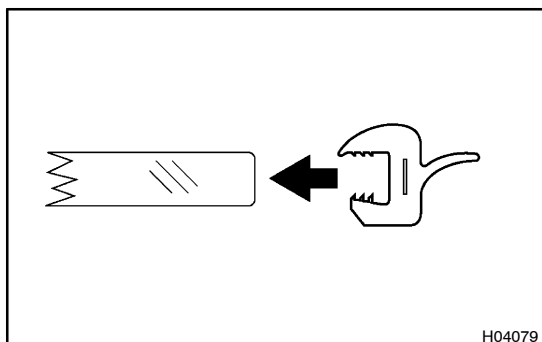

4. INSTALL BACK WINDOW OUTSIDE MOULDING

Install the back window moulding as shown in the illustration.

NOTICE:

Do not touch the glass face after cleaning it.

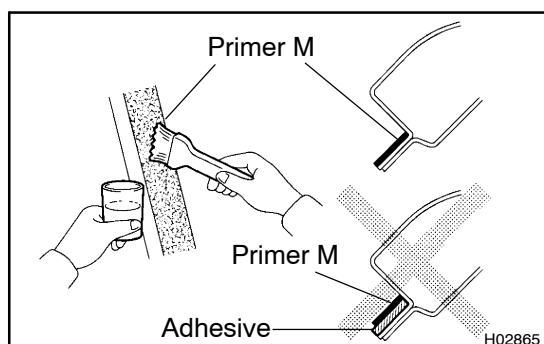

5. COAT CONTACT SURFACE OF BODY WITH PRIMER "M"

Using a brush, coat the contact surface on the body with Primer M.

NOTICE:

- Let the primer coating dry for 3 minutes or more.
- Do not coat primer M to the adhesive.
- Do not keep any of the opened primer M for later use.

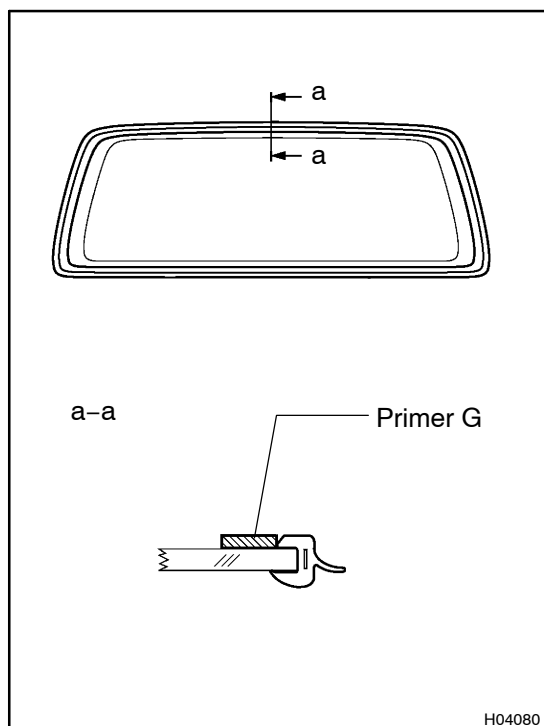

6. COAT CONTACT SURFACE OF GLASS WITH PRIMER "G"

- Using a brush or sponge, coat the edge of the glass and contact surface with Primer G.
- When the primers coated wrongly to the area other than the specified, wipe it off with a clean shop rag before the primer dries.

NOTICE:

- Let the primer coating dry for 3 minutes or more.
- Do not keep any of the opened primer G for later use.

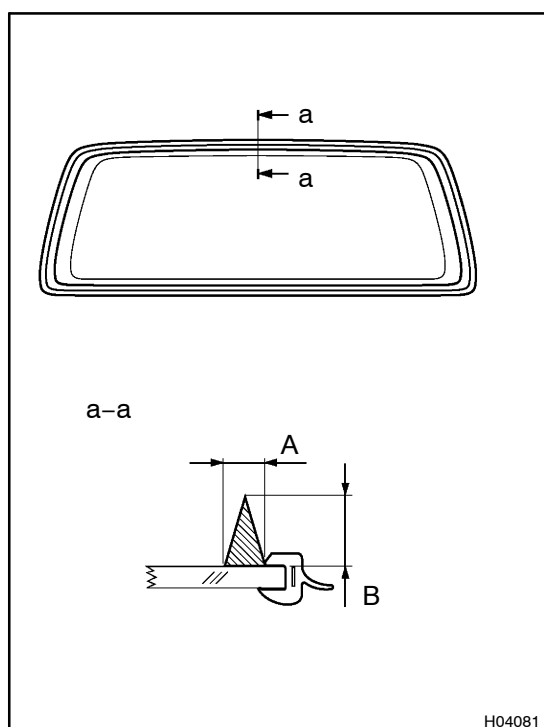

7. APPLY ADHESIVE

- Cut off the tip of the cartridge nozzle.

HINT:

After cutting off the tip, use all adhesive within the time described in the table below.

Temperature	Tackfree time
35 °C (95 °F)	15 minutes
20 °C (68 °F)	100 minutes
5 °C (41 °F)	8 hours

- Load the cartridge into the sealer gun.
- Coat the glass with adhesive, as shown in the illustration.
A: 8.0 mm (0.315 in.)
B: 12.0 mm (0.472 in.)

8. INSTALL BACK DOOR GLASS

- (a) Install the glass to the body.
- (b) Hold back window glass in place securely with protective tape or equivalent until the adhesive hardens.

NOTICE:

Take care not to drive the vehicle during the time described in the table below.

Temperature	Minimum time prior to moving a car
35 °C (95 °F)	1.5 hours
20 °C (68 °F)	5 hours
5 °C (41 °F)	24 hours

9. INSPECT FOR LEAKS AND REPAIR

- (a) Conduct a leak test after the hardening time has elapsed.
- (b) Seal any leak with sealant.

Part No. 08833-00030 or equivalent

Place the moulding onto the body and tap it by hand.

10. INSTALL REAR WIPER ARM (See page BO-59)**11. INSTALL THESE PARTS:**

(See page BO-30)

- (a) Back door garnish
- (b) Center back door garnish
- (c) Inside handle bezel
- (d) Assist grip
- (e) Assist grip plug