

SEAT BELT PRETENSIONER (Mechanical Type) REMOVAL

B01XD-01

NOTICE:

- If the seat belt pretensioner has been dropped or damaged, replace it with a new one.
- Never use seat belt pretensioner from another vehicle. when replacing parts, replace with new parts.

1. REMOVE THESE PARTS:

- Front door scuff plate
- Front door opening trim
- Rear door scuff plate
- Rear door opening trim
- Center pillar lower garnish

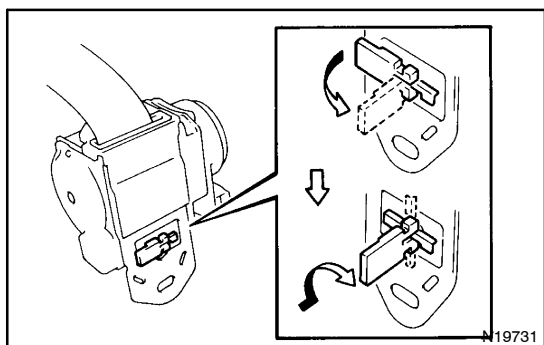

2. REMOVE FRONT SEAT OUTER BELT

CAUTION:

Never disassemble the front seat outer belt.

- Lock the sensor by operation in the safety lock release lever as shown in the illustration.
- Using a screwdriver, remove the seat belt anchor cover cap.

HINT:

Tape the screwdriver tip before use.

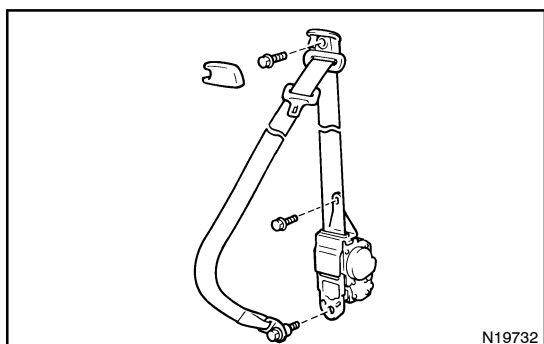

- Remove the 3 bolts and front seat outer belt.