

## INSTALLATION

### NOTICE:

Never use seat belt pretensioner from another vehicle.  
When replacing parts, replace them with new parts.

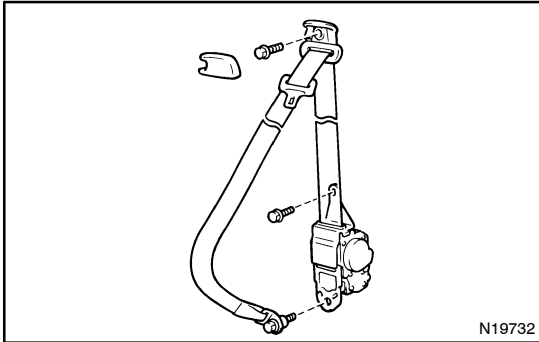

### 1. INSTALL FRONT SEAT OUTER BELT

- (a) Install the outer belt shoulder anchor bolt.

**Torque: 43 N·m (440 kgf·cm, 32 ft·lbf)**

- (b) Install the seat belt anchor cover cap.

- (c) Install the outer belt retractor and floor anchor.

**Torque:**

**Upper bolt: 4.9 N·m (50 kgf·cm, 43 in·lbf)**

**Lower bolt: 43 N·m (440 kgf·cm, 32 ft·lbf)**

### NOTICE:

- Make sure that the front seat outer belt is installed to the specified torque.
- If the front seat outer belt has been dropped, or there are cracks, dents or other defects in the case, replace the front seat outer belt with a new one.
- When installing the front seat outer belt, take care that the wiring does not interfere with other parts and is not pinched between other parts.

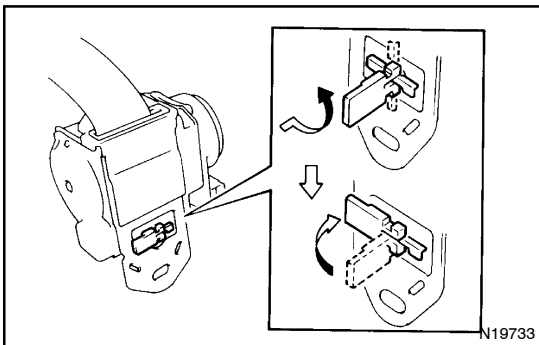

- (d) Unlock the sensor by operating in the safety lock release lever as shown in the illustration.

### 2. INSTALL THESE PARTS:

- (a) Center pillar lower garnish  
(b) Rear door opening trim  
(c) Rear door scuff plate  
(d) Front door opening trim  
(e) Front door scuff plate