

## INSTALLATION

### 1. INSTALL AXLE HUB WITH DISC TO SPINDLE

- Place the axle hub with disc to the spindle.
- Install the outer bearing.
- Install the thrust washer.

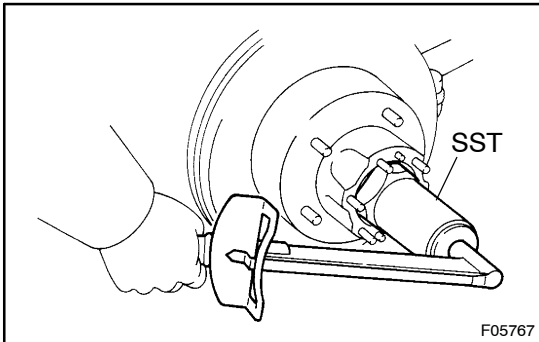

### 2. ADJUST PRELOAD

- Using SST, torque the adjusting nut.  
SST 09607 –60020  
**Torque: 59 N·m (600 kgf·cm, 43 ft·lbf)**
- Turn the hub right and left 2 or 3 times.
- Loosen the nut until it can be turned by hand.
- Using SST, torque the adjusting nut again.  
SST 09607 –60020

**Torque: 5.4 N·m (55 kgf·cm, 48 ft·lbf)**

#### NOTICE:

**Check that the bearing has no play.**

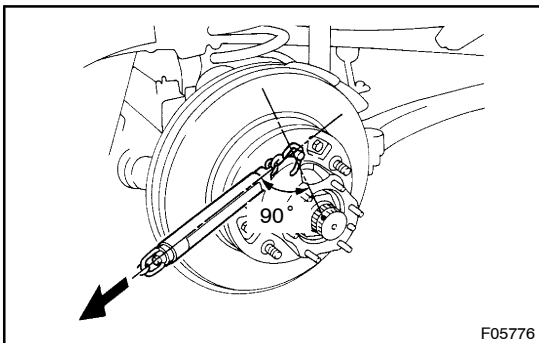

- Using a spring tension gauge, measure the preload.

#### Preload (at starting):

**26 – 52 N (2.7 – 5.3 kgf, 6.0 – 11.7 lbf)**

### 3. INSTALL LOCK WASHER AND LOCK NUT

- Install a new lock washer and lock nut.

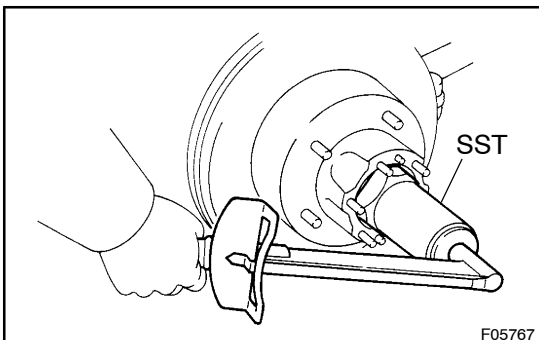

- Using SST, torque the lock nut.

SST 09607 –60020

**Torque: 64 N·m (650 kgf·cm, 47 ft·lbf)**

- Check that axle hub turns smoothly and that the bearing has no play.

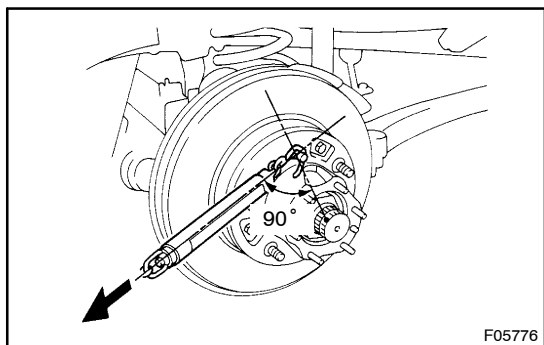

- (d) Using a spring tension gauge, check the preload.

**Preload (at starting):**

**26 – 52 N (2.7 – 5.3 kgf, 6.0 – 11.7 lbf)**

If it is not within the specification, adjust it with the adjusting nut after removing the lock washer and lock nut.

- (e) Secure the lock nut by bending one of the lock washer teeth inward and the other lock washer teeth outward.

**4. w/ Free Wheel Hub:**

**INSTALL FREE WHEEL HUB (See page SA-30)**

**5. w/o Free Wheel Hub:**

**INSTALL FLANGE**

- (a) Place a new gasket in position on the axle hub.  
 (b) Apply MP grease to the inner flange splines.  
 (c) Install the flange to the axle hub.  
 (d) Install the 6 cone washers, plate washers and new nuts.

**Torque: 33 N·m (335 kgf·cm, 24 ft·lbf)**

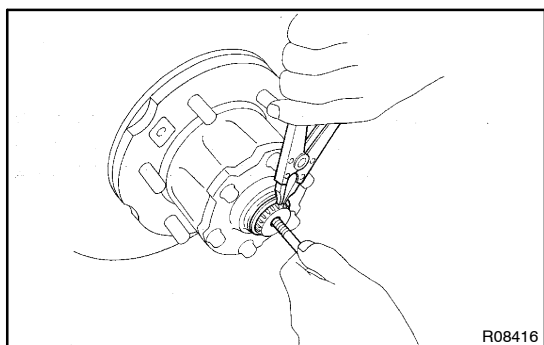

- (e) Install the bolt in the axle shaft and pull it out.  
 (f) Using a snap ring expander, install a new snap ring.  
 (g) Remove the bolt.  
 (h) Coat inside of the new cap with MP grease.  
 (i) Install the cap to the flange.

**6. INSTALL BRAKE CALIPER**

- (a) Install the brake caliper, 2 bolts and washers.

**Torque: 123 N·m (1,250 kgf·cm, 90 ft·lbf)**

- (b) Connect the flexible hose and install 2 new gaskets and bolt.

**Torque: 30 N·m (310 kgf·cm, 22 ft·lbf)**

**7. INSTALL FRONT WHEEL**

**Torque: 209 N·m (2, 131 kgf·cm, 154 ft·lbf)**

**8. BLEED BRAKE LINE (See page BR-10 or BR-5)**