

REMOVAL

1. w/ DIFF. LOCK:

SHIFT FRONT DIFFERENTIAL TO LOCK CONDITION

- (a) Turn the ignition switch to the ON position.
- (b) Shift the transfer shift lever to L4 position.

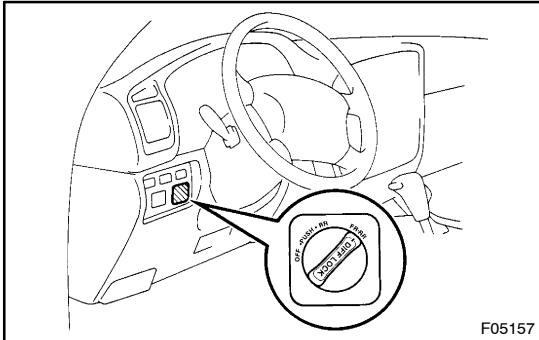

- (c) Turn the differential lock control switch to the FR/RR position and lock the front differential.

HINT:

Rotating the tires, check they are in the differential lock condition.

- (d) Disconnect the cable from the negative terminal of the battery.

2. DRAIN DIFFERENTIAL OIL

Torque: 49 N·m (500 kgf·cm, 36 ft·lbf)

3. REMOVE FRONT AXLE SHAFTS (See page SA-40)

4. DISCONNECT FRONT PROPELLER SHAFT

- (a) Place matchmarks on the flanges.
- (b) Remove the 4 bolts, washers and nuts.
Torque: 80 N·m (820 kgf·cm, 59 ft·lbf)
- (c) Disconnect the front propeller shaft.

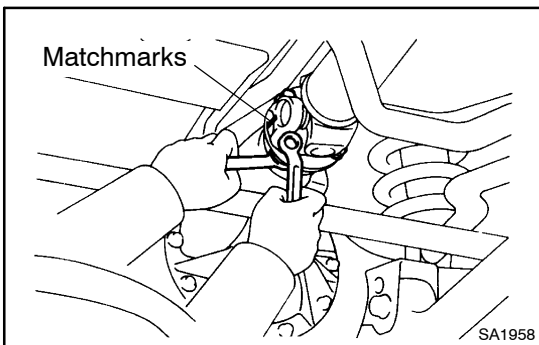

5. w/ DIFF. LOCK:

DISCONNECT CONNECTORS AND TUBE

HINT:

At the time of installation, please refer to the following items.

- When connecting the tube of the harness side to the hose of the actuator side, its depth of insertion is 15 mm (0.59 in.).
- Take care that water or equivalent does not adhere to the connector and hose.

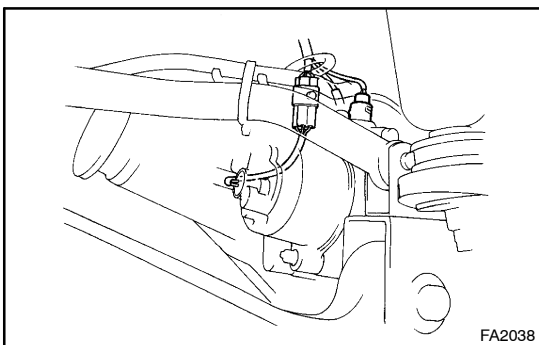

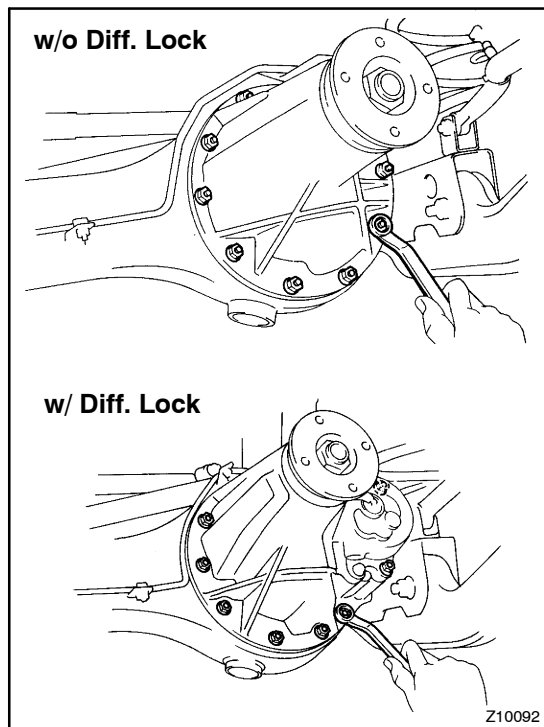
**6. REMOVE DIFFERENTIAL CARRIER ASSEMBLY**

- (a) Remove the 10 nuts (w/o Diff. lock) 11 nuts (w/ Diff. lock), washers and differential carrier assembly.

NOTICE:

Be careful not to damage the installation surface.

Torque: 27 N·m (280 kgf·cm, 20 ft·lbf)

- (b) Remove the gasket.

HINT:

At the time of installation, please refer to the following items.

w/ Diff. lock:

- Before installation, check differential lock operation connecting the connector of the actuator to the connector of the vehicle side.
 - Before installation, check that the sleeves on work with switching over the differential lock control switch.
- After checking, lock the front differential.