

REMOVAL

1. RFS:

REMOVE DIFFERENTIAL CARRIER

- (a) Lock the rear differential.
 - (1) Turn the ignition switch to the ON position.
 - (2) Shift the transfer shift lever to L4 position.

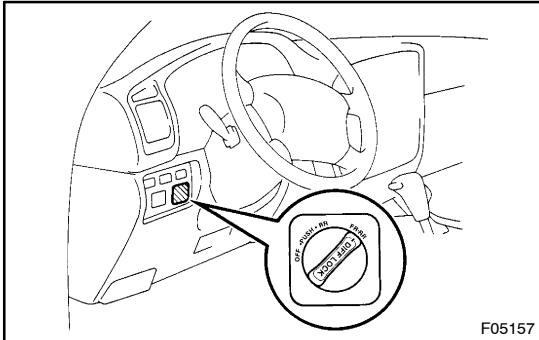

- (3) Turn the differential lock control switch to the RR or FR/RR position and lock the rear differential.

HINT:

While rotating the rear wheels, check they are in the differential lock condition.

- (4) Disconnect the cable from the negative terminal of the battery.
- (b) Drain the hypoid gear oil.

Torque: 49 N·m (500 kgf·cm, 36 ft·lbf)
- (c) Remove the rear axle shafts ([See page SA-155](#)).
- (d) Remove the actuator protector.

Remove the bolt, 2 nuts and protector.

Torque:
Nut: 35 N·m (360 kgf·cm, 26 ft·lbf)
Bolt: 20 N·m (200 kgf·cm, 14 ft·lbf)
- (e) Disconnect the connectors and hose.

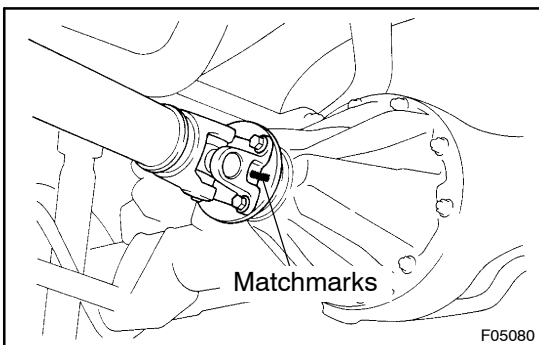
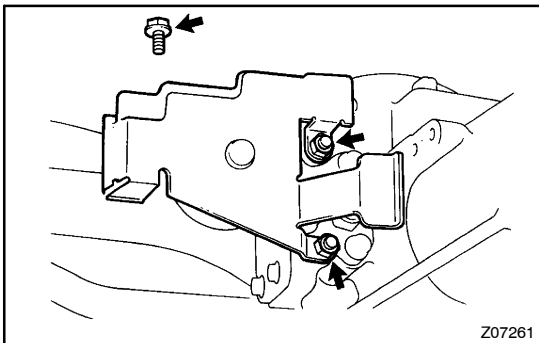

- (f) Disconnect the rear propeller shaft.
 - (1) Place matchmarks on the rear propeller shaft and companion flange.
 - (2) Remove the 4 nuts, washers, bolts and disconnect the propeller shaft.

Torque: 106 N·m (1,080 kgf·cm, 78 ft·lbf)

- (3) Support the propeller shaft securely.

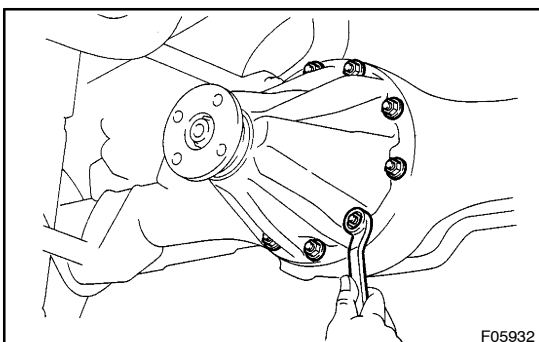

- (g) Remove the differential carrier assembly.
 - (1) Remove the 10 nuts, washers and differential carrier assembly.

Torque: 72 N·m (740 kgf·cm, 53 ft·lbf)

NOTICE:

Be careful not to damage the installation surface.

- (2) Remove the gasket.

HINT:

At the time of installation, please refer to the following items.

- Before installation, connect the connectors of the actuator to the connector on the vehicle side, check the differential lock is in operation.
- Before installation, check that the sleeves are in operation while switching over the differential lock control switch.
- After installation, check that the rear differential lock is in operation.

2. IFS:**REMOVE DIFFERENTIAL CARRIER**

(a) Lock the rear differential.

- (1) Turn the ignition switch to the ON position.
- (2) Shift the transfer shift lever to L4 position.

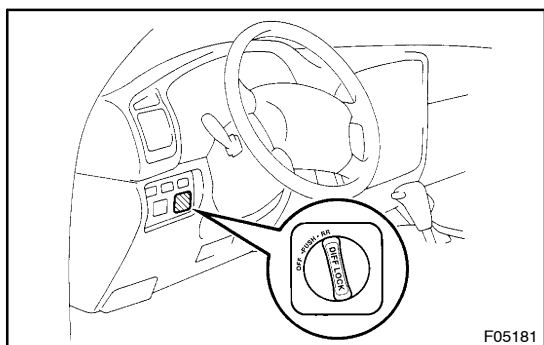

- (3) Turn the differential lock control switch to the RR position and lock the rear differential.

HINT:

While rotating the rear wheels, check they are in the differential lock condition.

- (4) Disconnect the cable from the negative terminal of the battery.
- (b) Remove the rear wheels.

Torque:

Steel wheel: 209 N·m (2, 131 kgf·cm, 154 ft·lbf)

Aluminum wheel: 131 N·m (1,340 kgf·cm, 97 ft·lbf)

(c) Drain the hypoid gear oil.

Torque: 49 N·m (500 kgf·cm, 36 ft·lbf)

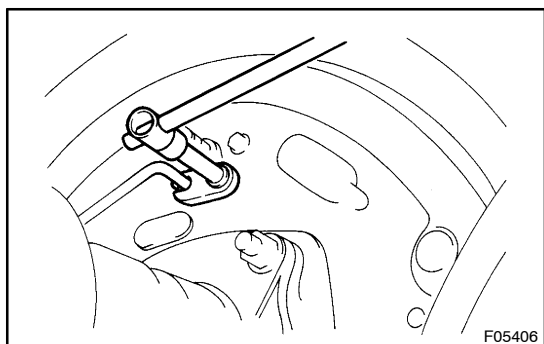

(d) Drum Brake:

Disconnect the brake lines.

- (1) Using SST, disconnect the brake line and remove the clip.

SST09023 -00100

Torque: 15 N·m (155 kgf·cm, 11 ft·lbf)

- (2) Employ the same manner described above to the other side.

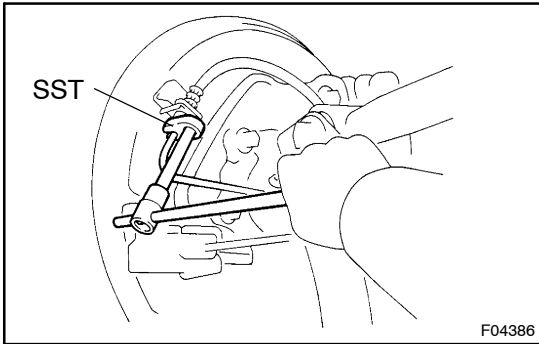

- (e) Disc Brake:
Disconnect the brake lines.
- (1) Using SST, disconnect the brake line and remove the clip.
SST 09023 -00100
Torque: 15 N·m (155 kgf·cm, 11 ft·lbf)
 - (2) Employ the same manner described above to the other side.
- (f) Disconnect the parking brake cables.
- (1) Remove the 2 clips, pin and disconnect the parking brake cable from the bellcrank.
 - (2) Employ the same manner described above to the other side.

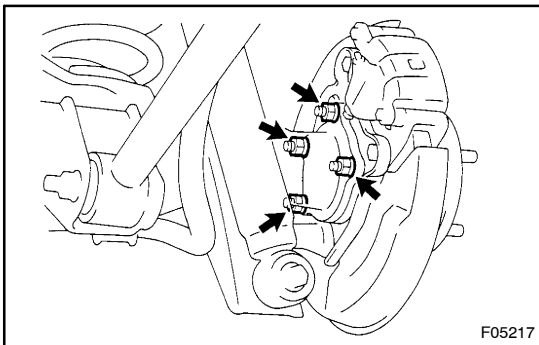

- (g) Remove the rear axle shafts.
- (1) Remove the 4 nuts.
Torque: 123 N·m (1,250 kgf·cm, 90 ft·lbf)
 - (2) Pull out the axle shaft assembly.

NOTICE:

Be careful not to damage the oil seal.

- (3) Employ the same manner described above to the other side.

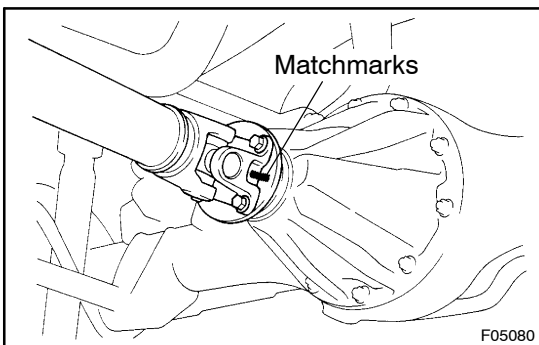

- (h) Disconnect the rear propeller shaft.
- (1) Place matchmarks on the propeller shaft and differential flange.
 - (2) Remove the 4 nuts, washers, bolts and disconnect the propeller shaft.
Torque: 106 N·m (1,080 kgf·cm, 78 ft·lbf)
 - (3) Support the propeller shaft securely.
- (i) Remove the No. 1 and No. 2 actuator protectors.
- (1) Remove the nut, bolt and No. 1 actuator protector.
Torque: 15 N·m (150 kgf·cm, 11 ft·lbf)
 - (2) Remove the 2 nuts and No. 2 actuator protector.
Torque: 36 N·m (367 kgf·cm, 27 ft·lbf)
- (j) Disconnect the connectors and hose.

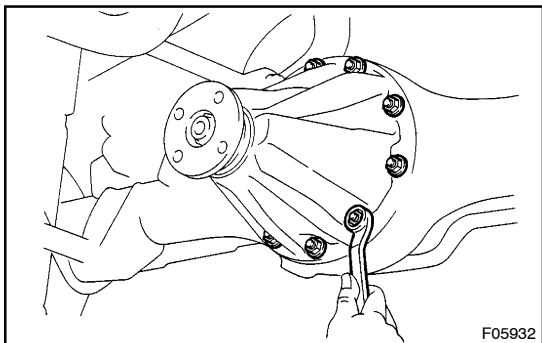

- (k) Remove the differential carrier assembly.
(1) Remove the 10 nuts, washers and differential carrier assembly.

Torque: 72 N·m (740 kgf·cm, 53 ft·lbf)

NOTICE:

Be careful not to damage the installation surface.

- (2) Remove the gasket.

HINT:

At the time of installation, please refer to the following items.

- Before installation, connect the connectors of the actuator to the connector on the vehicle side, check the differential lock is in operation.
- Before installation, check that the sleeves are in operation while switching over the differential lock control switch.
- After installation, check that the rear differential lock is in operation.