

DISASSEMBLY

NOTICE:

When using a vise, do not overtighten it.

1. MEASURE PS VANE PUMP ROTATING TORQUE

- (a) Check that the pump rotates smoothly without abnormal noise.
- (b) Using a torque wrench, check the pump rotating torque.

Rotating torque:

0.3 N·m (2.8 kgf·cm, 2.4 in.·lbf) or less

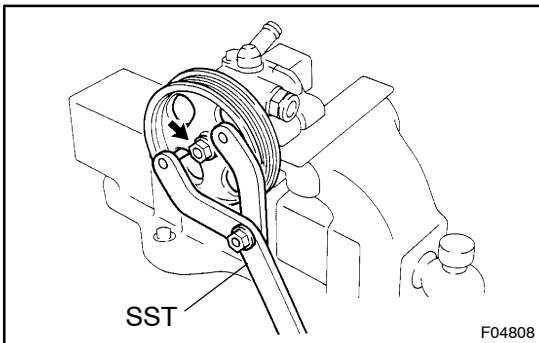

2. REMOVE VANE PUMP PULLEY

Using SST, stop the pulley rotating and remove the pulley set nut.

SST 09960-10010 (09962-01000, 09963-01000)

3. REMOVE SUCTION PORT UNION

- (a) Remove the bolt.
- (b) Remove the O-ring from the union.

4. REMOVE PRESSURE PORT UNION, FLOW CONTROL VALVE AND SPRING

Remove the O-ring from the union.

5. REMOVE REAR HOUSING

- (a) Remove the 4 bolts.

HINT:

If the wave washer and side plate are stuck to the rear housing, lightly tap the rear housing with a plastic hammer, and remove the wave washer and side plate.

- (b) Remove the 2 O-rings from the housing.

6. REMOVE WAVE WASHER

7. REMOVE SIDE PLATE

8. REMOVE GASKET

9. REMOVE CAM RING, 10 VANE PLATES AND VANE PUMP ROTOR

Using a screwdriver, remove the snap ring from the vane pump shaft.

NOTICE:

Be careful not to drop the plate.

10. REMOVE VANE PUMP SHAFT

11. REMOVE 2 STRAIGHT PINS

Remove the pins from the front housing.