

DISASSEMBLY

NOTICE:

When using a vise, do not overtighten it.

1. SECURE PS GEAR ASSEMBLY IN VISE

Using SST, secure the gear assembly in a vise, as shown in the illustration.

SST 09630-00014 (09631-00142)

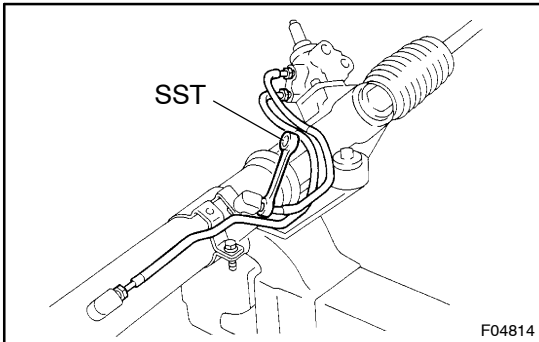

2. REMOVE 2 TURN PRESSURE TUBES

Using SST, remove the tube.

SST 09633-00020

3. REMOVE TUBE SUPPORT RETAINER

Remove the bolt.

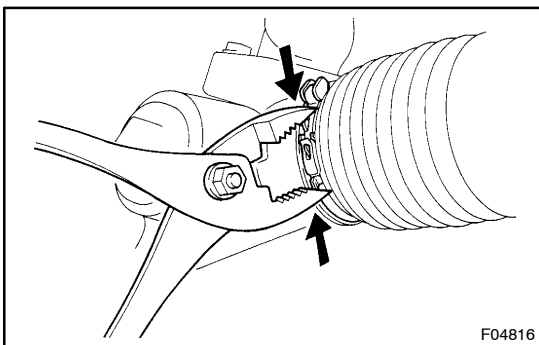

4. REMOVE RH AND LH CLIPS, RACK BOOTS AND CLAMPS

Using pliers, loosen the clamp as shown in the illustration.

NOTICE:

- Be careful not to damage the boot.
- Mark the RH and LH boots.

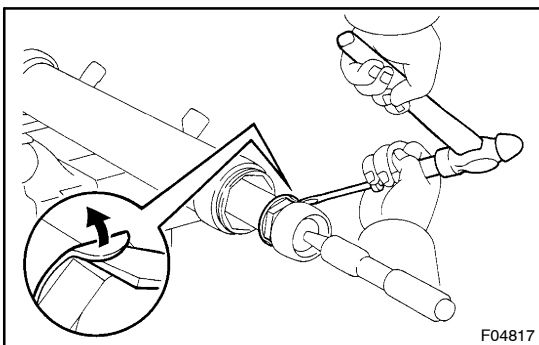

5. REMOVE RH AND LH RACK ENDS AND CLAW WASHERS

(a) Using a screwdriver and hammer, stake back the washer.

NOTICE:

Avoid and impact to the steering rack.

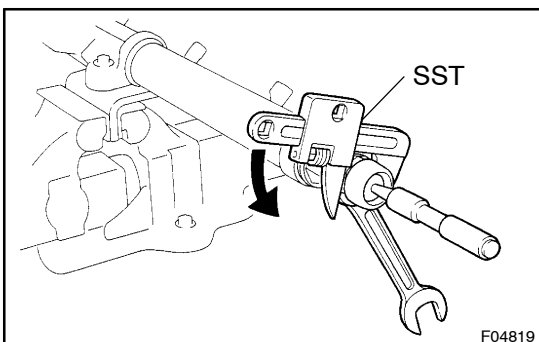

(b) Using a spanner, hold the steering rack steadily and using SST, remove the rack end.

SST 09922-10010

NOTICE:

- Use SST 09922-10010 in the direction shown in the illustration.
- Mark the RH and LH rack ends.

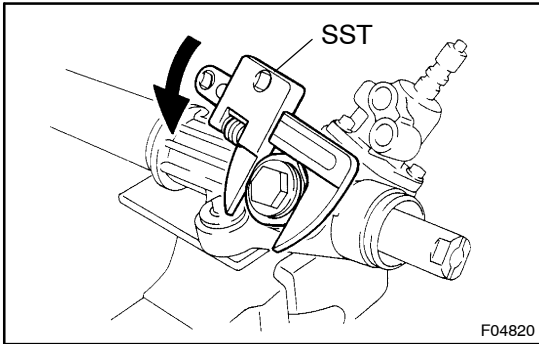
**6. REMOVE RACK GUIDE SPRING CAP LOCK NUT**

Using SST, remove the nut.

SST 09922-10010

NOTICE:

Use SST 09922-10010 in the direction shown in the illustration.

7. REMOVE RACK GUIDE SPRING CAP**8. REMOVE RACK GUIDE SPRING AND RACK GUIDE SUB-ASSEMBLY****9. REMOVE DUST COVER****10. REMOVE CONTROL VALVE HOISING WITH CONTROL VALVE ASSEMBLY**

- Place matchmarks on the valve housing and rack housing.
- Remove the 2 bolts.
- Pull out the control valve assembly with the valve housing.
- Remove the O-ring from the valve housing.

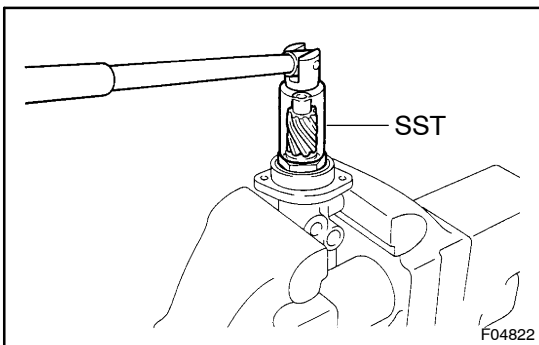
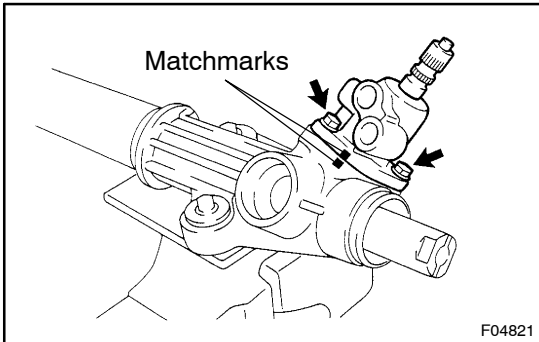
**11. REMOVE CONTROL VALVE ASSEMBLY**

- Using SST, loosen the bearing guide nut.
SST 09631-20060

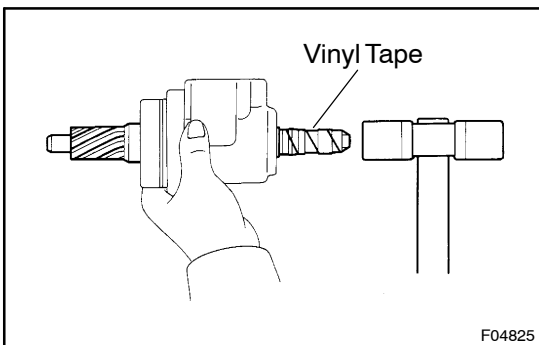

- Wind vinyl tape to the control valve shaft.
- Using a plastic hammer, tap out the valve assembly with the nut from the control valve housing.

NOTICE:

Be careful not to damage the oil seal lip.

- Remove the nut from the valve assembly.

NOTICE:

Be careful not to damage the oil seal lip.

- Remove the O-ring from the nut.

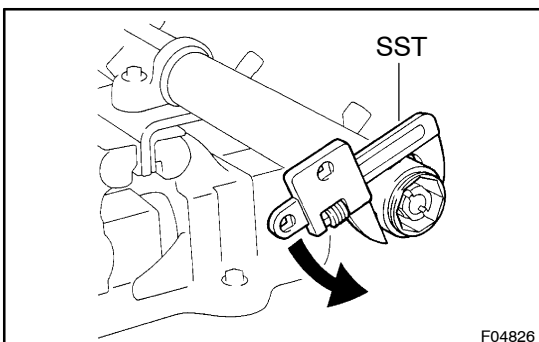
**12. REMOVE CYLINDER END STOPPER AND SPACER**

- Using SST, remove the stopper.
SST 09922-10010

NOTICE:

Use SST 09922-10010 in the direction shown in the illustration.

- Remove the O-ring from the stopper.

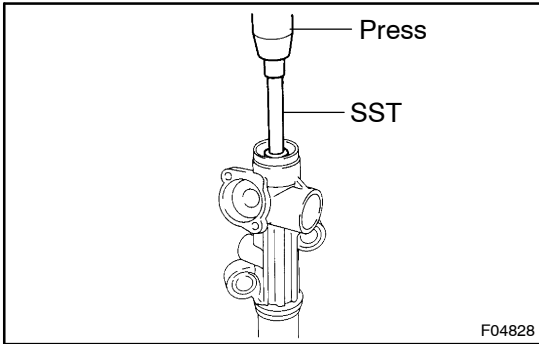

13. REMOVE STEERING RACK AND OIL SEAL

- (a) Using SST, press out the rack and oil seal.

NOTICE:

Take care not to drop the rack.

SST 09950-70010 (09951-07200)

- (b) Remove the oil seal from the rack.

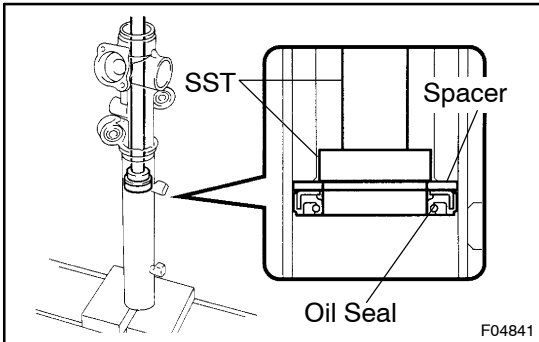

14. REMOVE OIL SEAL AND SPACER

Using SST, press out the oil seal and spacer.

SST 09950-60010 (09951-00360),
09950-70010 (09951-07360)