

## REASSEMBLY

### HINT:

Coat all of the sliding and rotating surfaces with gear oil before reassembly.

### 1. INSTALL BALL BEARING

- (a) Using SST and a press, install the ball bearing.  
SST093 16-60011 (09316-00011, 093 16-00031)

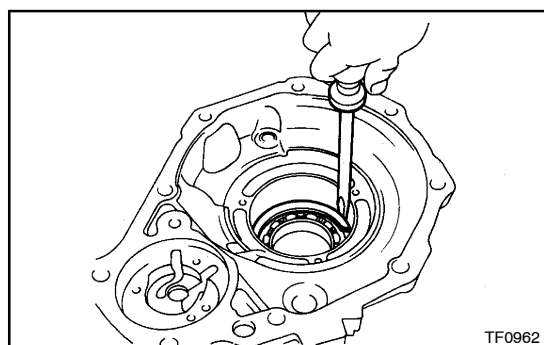

- (b) Select a snap ring that will allow the minimum axial play.

Mark	Thickness mm (in.)
A	1.70 (0.0669)
B	1.80 (0.0709)

- (c) Using a screwdriver, install a new snap ring.

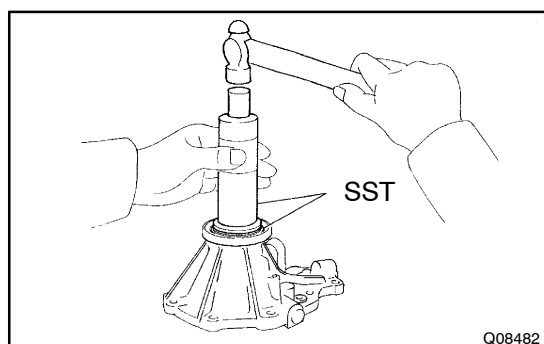

### 2. INSTALL DUST DEFLECTOR

- (a) Using SST and a hammer, install a new rear extension housing dust deflector.  
SST093 16-60011 (09316-00011, 093 16-00041)

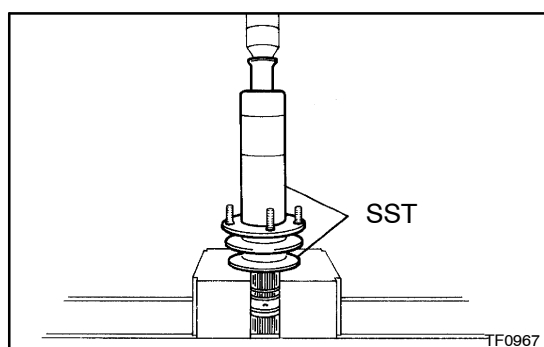

- (b) Using SST and a press, install a new rear output shaft dust deflector.  
SST093 16-20011, 093 16-60011 (09316-00011)

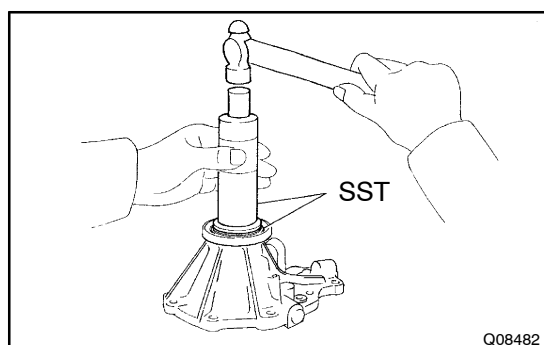

### 3. INSTALL OIL SEAL

- (a) Apply MP grease to the lip of a new oil seal.  
(b) Using SST and a hammer, drive in a new oil seal.  
SST093 16-60011 (09316-00011, 093 16-00031)

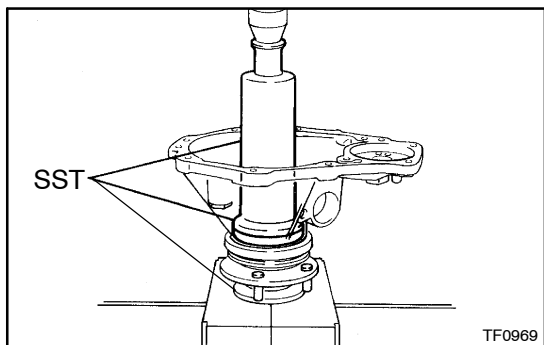

#### 4. INSTALL REAR OUTPUT SHAFT

- (a) Using SST and a press, install the rear output shaft.  
SST093 16-20011, 093 16-60011 (09316-00011, 09316-00031)
- (b) Install the 2 seal rings to the rear output shaft.

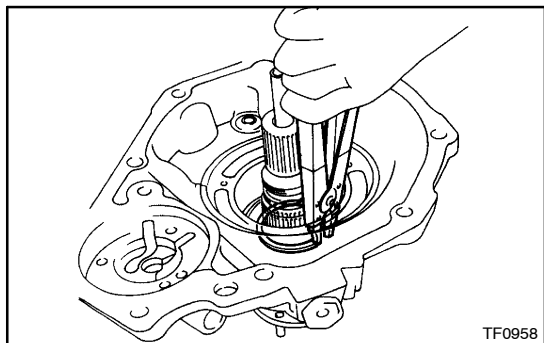

- (c) Select a snap ring that will allow the minimum axial play.

Mark	Thickness mm (in.)
1	1.95 (0.0768)
2	2.05 (0.0807)
3	2.15 (0.0847)
4	2.25 (0.0886)

- (d) Using a snap ring expander, install a new snap ring.

#### 5. INSTALL SPEED SENSOR DRIVE GEAR

- (a) Install the speed sensor drive gear.
- (b) Using a snap ring expander, install the snap ring.

#### 6. INSTALL OIL PUMP PLATE

- (a) Install the oil pump plate.
- (b) Install and torque the 3 bolts.

**Torque: 4.9 N·m (50 kgf·cm, 43 in·lbf)**

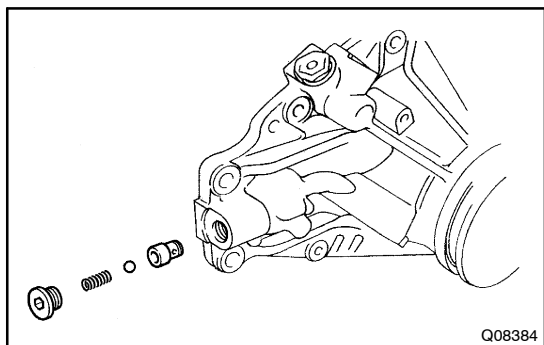

#### 7. INSTALL VALVE SEAT, BALL, SPRING AND SCREW PLUG

- (a) Apply gear oil to the ball.
- (b) Install the valve seat, ball and spring.
- (c) Apply liquid sealer to the screw plug threads.

**Sealant:**

**Part No. 08833 -00080, THREE BOND 1344, LOCTITE 242 or equivalent**

- (d) Using a hexagon wrench, install and torque the screw plug.

**Torque: 29 N·m (300 kgf·cm, 22 ft·lbf)**

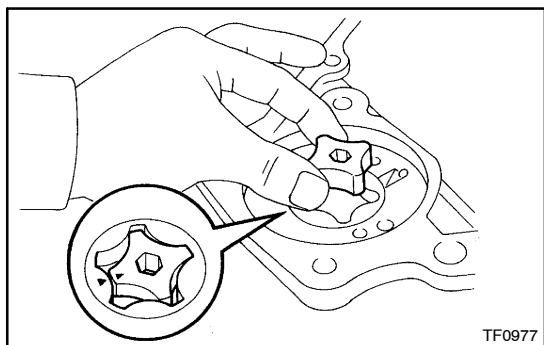
**8. INSTALL DRIVEN ROTOR**

- (a) Apply gear oil to the driven rotor.
- (b) Install the driven rotor.

**9. INSTALL DRIVE ROTOR**

- (a) Apply gear oil to the drive rotor.
- (b) Install the drive rotor.

**HINT:**

Align the alignment marks.

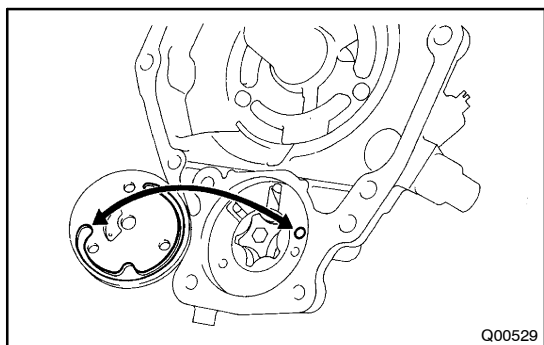
**10. INSTALL OIL PUMP COVER**

- (a) Install the oil pump cover.
- (b) Using a torx socket wrench (T30), install and torque the 3 screws.

**Torque: 4.9 N·m (50 kgf·cm, 43 in·lbf)**

**NOTICE:**

Align the oil hole of the rear extension housing and oil groove end of the oil pump cover.

**11. INSTALL OIL PUMP DRIVE SHAFT**