

## TEST

### NOTICE:

**These tests must be done within 3 to 5 seconds to avoid burning out the coil.**

#### 1. DO PULL -IN TEST

- Disconnect the field coil lead wire from terminal C.
- Connect the battery to the magnetic switch as shown. Check that the pinion gear moves outward.

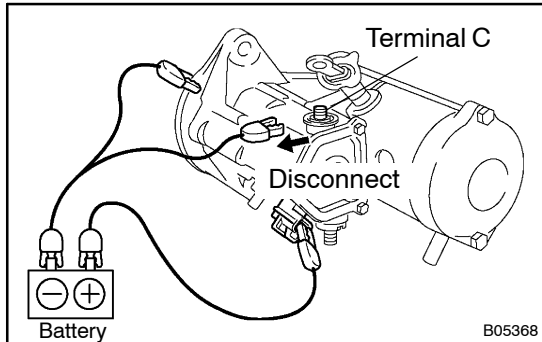

#### 2. DO HOLD -IN TEST

While connected as above with the pinion gear out, disconnect the negative ( - ) lead from terminal C. Check that the pinion gear remains out.

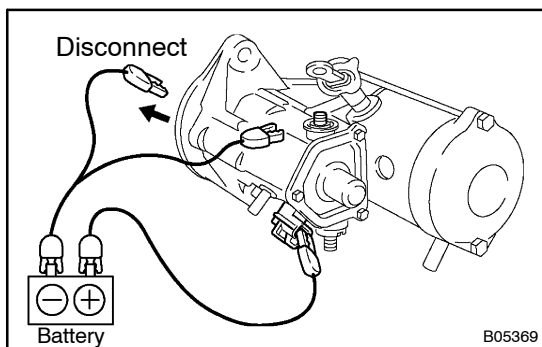

#### 3. INSPECT CLUTCH PINION GEAR RETURN

Disconnect the negative ( - ) lead from the starter body. Check that the pinion gear returns inward.

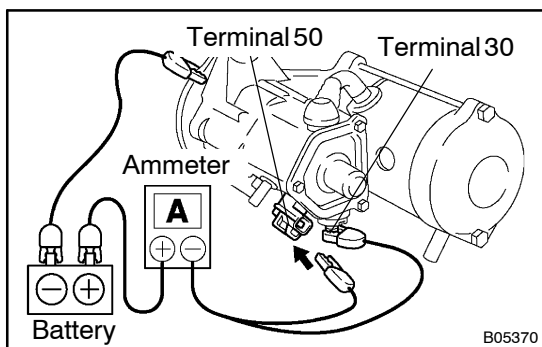

#### 4. DO NO -LOAD PERFORMANCE TEST

- Connect the battery and ammeter to the starter as shown.
- Check that the starter rotates smoothly and steadily with the pinion gear moving out. Check that the ammeter shows the specified current.

**Specified current:**

**220 A or less 11.0 V**