

INSTALLATION

1. INSTALL REINFORCEMENT
2. INSTALL NO. 1 BRACE
3. INSTALL FLOOR BRACE
4. INSTALL GLOVE COMPARTMENT DOOR DAMPER
5. INSTALL NO. 4 HEATER TO REGISTER DUCT
6. INSTALL NO. 3 HEATER TO REGISTER DUCT
7. INSTALL ECU

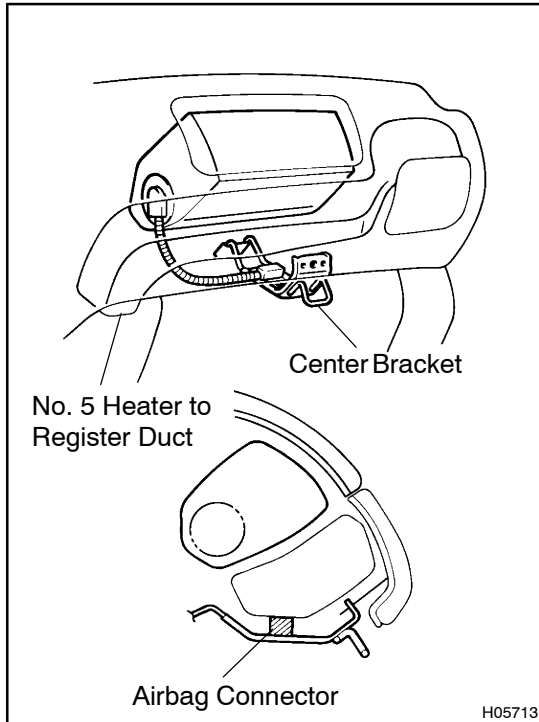

8. INSTALL INSTRUMENT PANEL

HINT:

- Install the airbag connector between the No. 5 heater to register duct and center bracket temporarily, then install the instrument panel.
 - Remove the airbag connector before installing the lower No. 2 panel.
- (a) Install the 6 bolts, 2 nuts and instrument panel, then connect the connectors.
 - (b) Install the 2 bolts to the front passenger airbag assembly.
Torque: 20 N·m (204 kgf·cm, 15 ft·lbf)
 - (c) Connect the junction connectors.

HINT:

The connectors can be connected by tightening the bolts.

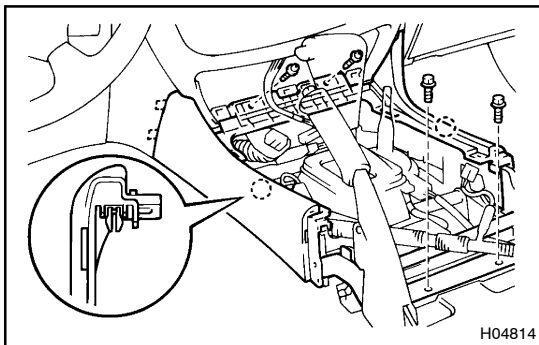

9. Except bench seat:

INSTALL FRONT CONSOLE BOX

Install the front console box with the 2 bolts and 2 screws.

10. Bench seat:

INSTALL TRANSFER LEVER HOLE COVER

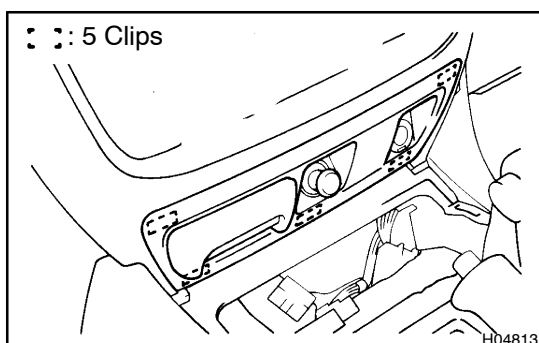

11. INSTALL CENTER LOWER CLUSTER FINISH PANEL

Connect the connector, then install the center lower cluster finish panel.

w/ Cool box:

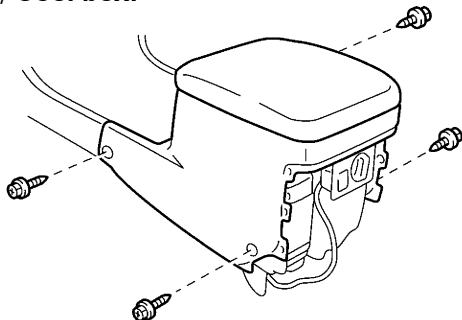

w/o Cool box:

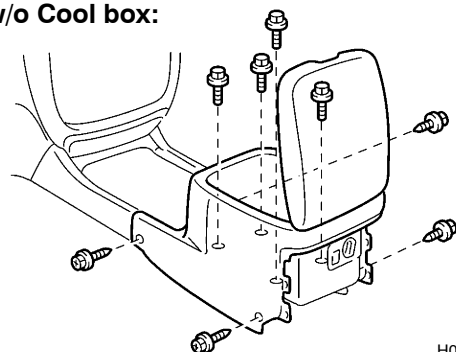

H05753

12. Except bench seat:

INSTALL REAR CONSOLE BOX

- (a) w/ Cool box:
Install the rear console box with the 4 screws.
- (b) w/o Cool box:
Install the rear console box with the 4 bolts and 4 screws.

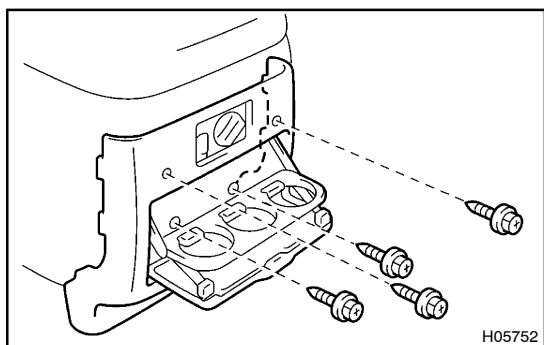

H05752

13. Except bench seat:

INSTALL CONSOLE REAR END PANEL

Install the console rear end panel with the 4 screws.

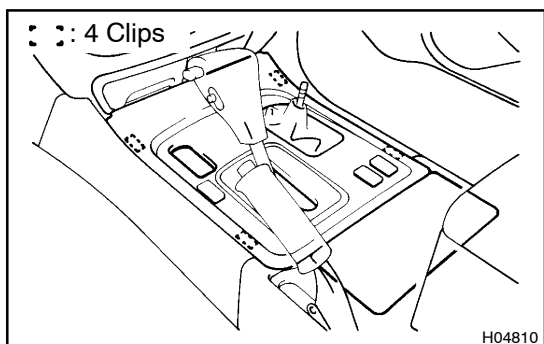

H04810

14. Except bench seat:

INSTALL REAR CONSOLE PANEL

Install the rear console panel, then install the transfer shift lever knob.

15. INSTALL RADIO ASSEMBLY

16. INSTALL CENTER CLUSTER

Connect the connectors, then install the center cluster.

17. INSTALL LOWER NO. 2 PANEL

Install the lower No. 2 panel with the 3 screws.

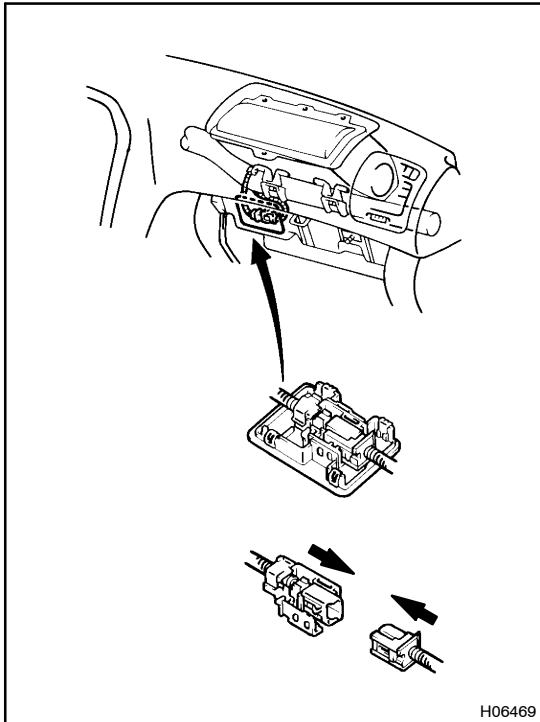

18. CONNECT AIRBAG CONNECTOR (See Pub. No. RM616E on page RS -35)

19. INSTALL GLOVE COMPARTMENT DOOR

- (a) Connect the glove compartment door damper clip, then install the glove compartment door.
- (b) Install the 2 screws.

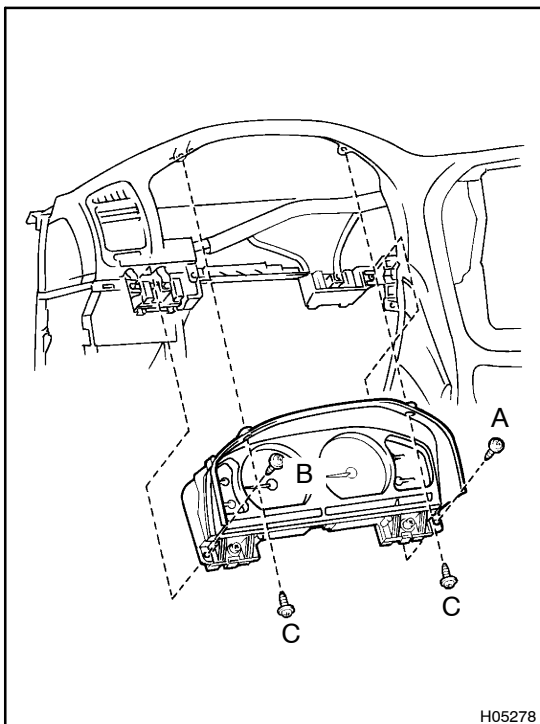

20. INSTALL COMBINATION METER

- (a) Check that the set -in connectors are connected in the installation holes on the instrument panel securely.
- (b) Place the combination meter on the instrument panel.
- (c) Install the combination meter by tightening the screws, "A", "B" and "C" in the order.

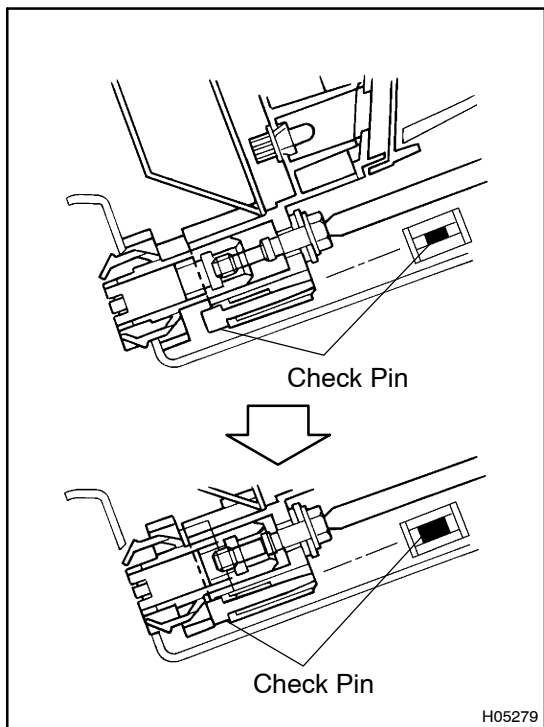

(d) Tighten the connection bolts.

HINT:

- When connection completes, the bolts turn vainly, causing turning noise.
- Check this noise and that the connection check pins protrude from the lower side of the connection bolts.

NOTICE:

Follow the procedures in order of (c) and (d). Otherwise, set-in connectors on the wire harness side and connectors on the meter side might not be connected properly.

21. INSTALL STEERING COLUMN (See Pub. No. RM6 16E on page SR -24 or SR -37)

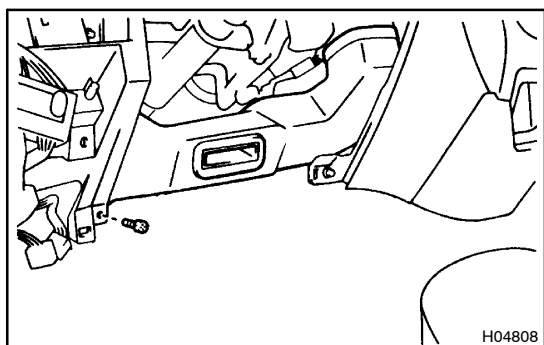

22. INSTALL NO. 2 HEATER TO REGISTER DUCT

Install the No. 2 heater to register duct with the screw.

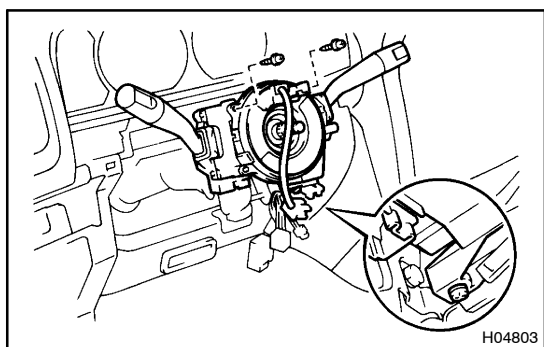

23. INSTALL COMBINATION SWITCH

- Install the combination switch with the 3 screws.
- Install the clamp, then connect the connectors.

24. INSTALL COLUMN COVERS

Install the column covers with the 3 screws.

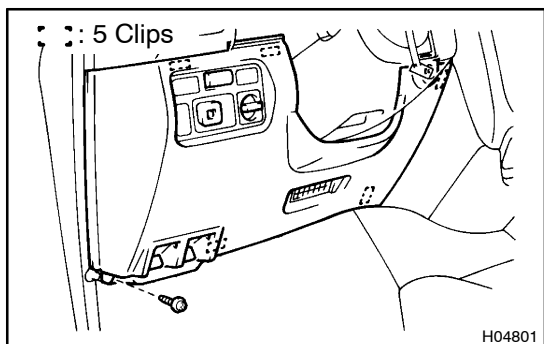

25. INSTALL LOWER NO. 1 PANEL

Connect the connector, then install the lower No. 1 panel with the screw.

26. INSTALL HOOD LOCK AND FUEL LID CONTROL CABLE LEVER

- Install the fuel lid control cable lever with the 2 screws.
- Install the hood lock control cable with the 2 screws.

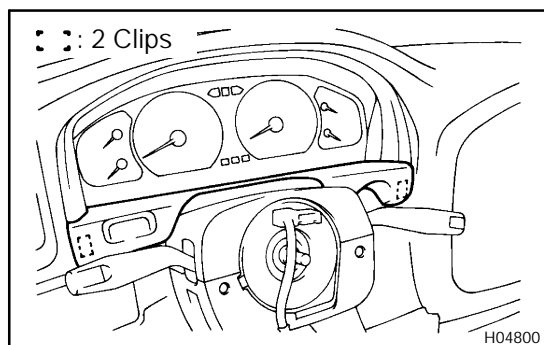

27. **INSTALL CLUSTER FINISH PANEL**
28. **INSTALL STEERING WHEEL** (See Pub. No. RM616E on page SR-24 or SR-37)

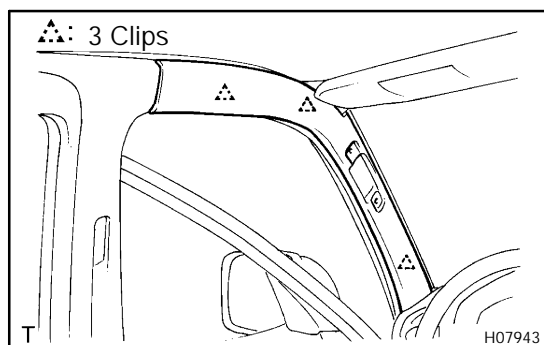

29. **INSTALL FRONT PILLAR GARNISH**
 - (a) Install the front pillar garnish.
 - (b) Employ the same manner described above to the other side.
 - (c) Driver's side:
Install the assist grip with the 2 screws, then install the 2 assist grip plugs.
 - (d) Passenger's side:
Install the 2 assist grips with the 4 screws, then install the 4 assist grip plugs.
30. **INSTALL FRONT DOOR OPENING TRIMS**
31. **INSTALL COWL SIDE TRIMS**
32. **INSTALL FRONT DOOR SCUFF PLATES**