

INSTALLATION

1. INSTALL REINFORCEMENT
2. INSTALL NO. 1 BRACE
3. INSTALL FLOOR BRACE
4. INSTALL GLOVE COMPARTMENT DOOR DAMPER
5. INSTALL NO. 4 HEATER TO REGISTER DUCT
6. INSTALL NO. 3 HEATER TO REGISTER DUCT
7. INSTALL ECU

8. INSTALL INSTRUMENT PANEL

HINT:

- Install the airbag connector between the No. 5 heater to register duct and center bracket temporarily, then install the instrument panel.
 - Remove the airbag connector before installing the lower No. 2 panel.
- (a) Install the 6 bolts, 2 nuts and instrument panel, then connect the connectors.
 - (b) Install the 2 bolts to the front passenger airbag assembly.
Torque: 20 N·m (204 kgf·cm, 15 ft·lbf)
 - (c) Connect the junction connectors.

HINT:

The connectors can be connected by tightening the bolts.

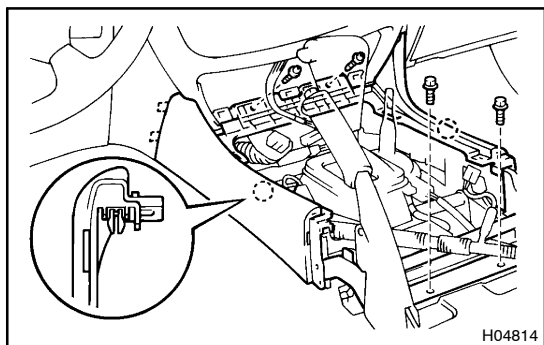
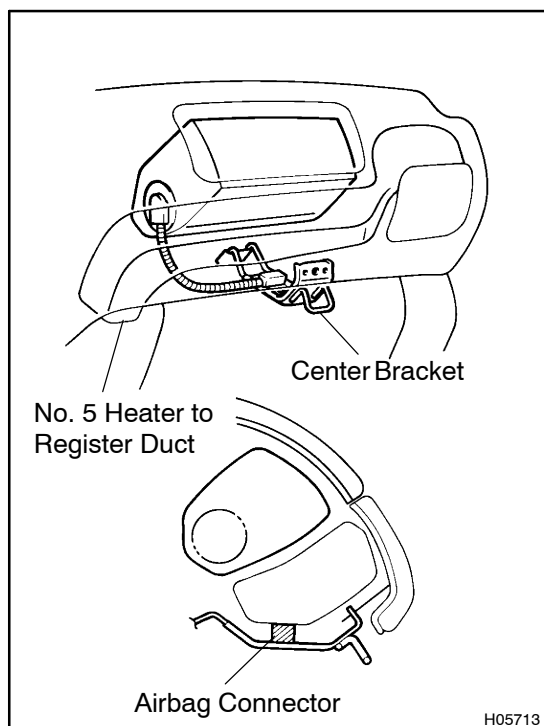

9. INSTALL FRONT CONSOLE BOX

Install the front console box with the 2 bolts and 2 screws.

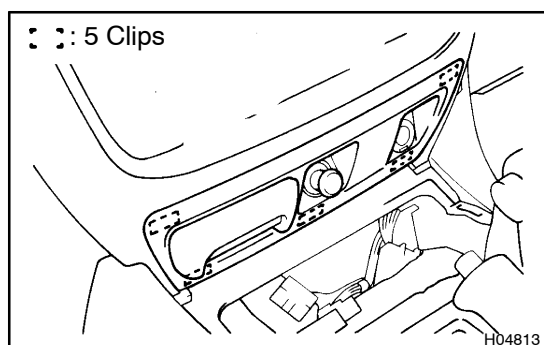

10. INSTALL CENTER LOWER CLUSTER FINISH PANEL

Connect the connector, then install the center lower cluster finish panel.

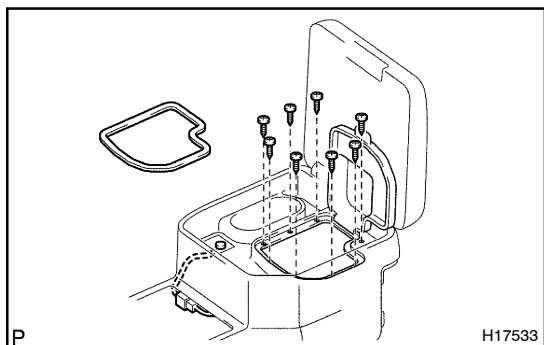
**11. INSTALL REAR CONSOLE BOX**

- (a) w/ Cool box:
Install the rear console box with the 8 screws.
- (b) w/ Cool box:
Install new door packing.
- (c) w/ Cool box:
Connect the connector.

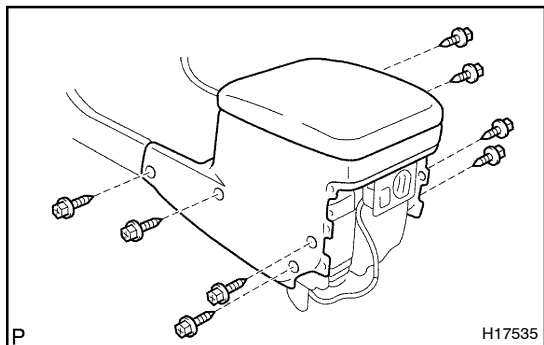

- (d) w/ Cool box:
Install the 8 screws.

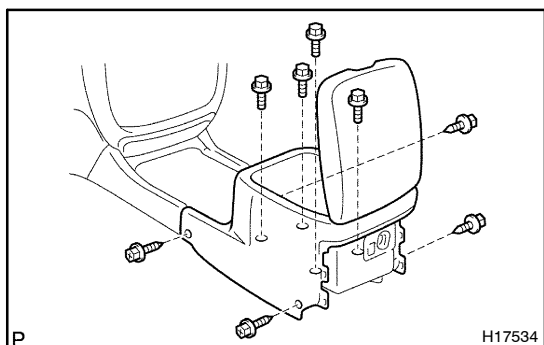

- (e) w/o Cool box:
Install the rear console box with the 4 bolts and 4 screws.

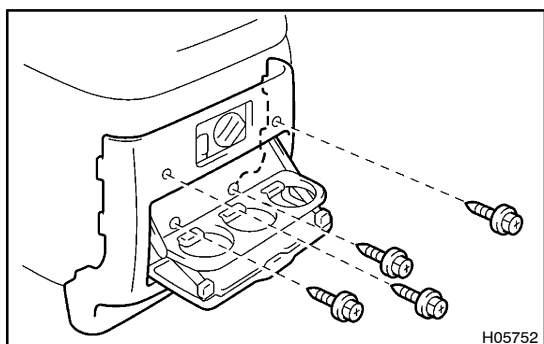
**12. INSTALL CONSOLE REAR END PANEL**

Install the console rear end panel with the 4 screws.

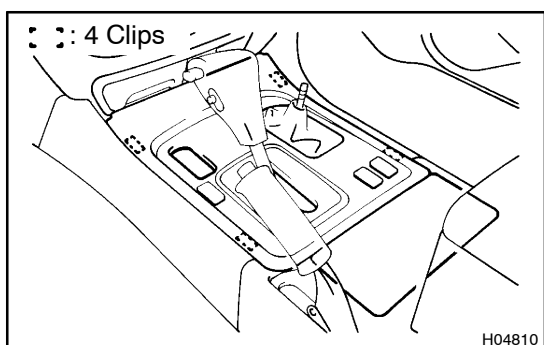
**13. INSTALL REAR CONSOLE PANEL**

Install the rear console panel, then install the transfer shift lever knob.

14. INSTALL NAVIGATION SYSTEM WITH A/C CONTROL ASSEMBLY

- (a) Connect the connectors, then install the navigation system with A/C control assembly.
- (b) Install the 4 screws.

15. INSTALL CENTER CLUSTER

Connect the connectors, then install the center cluster.

16. INSTALL LOWER NO. 2 PANEL

Install the lower No. 2 panel with the 3 screws.

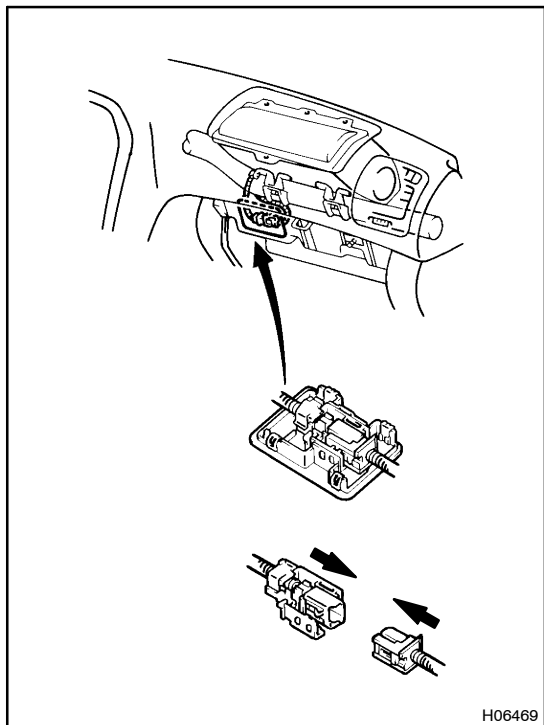

H06469

17. CONNECT AIRBAG CONNECTOR (See Pub. No. RM616E on page RS -35)**18. INSTALL GLOVE COMPARTMENT DOOR**

- (a) Connect the glove compartment door damper clip, then install the glove compartment door.
- (b) Install the 2 screws.

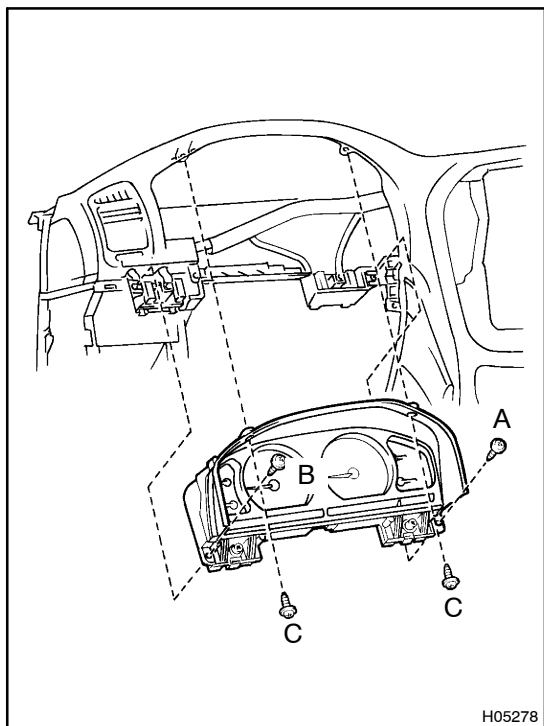

H05278

19. INSTALL COMBINATION METER

- (a) Check that the set -in connectors are connected in the installation holes on the instrument panel securely.
- (b) Place the combination meter on the instrument panel.
- (c) Install the combination meter by tightening the screws, "A", "B" and "C" in the order.

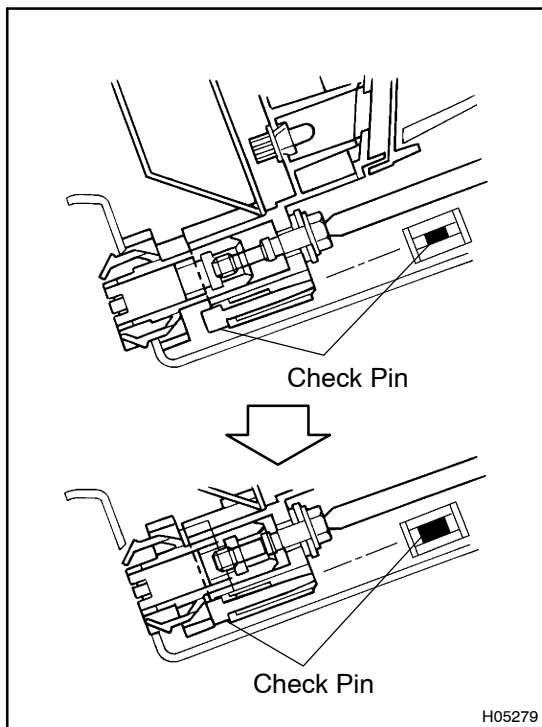

(d) Tighten the connection bolts.

HINT:

- When connection completes, the bolts turn vainly, causing turning noise.
- Check this noise and that the connection check pins protrude from the lower side of the connection bolts.

NOTICE:

Follow the procedures in order of (c) and (d). Otherwise, set-in connectors on the wire harness side and connectors on the meter side might not be connected properly.

20. INSTALL STEERING COLUMN (See Pub. No. RM6 16E on page SR -24 or SR -37)

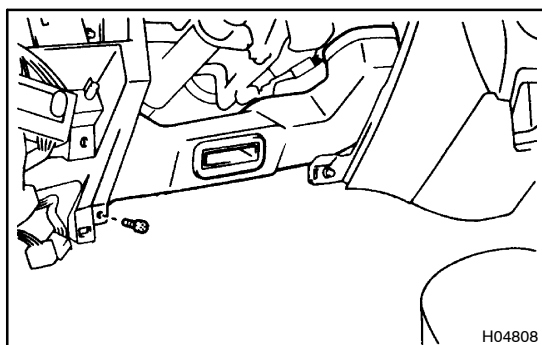

21. INSTALL NO. 2 HEATER TO REGISTER DUCT

Install the No. 2 heater to register duct with the screw.

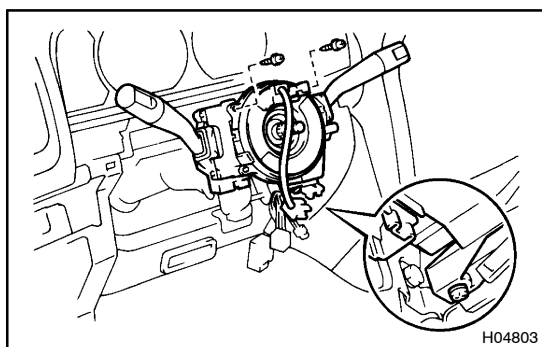

22. INSTALL COMBINATION SWITCH

- Install the combination switch with the 3 screws.
- Install the clamp, then connect the connectors.

23. INSTALL COLUMN COVERS

Install the column covers with the 3 screws.

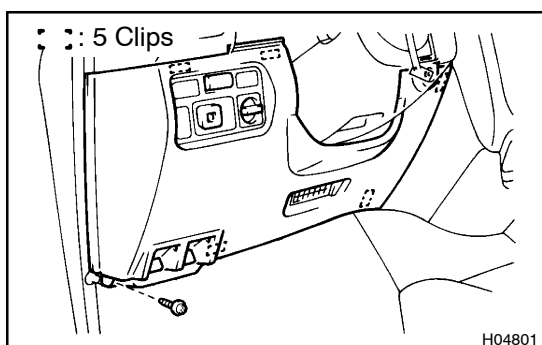

24. INSTALL LOWER NO. 1 PANEL

Connect the connector, then install the lower No. 1 panel with the screw.

25. INSTALL HOOD LOCK AND FUEL LID CONTROL CABLE LEVER

- Install the fuel lid control cable lever with the 2 screws.
- Install the hood lock control cable with the 2 screws.

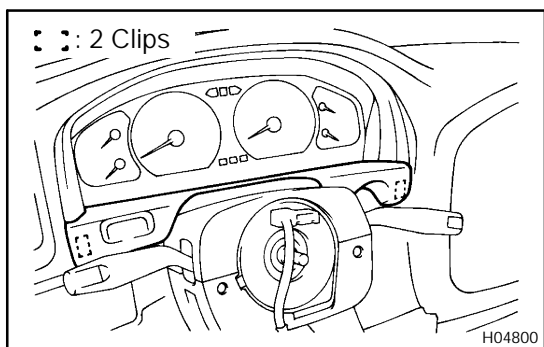

26. **INSTALL CLUSTER FINISH PANEL**
27. **INSTALL STEERING WHEEL** (See Pub. No. RM616E on page SR-24 or SR-37)

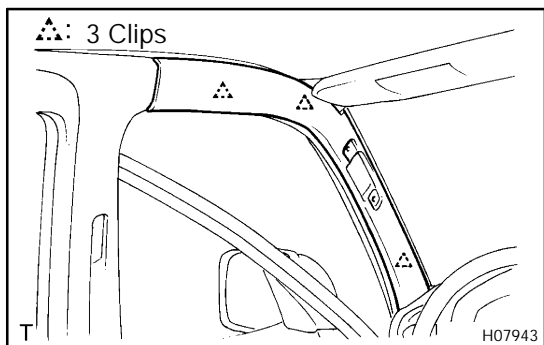

28. **INSTALL FRONT PILLAR GARNISH**
 - (a) Install the front pillar garnish.
 - (b) Use the same manner described above to the other side.
 - (c) Driver's side:
Install the assist grip with the 2 screws, then install the 2 assist grip plugs.
 - (d) Passenger's side:
Install the 2 assist grips with the 4 screws, then install the 4 assist grip plugs.
29. **INSTALL FRONT DOOR OPENING TRIMS**
30. **INSTALL COWL SIDE TRIMS**
31. **INSTALL FRONT DOOR SCUFF PLATES**