

## REMOVAL

### 1. REMOVE CENTER RESISTOR

Disengage the 12 clips and remove the center resistors, then disconnect the connectors.

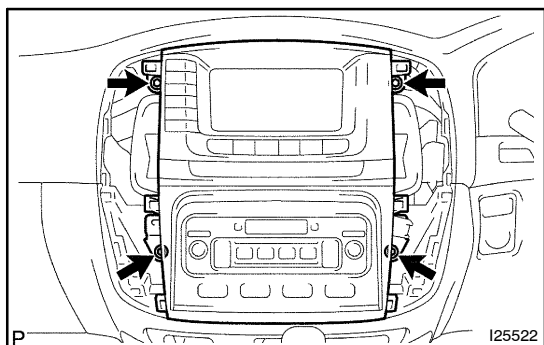

### 2. REMOVE INTEGRATION CONTROL PANEL ASSEMBLY

- (a) Remove the 4 bolts.
- (b) Remove the integration control panel assembly, then disconnect the connector.

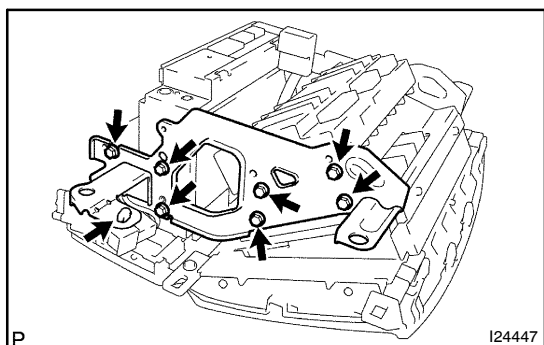

### 3. w/ navigation system: REMOVE A/C AMPLIFIER

- (a) Disconnect the connector clamp.
- (b) Remove the 3 screws, 4 bolts and radio receiver bracket LH.

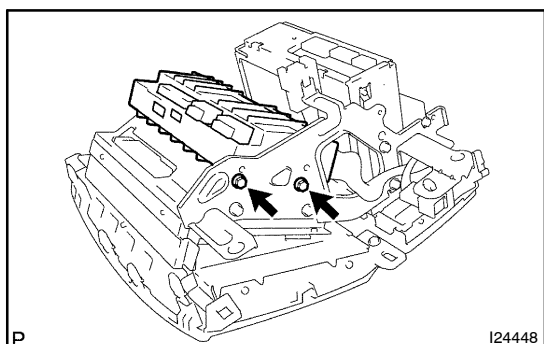

- (c) Remove the 2 screws and A/C amplifier.

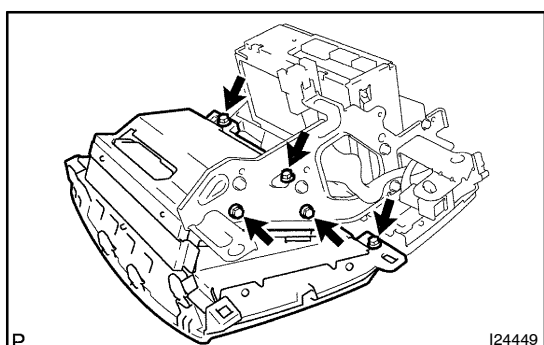

### 4. w/ navigation system: REMOVE EMV

Remove the 3 screws, 2 bolts and EMV.

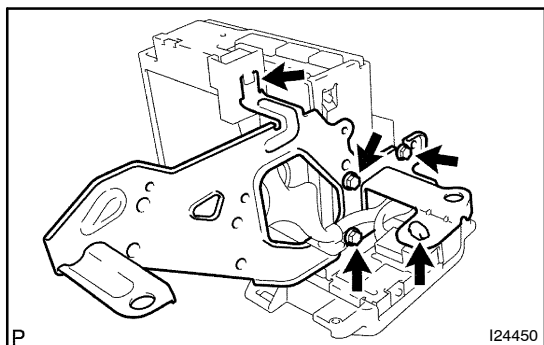
**5. w/ navigation system:****REMOVE INTEGRATION CONTROL PANEL**

- (a) Disconnect the connector clamps.
- (b) Remove the screw, 2 bolts and radio receiver bracket RH.
- (c) Remove the integration control panel from radio receiver.

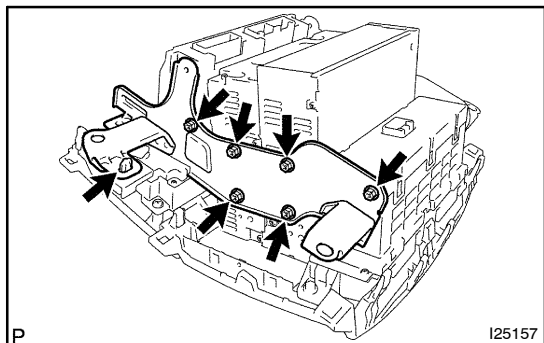
**6. w/o navigation system****Original Shape Radio:****REMOVE INTEGRATION CONTROL PANEL**

- (a) Disconnect the connector clamp.
- (b) Remove the 2 screws, 4 bolts and radio receiver bracket LH.

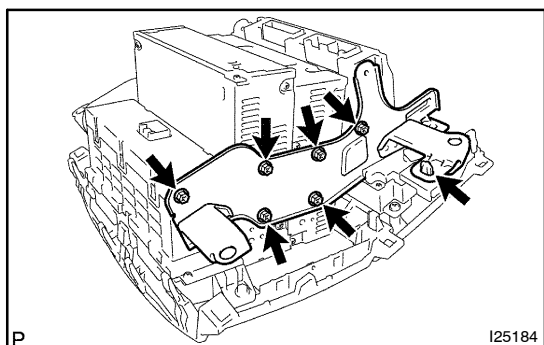

- (c) Disconnect the connector clamp.
- (d) Remove the 2 screws, 4 bolts and radio receiver bracket RH.
- (e) Remove the integration control panel.

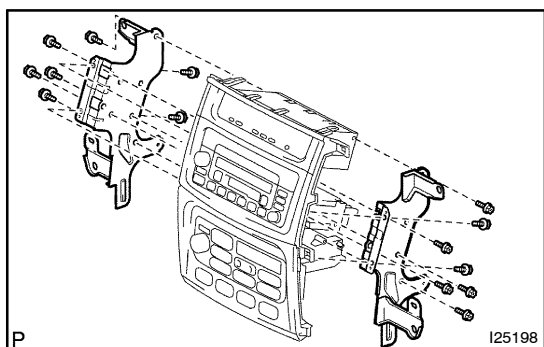
**7. w/o navigation system****Except original shape radio:****REMOVE INTEGRATION CONTROL PANEL**

- (a) Remove 10 screws, 4 bolts and radio receiver bracket LH, RH.
- (b) Remove the radio receiver.

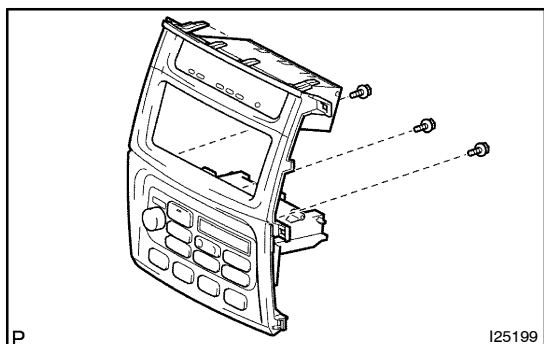

- (c) Remove 3 screws and integration control panel.