

REMOVAL

1. w/ CD Changer Built In The Audio System:

SHIP MODE SETTING

- (a) Take out all of the CDs.

NOTICE:

If they cannot be taken out, do not attempt to take out forcibly and send the unit for repair.

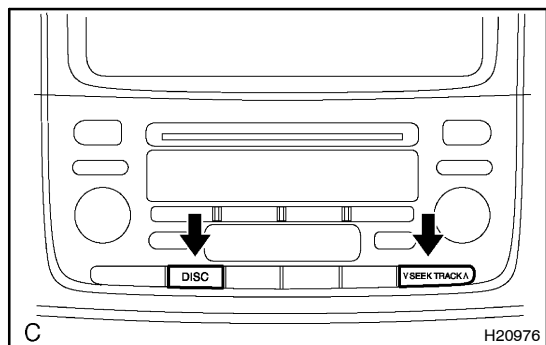

- (b) Turn the ignition switch to ACC as pressing the "SEEK UP" and "DISC" switches at the same time.

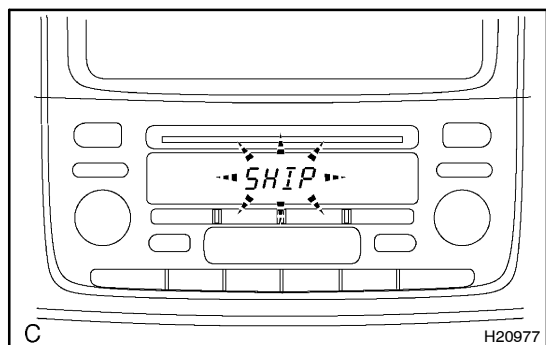

HINT:

When the ship mode has been set, "SHIP" must be displayed.

- (c) Turn the ignition switch to OFF and disconnect the battery negative cable.

NOTICE:

Connecting the battery negative cable automatically end the ship mode.

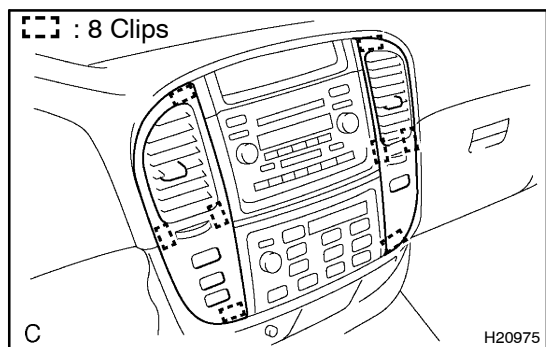

2. REMOVE CENTER REGISTER

- (a) Using a moulding remover, remove the center register.
 (b) Disconnect the connector.
 (c) Use the same manner described above to the other side.

3. REMOVE RADIO WITH A/C CONTROL ASSEMBLY

- (a) Remove the 4 bolts.
 (b) Disconnect the radio with A/C control assembly cable and remove the radio with A/C control assembly.

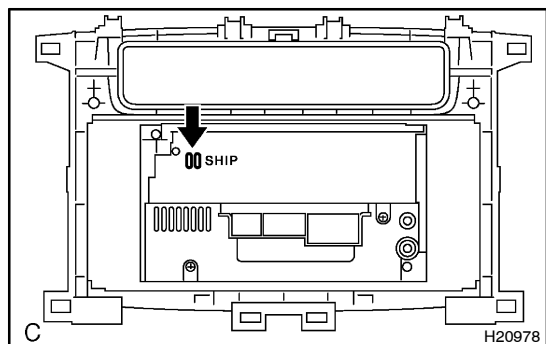

4. w/ CD Changer Built In The Audio System:

SHIP MODE CONFIRMATION

Check that a metal can be seen from a holes marked "SHIP" on the back of the radio with A/C control assembly.

NOTICE:

If a metal cannot be seen from a hole on the back of the radio with A/C control assembly, repeat "SHIP MODE".

5. REMOVE FRONT DOOR SCUFF PLATES

6. REMOVE COWL SIDE TRIMS

7. REMOVE FRONT DOOR OPENING TRIMS

8. REMOVE FRONT ASSIST GRIP

- (a) Using a screwdriver, remove the assist grip plugs, then remove the 2 screws and assist grip.

HINT:

Tape up the screwdriver tip before use.

- (b) Use the same manner described above to the other side.

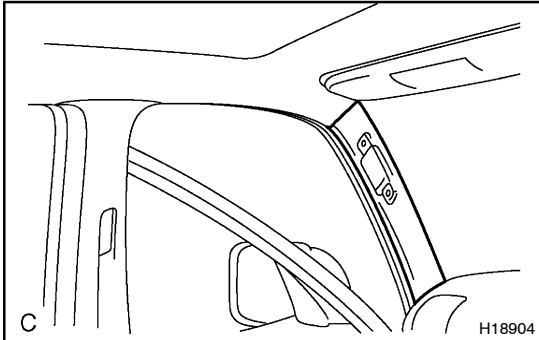
**9. REMOVE FRONT PILLAR GARNISH**

- (a) Using a screwdriver, remove the front pillar garnish.

HINT:

Tape up the screwdriver tip before use.

- (b) Use the same manner described above to the other side.

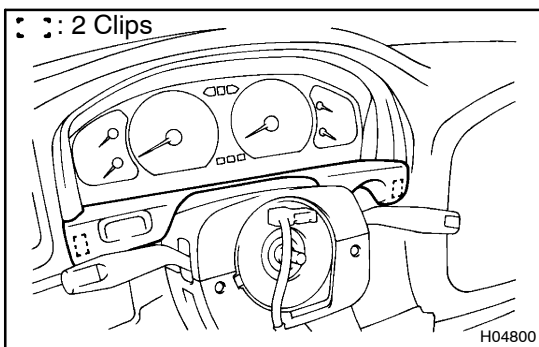
10. REMOVE STEERING WHEEL (See page SR-7 or See Pub.No.RM6 16E, page SR -13)**11. REMOVE CLUSTER FINISH PANEL**

- (a) Using a screwdriver, remove the cluster finish panel.

HINT:

Tape up the screwdriver tip before use.

- (b) w/ Rheostat:

Disconnect the connector.

12. REMOVE HOOD LOCK CONTROL CABLE LEVER AND FUEL LID CONTROL CABLE LEVER

- (a) Remove the 2 screws and the hood lock control cable lever.

- (b) Remove the 2 screws and the fuel lid control cable lever.

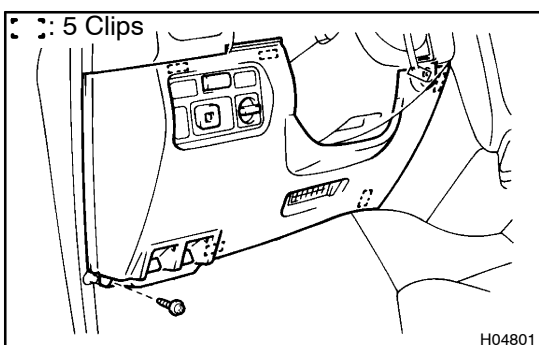
**13. REMOVE LOWER NO. 1 PANEL**

- (a) Remove the screw.

- (b) Using a screwdriver, remove the lower No. 1 panel, then disconnect the connectors.

HINT:

Tape up the screwdriver tip before use.

14. REMOVE COLUMN COVERS

Remove the 3 screws and the column covers.

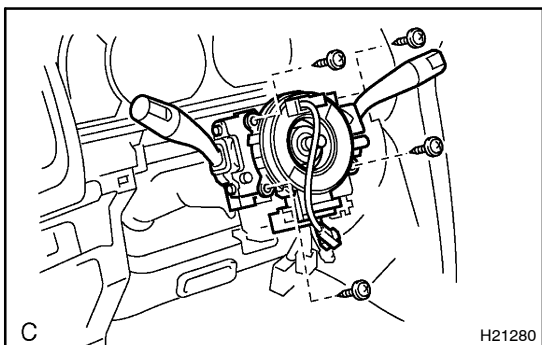
**15. REMOVE COMBINATION SWITCH**

- (a) Disconnect the connectors.
- (b) Remove the clamp.
- (c) Remove the 4 screws and the combination switch.

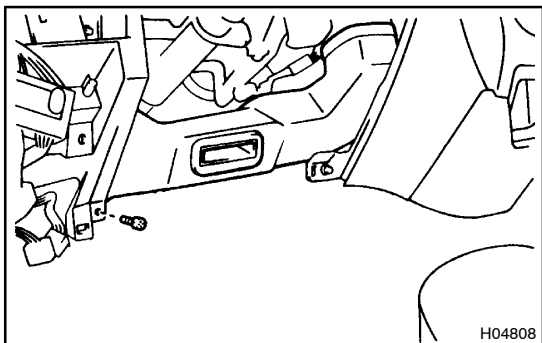
**16. REMOVE NO. 2 HEATER TO REGISTER DUCT**

Remove the screw and the No. 2 heater to register duct as shown in the illustration.

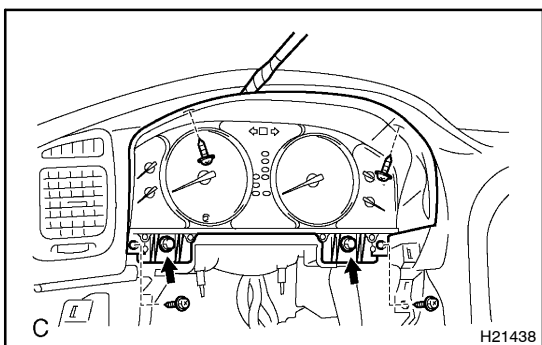
17. REMOVE STEERING COLUMN (See page SR-7 or See Pub. No. RM616E, page SR-13)**18. REMOVE COMBINATION METER**

- (a) Disconnect the connectors.

HINT:

The connectors can be disconnected by loosening the bolts.

- (b) Remove the 4 screws.
- (c) Using a screwdriver, remove the combination meter.

HINT:

Tape up the screwdriver tip before use.

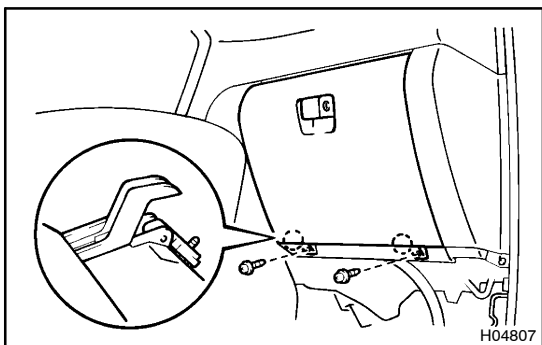
**19. REMOVE GLOVE COMPARTMENT DOOR**

- (a) Remove the 2 screws.
- (b) Remove the glove compartment door, then disconnect the glove compartment door damper clip.

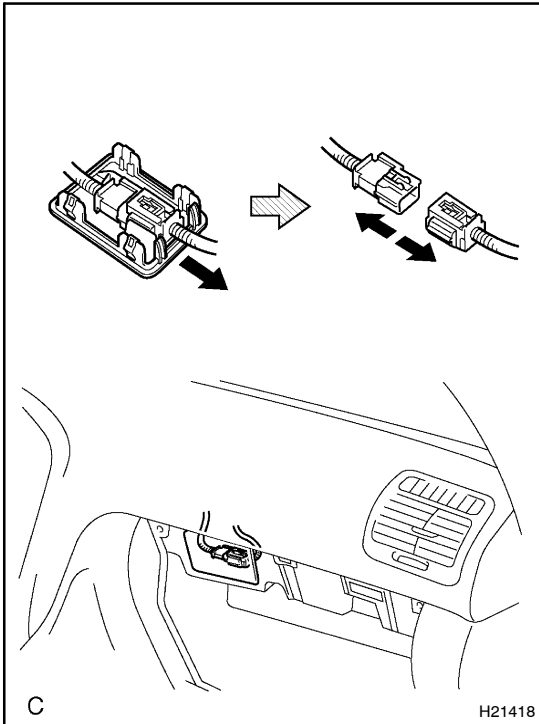

20. DISCONNECT AIRBAG CONNECTOR (See page RS-32)

(a) Using a screwdriver, remove the No. 1 under cover.

HINT:

Tape up the screwdriver tip before use.

(b) Slide the airbag connector to pull out from the No. 1 under cover.

(c) Disconnect the airbag connector.

NOTICE:

When handling the airbag connector, take care not to damage the airbag wire harness.

21. REMOVE LOWER NO. 2 PANEL

Remove the 3 screws and the lower No. 2 panel.

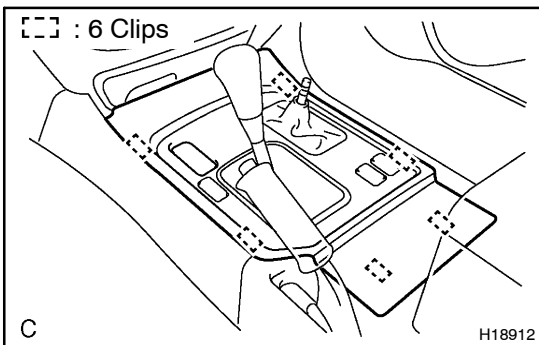

22. REMOVE FRONT CONSOLE PANEL

(a) Remove the transfer shift lever knob.

(b) Using a screwdriver, remove the front console panel.

HINT:

Tape up the screwdriver tip before use.

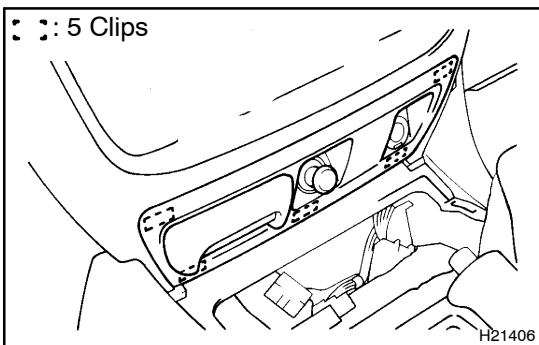

23. REMOVE CENTER LOWER CLUSTER FINISH PANEL

Using a screwdriver, remove the center lower cluster finish panel, then disconnect the connector.

HINT:

Tape up the screwdriver tip before use.

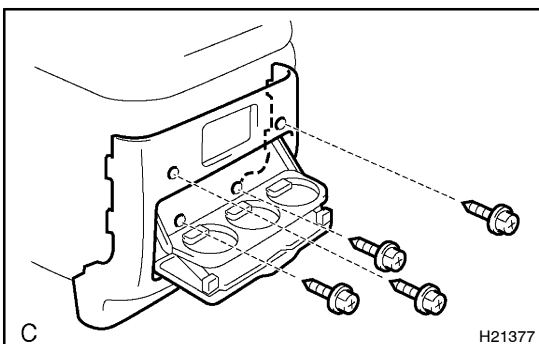

24. REMOVE CONSOLE REAR END PANEL

(a) w/o Rear Radio Control and Rear Heater Control:

Using a screwdriver, remove the rear switch hole cover.

HINT:

Tape up the screwdriver tip before use.

(b) Remove the 4 screws.

(c) Using a screwdriver, remove the console rear end panel.

HINT:

Tape up the screwdriver tip before use.

- (d) w/ Rear Radio Control or Rear Heater Control:
Remove the 3 screws and the rear radio control or the rear heater control.

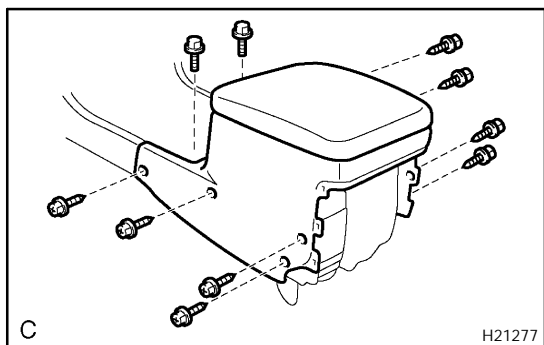

25. REMOVE REAR CONSOLE BOX AND FRONT CONSOLE BOX

- (a) w/ Cool box:
Remove the 2 bolts and the 8 screws.

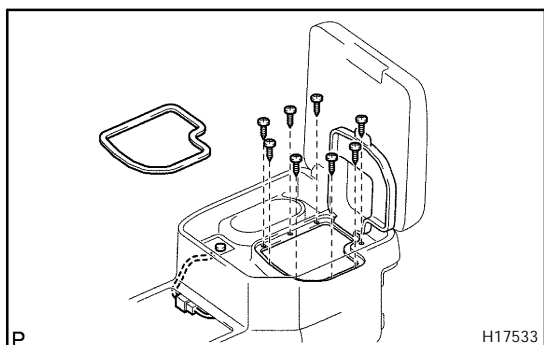

- (b) w/ Cool box:
Disconnect the connector.
- (c) w/ Cool box:
Remove the door packing, the 8 screws, the rear console box and the front console box.

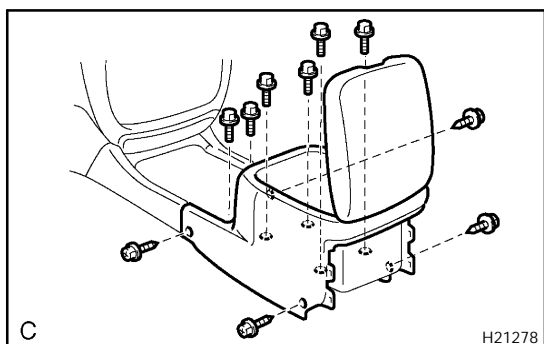

- (d) w/o Cool box:
Remove the 6 bolts, the 4 screws, the rear console box and the front console box.

26. REMOVE INSTRUMENT PANEL

- (a) Disconnect the junction connectors.

HINT:

The connectors can be disconnected by loosening the bolts.

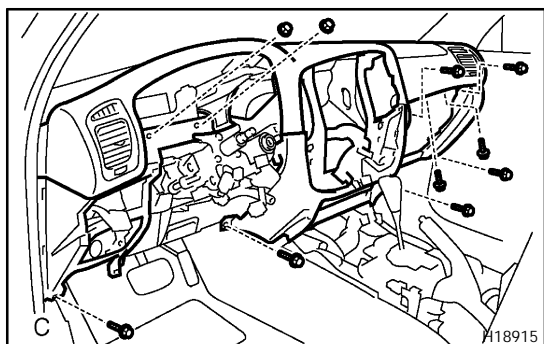

- (b) Disconnect the connector, then remove the 8 bolts, the 2 nuts and the instrument panel.

27. REMOVE ECU

28. REMOVE NO. 3 HEATER TO REGISTER DUCT

29. REMOVE NO. 4 HEATER TO REGISTER DUCT

30. REMOVE GLOVE COMPARTMENT DOOR DAMPER

31. REMOVE FLOOR BRACE

32. REMOVE NO. 1 BRACE

33. REMOVE REINFORCEMENT