

INSTALLATION

1. INSTALL REINFORCEMENT
2. INSTALL NO. 1 BRACE
3. INSTALL FLOOR BRACE
4. INSTALL GLOVE COMPARTMENT DOOR DAMPER
5. INSTALL NO. 4 HEATER TO REGISTER DUCT
6. INSTALL NO. 3 HEATER TO REGISTER DUCT
7. INSTALL ECU

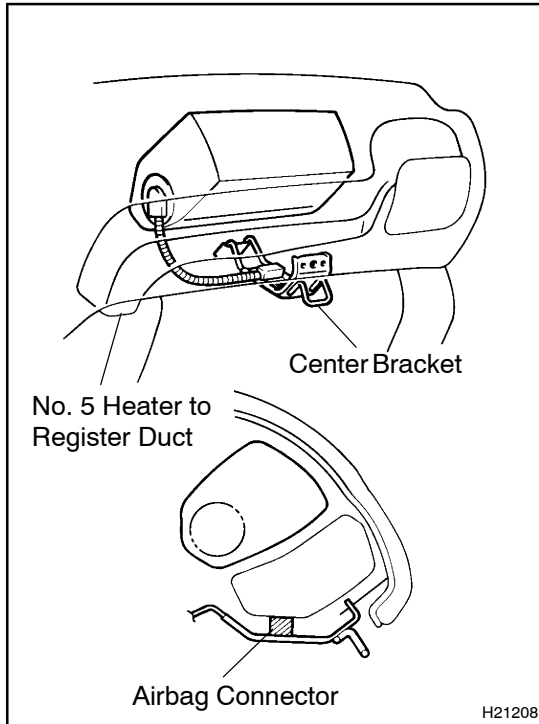

8. INSTALL INSTRUMENT PANEL

HINT:

- Install the airbag connector between the No. 5 heater to register duct and the center bracket temporarily, then install the instrument panel.
 - Remove the airbag connector before installing the lower No. 2 panel.
- (a) Install the 6 bolts, the 2 nuts and the instrument panel, then connect the connectors.
 - (b) Install the 2 bolts to the front passenger airbag assembly.
Torque: 20 N·m (204 kgf·cm, 15 ft·lbf)
 - (c) Connect the junction connectors.

HINT:

The connectors can be connected by tightening the bolts.

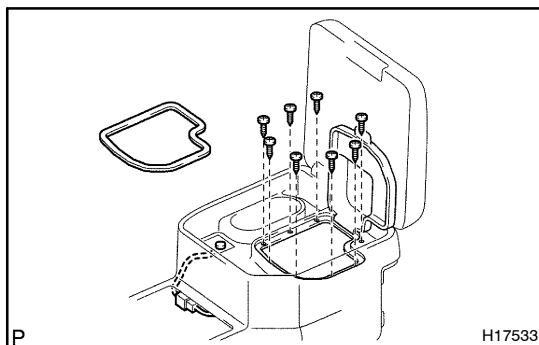

9. INSTALL FRONT CONSOLE BOX AND REAR CONSOLE BOX

- (a) w/ Cool box:
Install the front console box and the rear console box with the 8 screws.
- (b) w/ Cool box:
Install a new door packing.
- (c) w/ Cool box:
Connect the connector.
- (d) w/ Cool box:
Install the 2 bolts and the 8 screws.

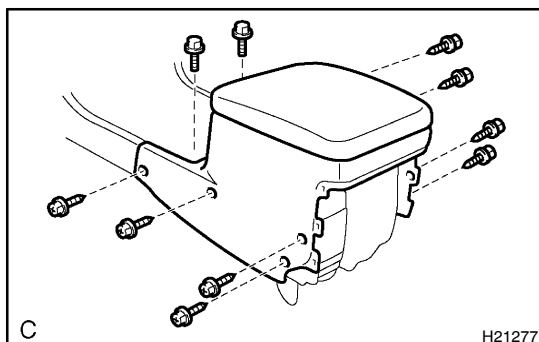

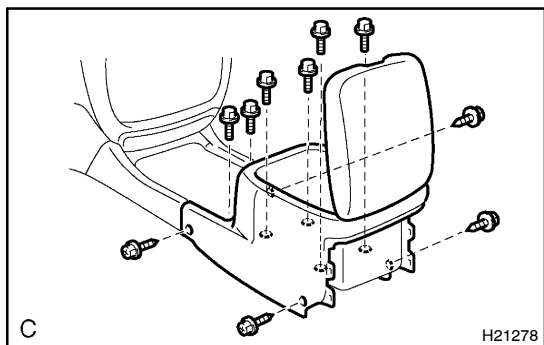

- (e) w/o Cool box:
Install the front console box and the rear console box with the 6 bolts and the 4 screws.

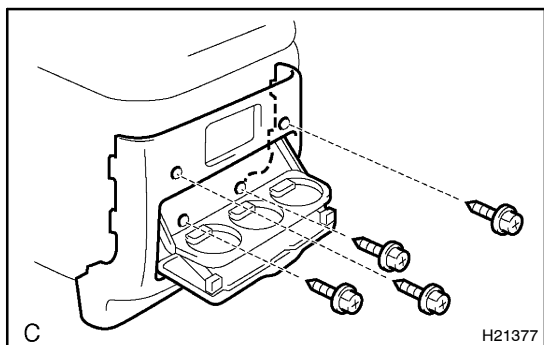

10. INSTALL CONSOLE REAR END PANEL

- (a) w/ Rear Radio Control or Rear Heater Control:
Install the rear radio control or the rear heater control with the 3 screws.
(b) Install the console rear end panel with the 4 screws.
(c) w/o Rear Radio Control and Rear Heater Control:
Install the rear switch hole cover.

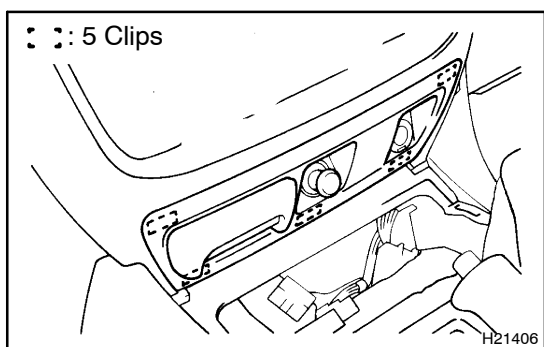

11. INSTALL CENTER LOWER CLUSTER FINISH PANEL

Connect the connector, then install the center lower cluster finish panel.

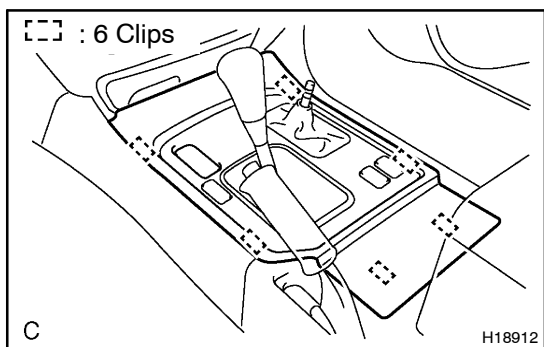

12. INSTALL FRONT CONSOLE PANEL

Install the front console panel, then install the transfer shift lever knob.

13. INSTALL RADIO WITH A/C CONTROL ASSEMBLY

HINT:

w/ Navigation System:

When removing/installing or replacing EMV, or when disconnecting/connecting the battery terminal, turn the IG ON and OFF twice for initial display setting.

14. INSTALL CENTER REGISTER

Connect the connector, then install the center registers.

15. INSTALL LOWER NO. 2 PANEL

Install the lower No. 2 panel with the 3 screws.

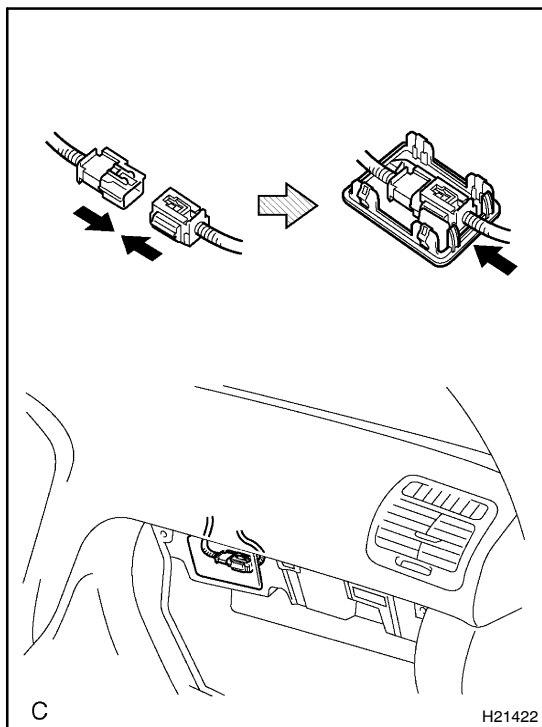
**16. CONNECT AIRBAG CONNECTOR (See page RS-42)****17. INSTALL GLOVE COMPARTMENT DOOR**

- (a) Connect the glove compartment door damper clip, then install the glove compartment door.
- (b) Install the 2 screws.

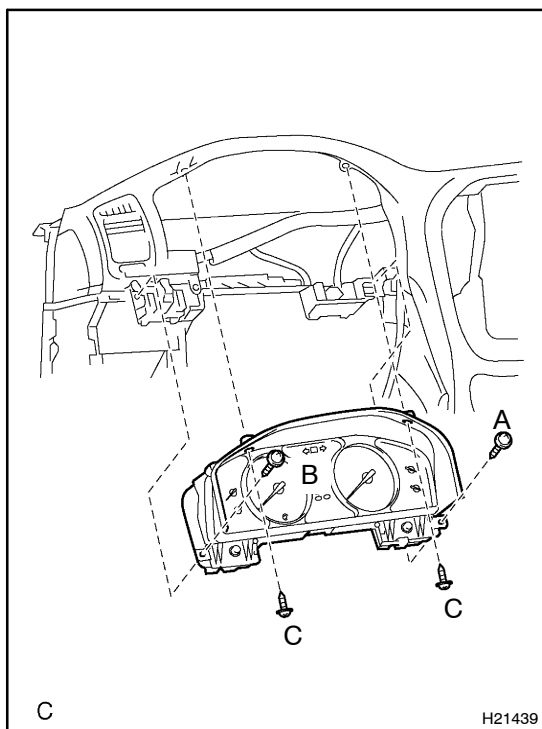
**18. INSTALL COMBINATION METER**

- (a) Check that the set -in connectors are connected securely in the installation holes on the instrument panel.
- (b) Place the combination meter on the instrument panel.
- (c) Install the combination meter by tightening the screws, "A", "B" and "C" in order.

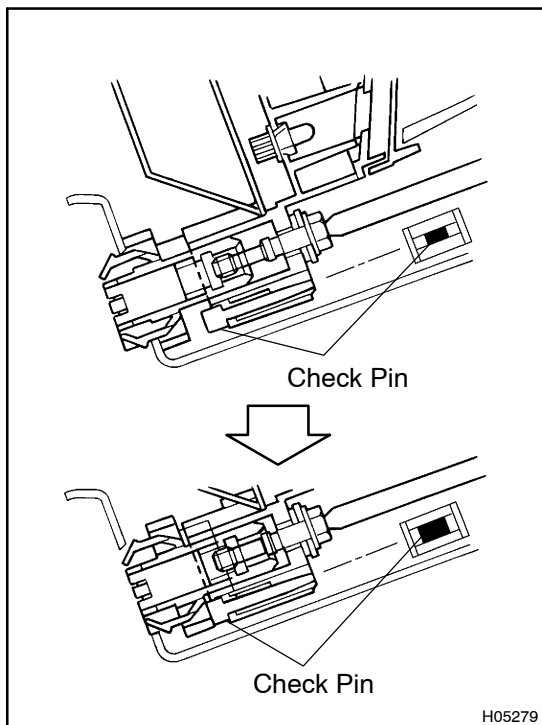

(d) Tighten the connection bolts.

HINT:

- When connection completes, the bolts turn idly, causing turning noise.
- Check that the connection check pins protrude from the lower side of the connection bolts.

NOTICE:

Follow the procedures in the order of (c) and (d). Otherwise, set-in connectors on the wire harness side and connectors on the meter side might not be connected properly.

19. **INSTALL STEERING COLUMN** (See page SR-19 or See Pub.No. RM6 16E, page SR -24)

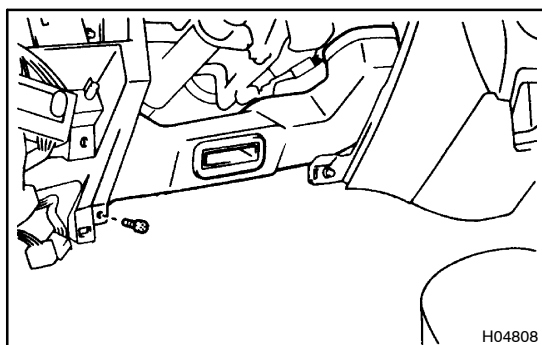

20. **INSTALL NO. 2 HEATER TO REGISTER DUCT**

Install the No. 2 heater to register duct with the screw.

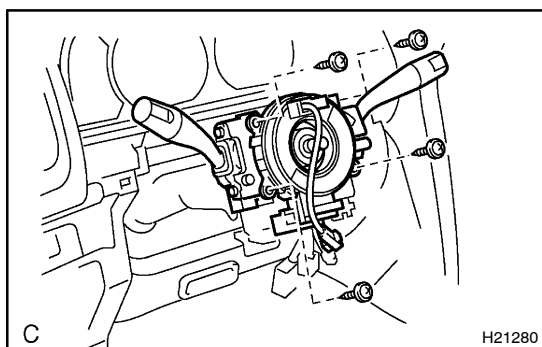

21. **INSTALL COMBINATION SWITCH**

- Install the combination switch with the 4 screws.
- Install the clamp, then connect the connectors.

22. **INSTALL COLUMN COVERS**

Install the column covers with the 3 screws.

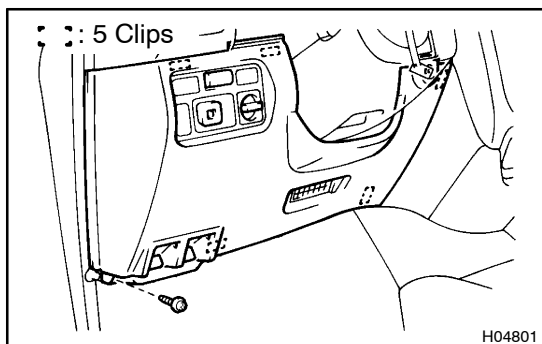

23. **INSTALL LOWER NO. 1 PANEL**

Connect the connector, then install the lower No. 1 panel with the screw.

24. **INSTALL HOOD LOCK CONTROL CABLE LEVER AND FUEL LID CONTROL CABLE LEVER**

- Install the fuel lid control cable lever with the 2 screws.
- Install the hood lock control cable with the 2 screws.

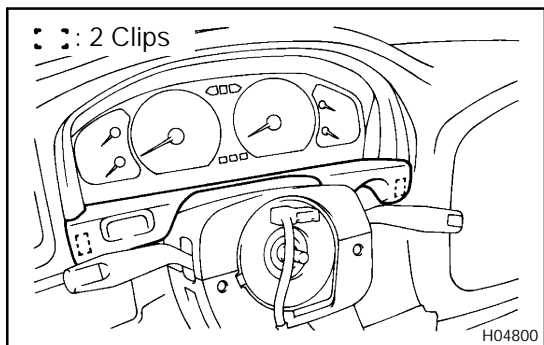
**25. INSTALL CLUSTER FINISH PANEL**

- (a) w/ Rheostat:
Connect the connector.

- (b) Install the cluster finish panel.

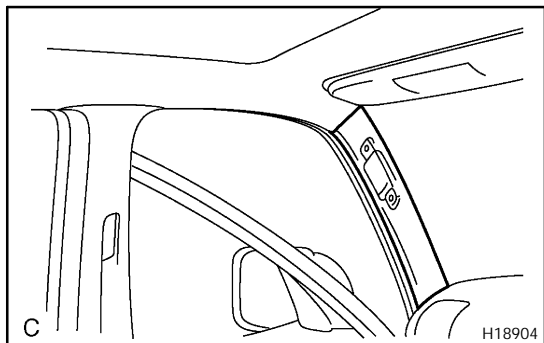
26. INSTALL STEERING WHEEL (See page SR-19 or See Pub. No. RM616E, page SR-24)**27. INSTALL FRONT PILLAR GARNISH**

- (a) Install the front pillar garnish.
(b) Use the same manner described above to the other side.

28. INSTALL FRONT ASSIST GRIP

- (a) Install the assist grip with the 2 screws, then install the 2 assist grip plugs.
(b) Use the same manner described above to the other side.

29. INSTALL FRONT DOOR OPENING TRIMS**30. INSTALL COWL SIDE TRIMS****31. INSTALL FRONT DOOR SCUFF PLATES**