

FRONT SEAT (Separate Type: Manual Adjuster)

COMPONENTS

BO1W7-02

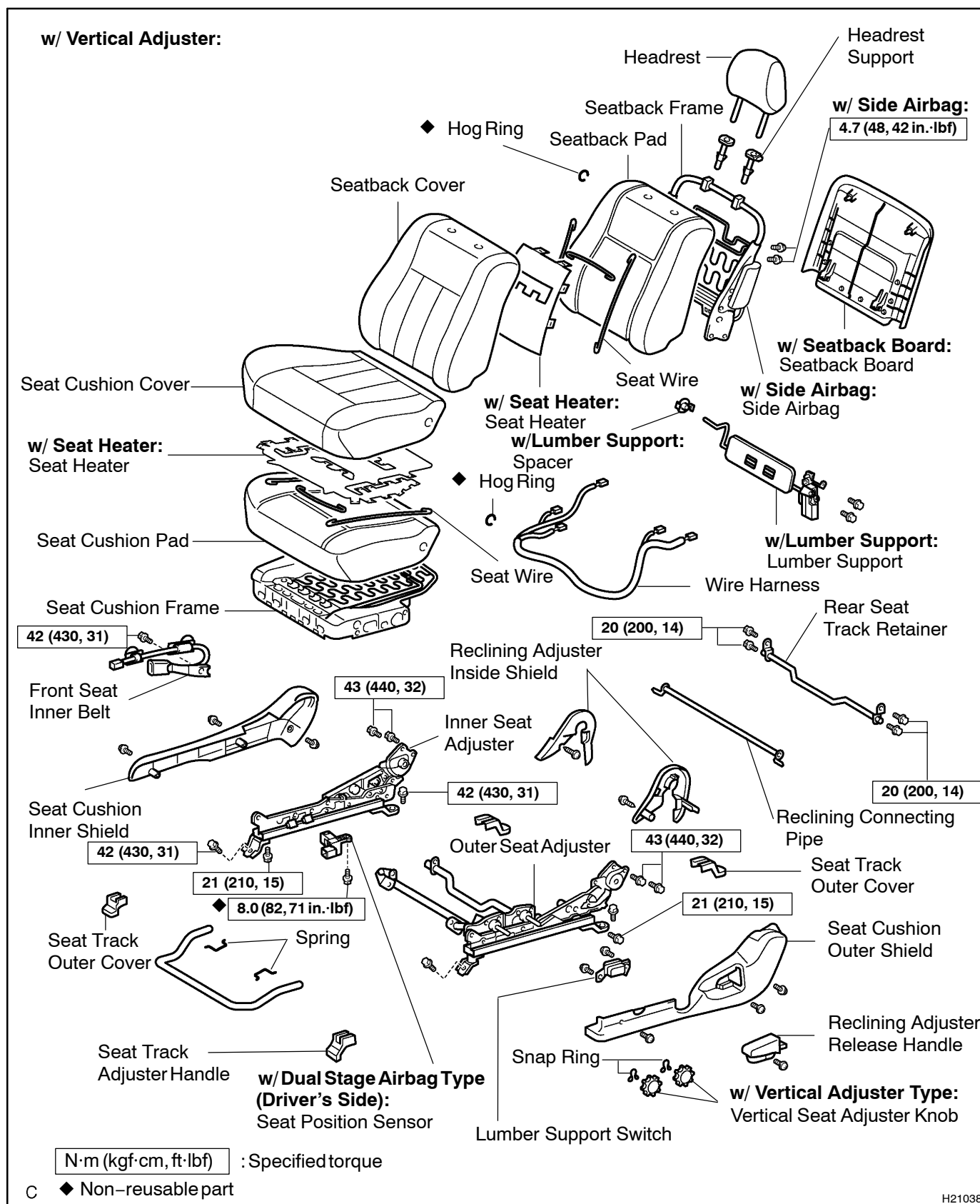

H21038

This diagram illustrates the assembly of a car seat, showing the following components and their assembly points:

- Seatback Frame**: The main structural frame for the seatback.
- Headrest**: The uppermost part of the seatback.
- Headrest Support**: The mechanism that allows the headrest to move up and down.
- Seatback Pad**: The padding for the seatback.
- Seatback Cover**: The outer fabric or leather covering for the seatback.
- Seat Cushion Cover**: The outer fabric or leather covering for the seat cushion.
- Seat Cushion Pad**: The padding for the seat cushion.
- Seat Cushion Frame**: The main structural frame for the seat cushion.
- Front Seat Inner Belt**: The inner part of the seat belt mechanism.
- Seat Cushion Inner Shield**: The inner protective shield for the seat cushion.
- Seat Track Outer Cover**: The outer cover for the seat track.
- Seat Track Adjuster Handle**: The handle used to adjust the seat position.
- Spring**: The coiled spring that provides support for the seat cushion.
- Seat Track Outer Cover**: The outer cover for the seat track.
- Seat Track Adjuster Handle**: The handle used to adjust the seat position.
- Seat Cushion Outer Shield**: The outer protective shield for the seat cushion.
- Reclining Adjuster Release Handle**: The handle used to release the reclining mechanism.
- Reclining Connecting Pipe**: The pipe that connects the reclining mechanism to the seat frame.
- Reclining Adjuster Inside Shield**: The inner shield for the reclining adjuster.
- Outer Seat Adjuster Seat Track Outer Cover**: The outer cover for the outer seat adjuster.
- Rear Seat Track Retainer**: The retainer for the rear seat track.

The diagram also includes several numbered callouts indicating specific assembly points or part numbers:

- 20 (200, 14)**: Two locations on the rear seat track retainer.
- 42 (430, 31)**: Three locations on the front seat inner belt and seat track adjuster handle.
- 43 (440, 32)**: One location on the seat cushion inner shield.
- 21 (210, 15)**: Two locations on the seat track outer cover.

◆ Non-reusable part