

REPLACEMENT

HINT:

- Following is the seat heater replacement procedure.
- Care should be taken during operation to protect the seat cover from scratches, dirt or accidental cut of thread.

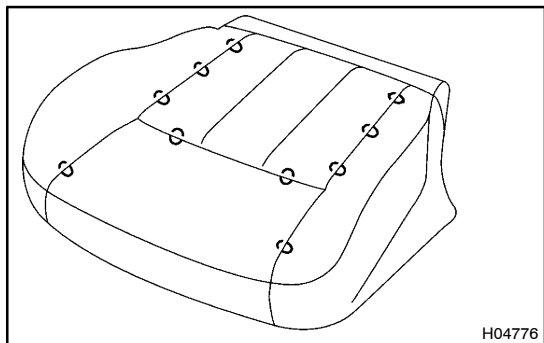

1. Seat cushion cover:

REMOVE SEAT HEATER

- Remove the hog rings.
- Remove the seat cushion cover from the pad.
- Turn the seat cushion cover inside out.

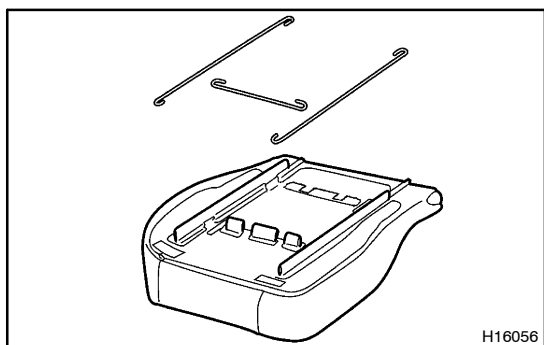

- Disconnect the 3 seat wires.

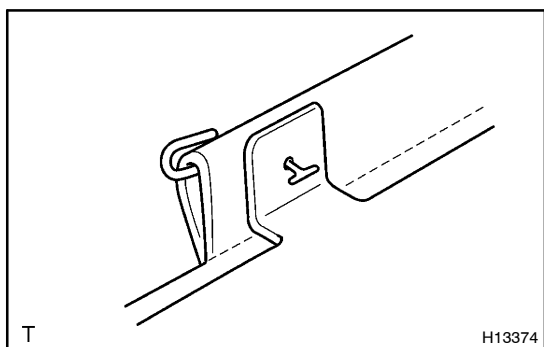

- Remove the tack pins which are fastened to the heater.
- Remove the seat heater from the seat cushion cover.

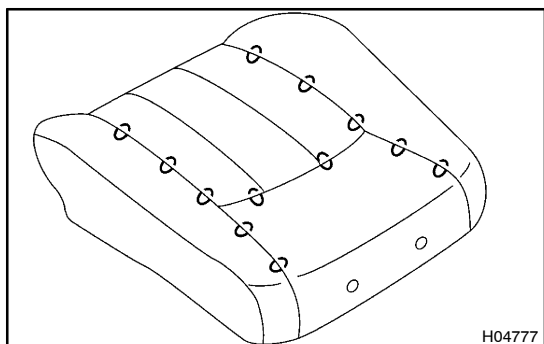

2. Seatback cover:

REMOVE SEAT HEATER

- Remove the hog rings and the wires.
- Remove the seatback cover from the pad.
- Turn the seatback cover inside out.

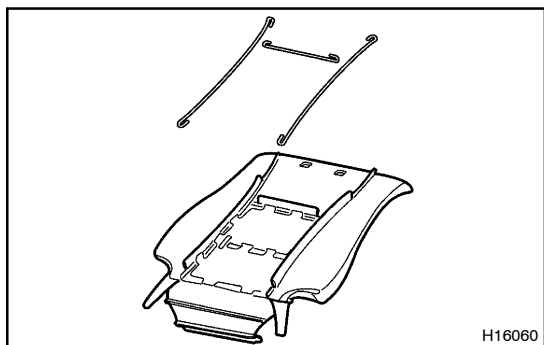

(d) Disconnect the 3 seat wires.

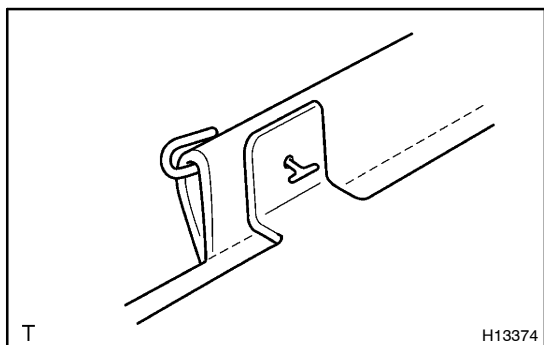

(e) Remove the tack pins which are fastened to the seat heater.

(f) Remove the seat heater from the seatback cover.

3. INSTALL NEW SEAT HEATER TO SEAT COVER

Using a tacker, install a new seat heater to the seat cushion cover with tack pins.

Tacker: BANZAI 303XT or equivalent

NOTICE:

Do not substitute other metal parts for the of tack pins. Insufficient distance between the heater and the cover may result in damage to the heater.

HINT:

- Fasten the cover and the heater with the tack pins matching the seam with the V slit of the heater.
- Sewing thread can be substituted for the tack pins. However, allow a distance of 6 – 7 mm (0.24 – 0.28 in.) between both sewed parts of the heater and the cover.

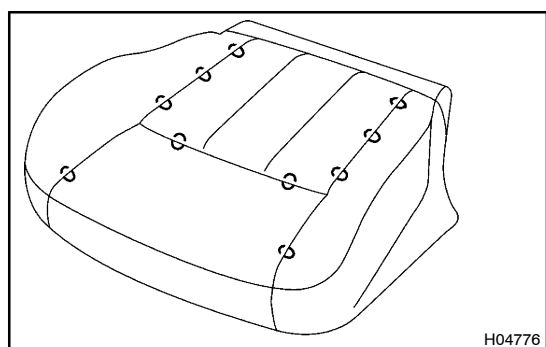
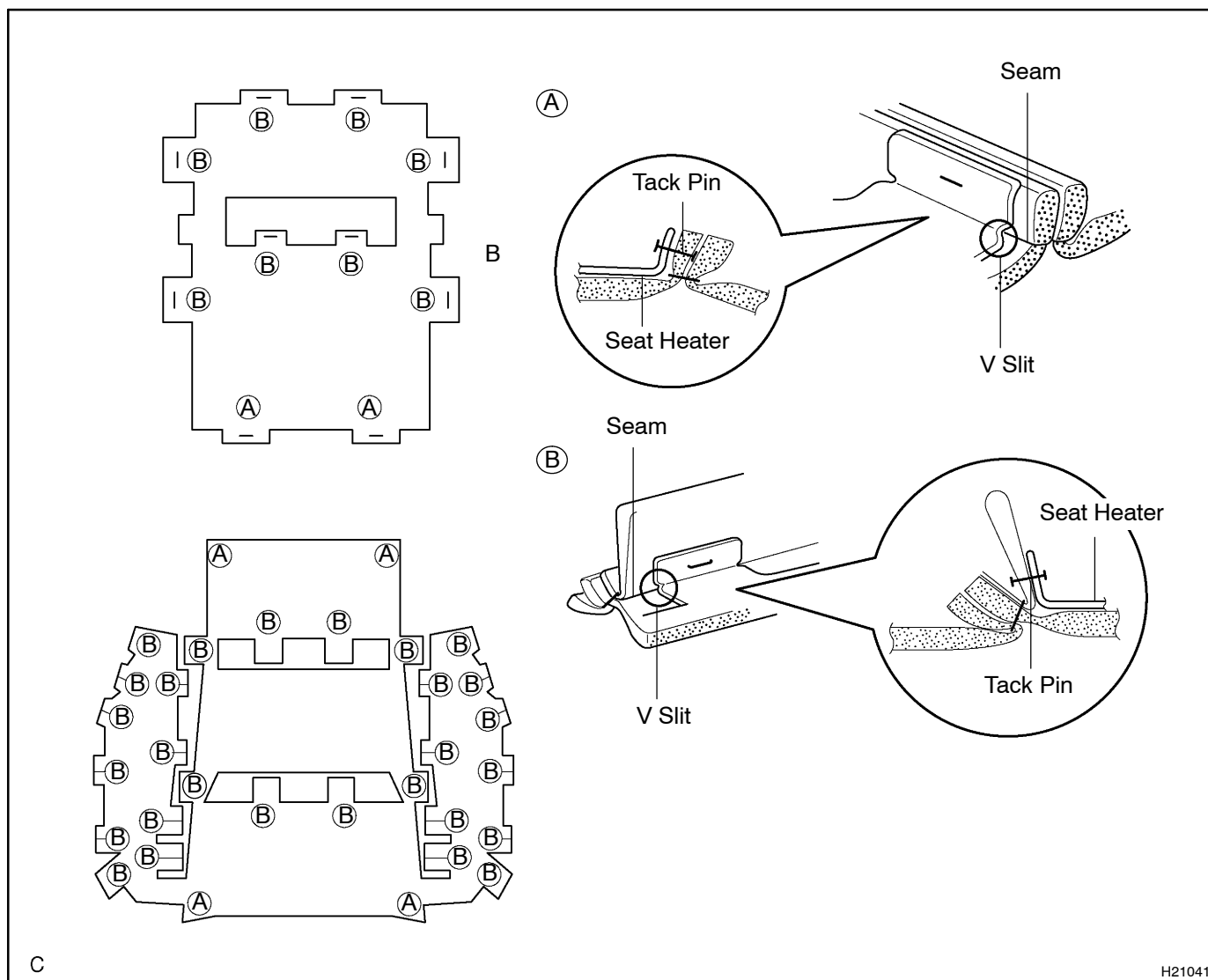

4. INSTALL SEAT CUSHION COVER TO SEAT CUSHION PAD

- Thread the 3 wires through the listing pocket.
- Install the seat cushion cover with new hog rings.
- Reverse turn the seat cushion cover inside out to put it back to its original position.

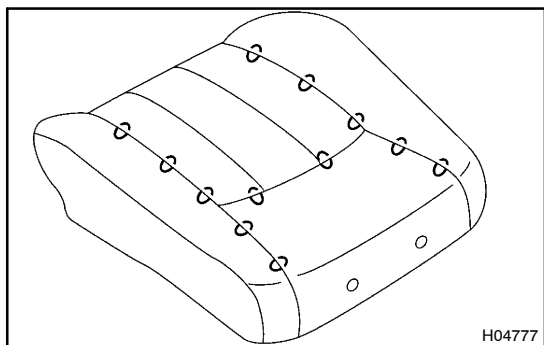
**5. INSTALL SEATBACK COVER TO PAD**

- (a) Thread the 3 wires through the listing pocket.
- (b) Turn the seatback cover inside out to put it back to its original position.
- (c) Install the seatback cover to pad with new hog rings.