

## INSPECTION

### CAUTION:

Replace the seat belt assembly (outer belt, inner belt, bolts, nuts or sill -bar) if it has been used in a severe impact. The entire assembly should be replaced even if damage is not obvious.

### 1. Except manual type:

#### RUNNING TEST (IN SAFE AREA)

- (a) Fasten the front seat belts.
- (b) Drive the car at 10 mph (16 km/h) and slam on the brakes. Check that the belt locks and cannot be extended at this time.

### HINT:

Conduct this test in a safe area. If the belt does not lock, remove the belt mechanism assembly and conduct the following static check. Also, whenever installing a new belt assembly.

### 2. Driver's seat belt (ELR):

#### STATIC TEST

- (a) Make sure that the belt locks when pulled out quickly.
- (b) Remove the locking retractor assembly.

### HINT:

Before removing the pretensioner connector, be sure to read the precautionary notice in the RS section.

- (c) Tilt the retractor slowly.

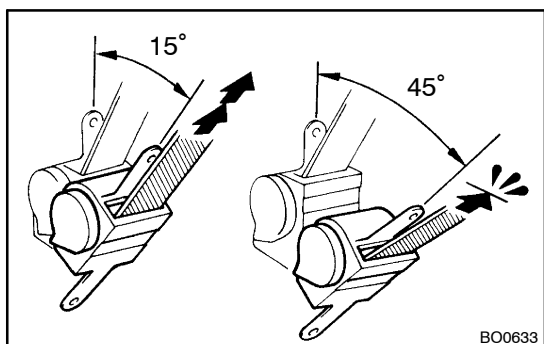
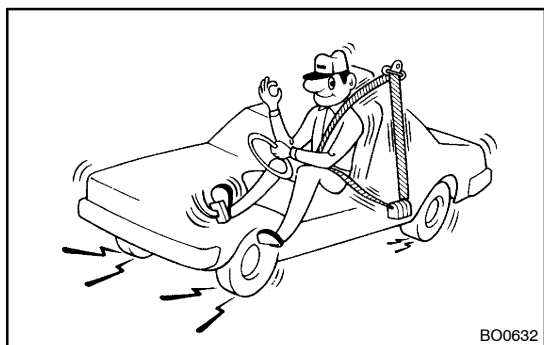

- (d) Make sure that the belt can be pulled out at a tilt of 15 degrees or less, and cannot be pulled out over 45 degrees of tilt.

If a problem is found, replace the assembly.

### 3. Except driver's seat belt (ELR/ALR):

#### STATIC TEST

- (a) Make sure that the belt locks when pulled out quickly.
- (b) Remove the locking retractor assembly.

### HINT:

Before removing the pretensioner connector, be sure to read the precautionary notice in the RS section.

- (c) Pull out the whole belt and measure the length of the whole belt.

Then retract the belt slightly and pull it out again

- (d) Make sure that the belt cannot be extended further.

If a problem is found, replace the assembly.

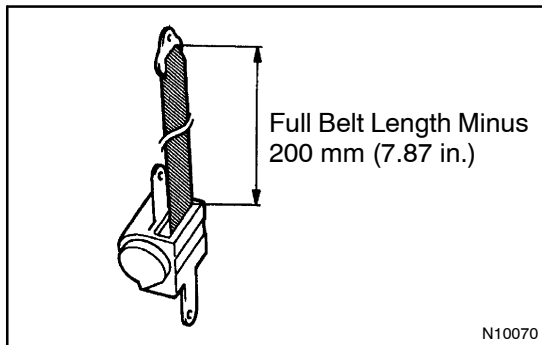

- (e) Retract the whole belt, then pull out the belt until 200 mm (7.87 in.) of the belt remaining in the retractor.
- (f) Tilt the retractor slowly.

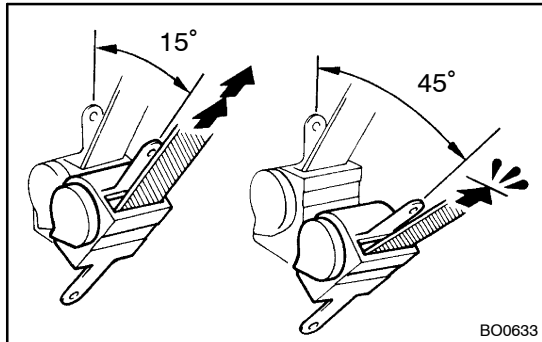

- (g) Make sure that the belt can be pulled out at a tilt of 15 degrees or less, and cannot be pulled out at over 45 degrees of tilt.

If a problem is found, replace the assembly.

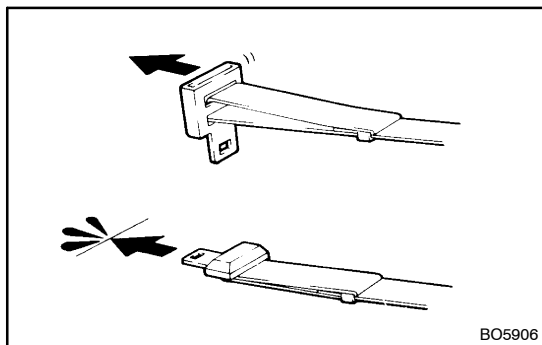

#### 4. Manual type: TESTING

- (a) Adjust the belt to the proper length.
- (b) Apply a firm load to the belt.
- (c) Make sure that the belt does not extend.

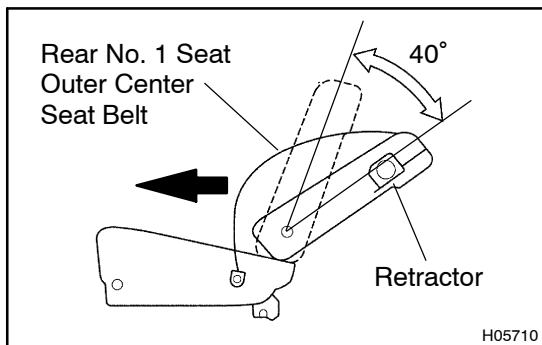

#### 5. INSPECT REAR NO. 1 SEAT CENTER BELT

- (a) After pulling out 300 mm (11.81 in.) of the seat belt, check that the belt is locked when pulled out quickly.
- (b) Check that the belt can be pulled out 300 mm (11.81 in.) without being locked when the seat is reclined as shown in the illustration.
- (c) Check that the belt is locked when the belt is pulled out by a certain amount under (a) condition.

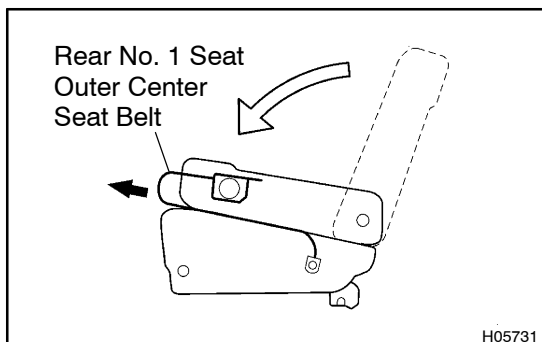

- (d) When folding down the seatback forward and extracting the seat belt slowly, check that the belt is locked after a certain length (approx. 500 mm (19.69 in.)) of the belt has been extracted.