

Position Sensor Power Source Circuit

CIRCUIT DESCRIPTION

This circuit provides power to the slide, front vertical and reclining position sensors.

WIRING DIAGRAM

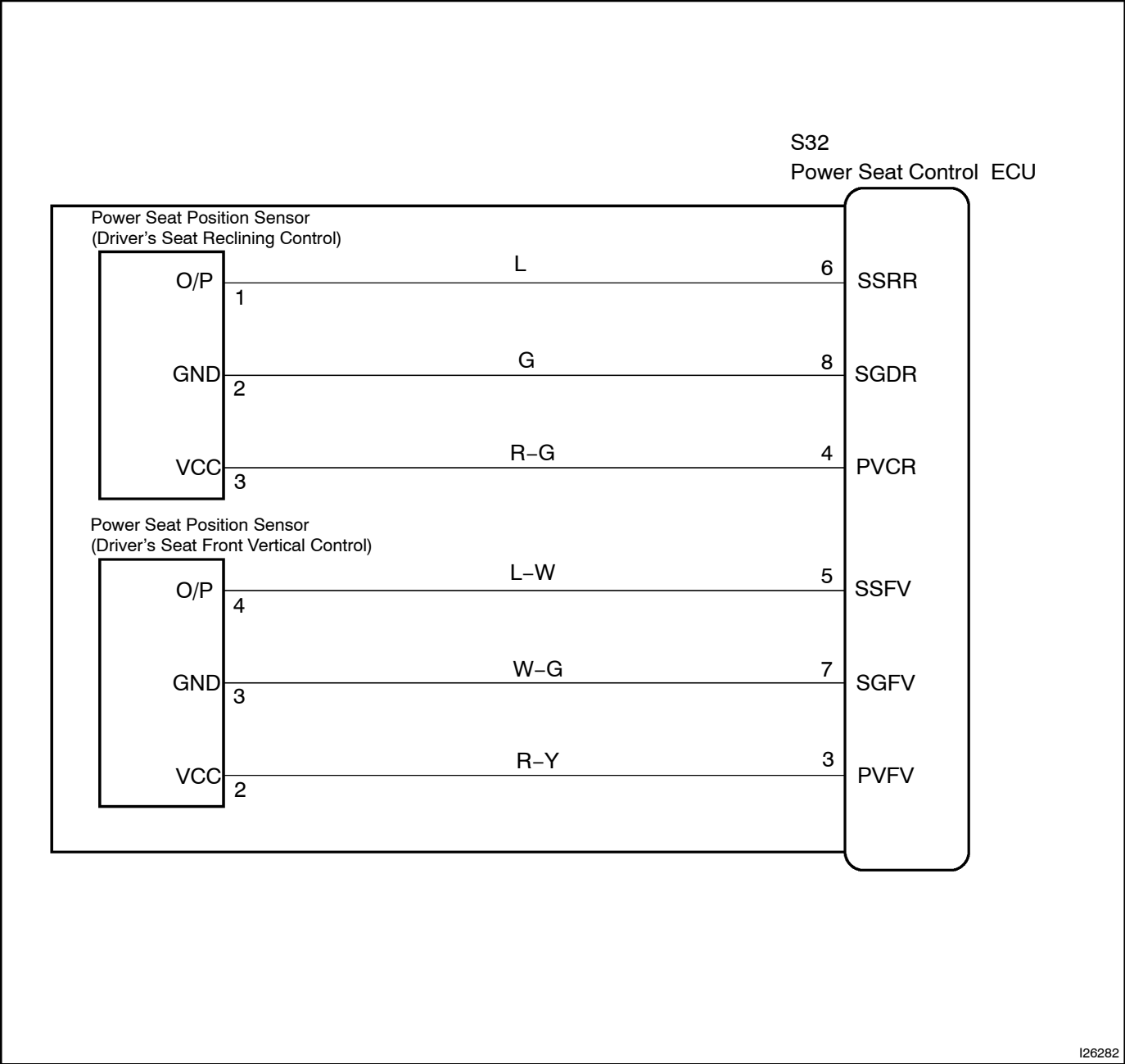

INSPECTION PROCEDURE

- | | |
|---|------------------------------------------------------------------------------------------------|
| 1 | Check voltage between terminal VCC of Power Seat Control ECU connector and body ground. |
|---|------------------------------------------------------------------------------------------------|

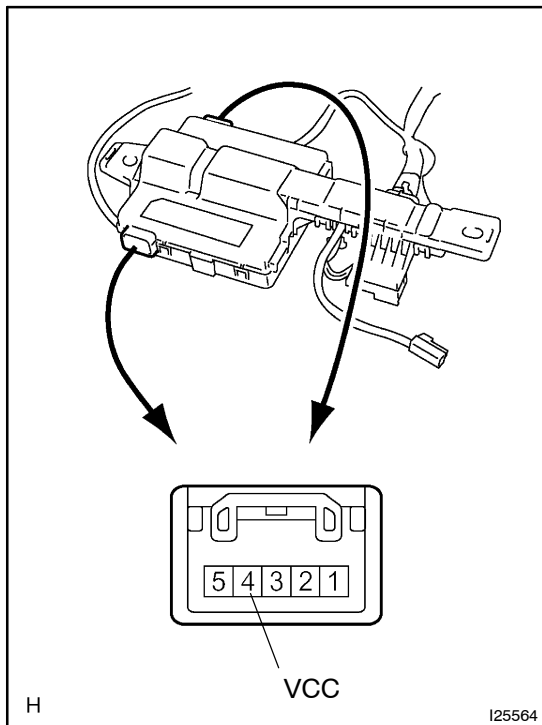
**PREPARATION:**

Remove Power Seat Control ECU with connectors connector being connected.

CHECK:

While operating the Power Seat Control Switch and moving the seat, check voltage between terminal VCC of Power Seat Control ECU connector and body ground.

OK:

Voltage: 7.2 – 8.8 V

OK

Proceed to next circuit inspection shown on problem symptom table ([See page DI-786](#)).

NG

- | | |
|---|--------------------------------------------------------------------------------------------------------------------------|
| 2 | Check harness and connector connected to terminal VCC of Power Seat Control ECU (See page IN-38). |
|---|--------------------------------------------------------------------------------------------------------------------------|

NG

Repair or replace harness or connector.

OK

Check and replace Power Seat Control ECU ([See page IN-38](#)).