

DTC	2 1	Solar Sensor Circuit
-----	-----	----------------------

CIRCUIT DESCRIPTION

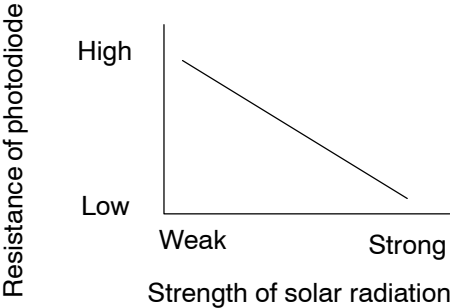

A photo diode in the solar sensor detects solar radiation and sends signals to the A/C amplifier.

DTC No	Detection Item	Trouble Area
21	Open or short in solar sensor circuit Please note that display of diagnostic trouble code 2 1 is not abnormal when the sensor is not receiving solar radiation	<ul style="list-style-type: none">• Solar sensor• Harness or connector between solar sensor and A/C amplifier• A/C amplifier

WIRING DIAGRAM

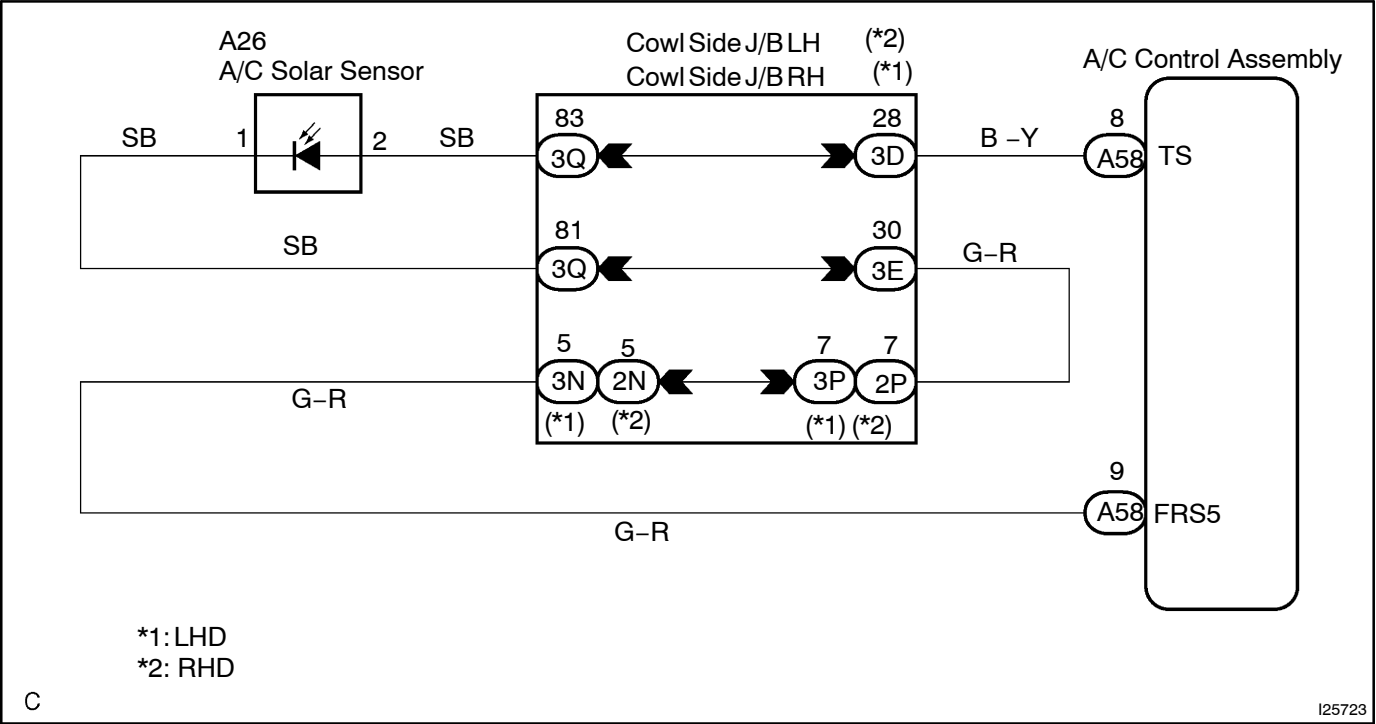

INSPECTION PROCEDURE

1 Check voltage between terminals TS and FRS5 of A/C amplifier.

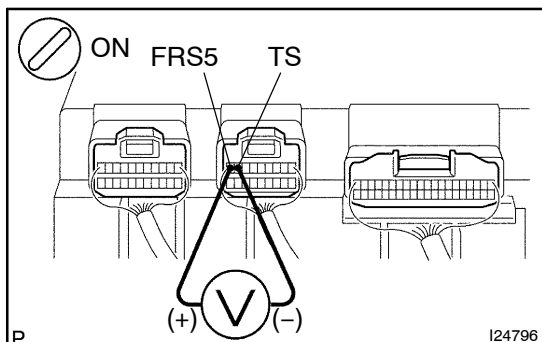
**PREPARATION:**

Remove A/C amplifier with connectors still connected.

CHECK:

- Turn ignition switch to ON.
- Measure voltage between terminals TS and FRS5 of A/C amplifier connector when the solar sensor is subjected to an electric light, and when the sensor is covered with a cloth.

OK:

Condition	Voltage
Sensor subjected to electric light	0.8 – 4.3 V
Sensor covered with a cloth	Below 0.8 V

HINT:

As the inspection light is moved away from the sensor, the voltage increases.

NG**Go to step 2.****OK**

Proceed to next circuit inspection shown on problem symptoms table (See page DI-1238). However, if DTC2 1 is displayed, check and replace A/C amplifier.

2 Check solar sensor.

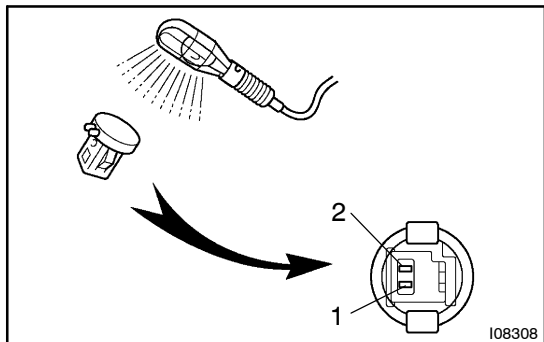

PREPARATION:

Remove solar sensor.

CHECK:

- Cover the sensor with a cloth.
- Measure resistance between terminals 1 and 2 of solar sensor connector.

HINT:

Connect positive (+) lead of ohmmeter to terminal 1 and negative (–) lead to terminal 2 of the solar sensor.

OK:

Resistance : $\infty \Omega$ (no continuity)

PREPARATION:

- Remove the cloth from the solar sensor and subject the sensor to electric light.
- Measure resistance.

OK:

Resistance : Approx. 4 k Ω (continuity)

HINT:

As the electric light is moved away from the sensor, the resistance increases.

NG

Replace solar sensor.

OK

3 Check harness and connector between A/C amplifier and solar sensor (See page IN-38).

NG

Repair or replace harness or connector.

OK

Check and replace A/C amplifier.