

DISASSEMBLY

NOTICE:

When using a vise, do not overtighten it.

1. SECURE PS GEAR ASSEMBLY IN VISE

Using SST, secure the gear assembly in a vise, as shown in the illustration.

SST 09630-00014 (09631-00142)

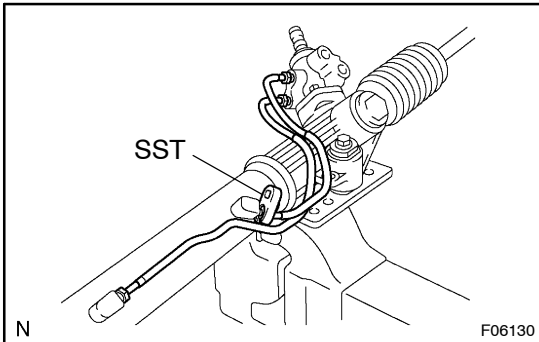

2. REMOVE 2 TURN PRESSURE TUBES

Using SST, remove the tube.

SST 09023-38200

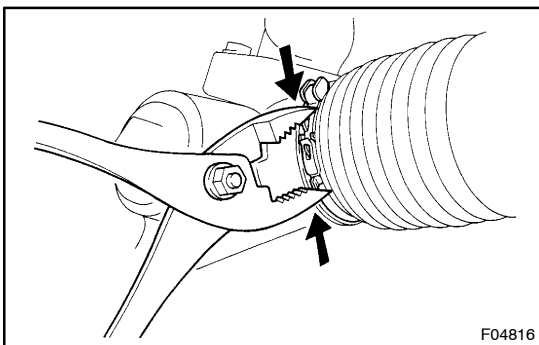

3. REMOVE RH AND LH CLIPS, RACK BOOTS AND CLAMPS

(a) Using pliers, loosen the clamp, as shown in the illustration.

NOTICE:

Be careful not to damage the boot.

(b) Remove the clip, rack boot and clamp.

(c) Employ the same manner described above to the other side.

HINT:

Mark the RH and LH rack boots.

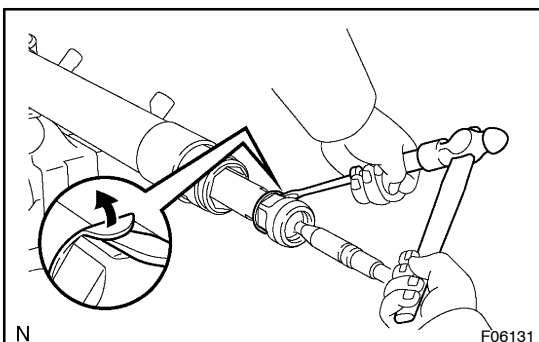

4. REMOVE RH AND LH RACK ENDS AND CLAW WASHERS

(a) Using a screwdriver and hammer, stake back the washer.

NOTICE:

Avoid and impact to the steering rack.

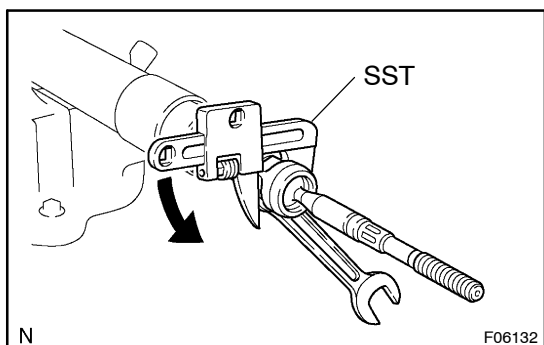

- (b) Using a spanner to hold the steering rack steady, and using SST, remove the rack end.
SST 09922-10010

NOTICE:

Use SST 09922-10010 in the direction shown in the illustration.

- (c) Remove the claw washer.
(d) Employ the same manner described above to the other side.

HINT:

Mark the RH and LH rack ends.

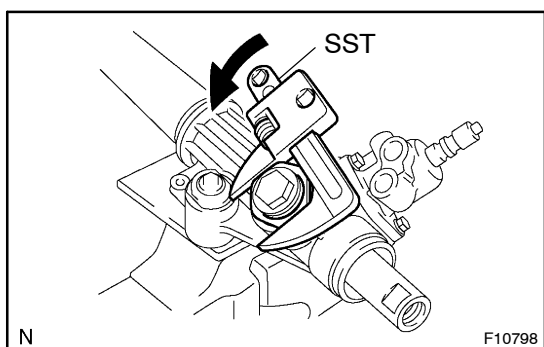

5. REMOVE RACK GUIDE SPRING CAP LOCK NUT

Using SST, remove the nut.

SST 09922-10010

NOTICE:

Use SST 09922-10010 in the direction shown in the illustration.

- 6. REMOVE RACK GUIDE SPRING CAP**
7. REMOVE RACK GUIDE SPRING AND RACK GUIDE SUB-ASSEMBLY
8. REMOVE DUST COVER
9. REMOVE CONTROL VALVE HOISING WITH CONTROL VALVE ASSEMBLY

- (a) Place matchmarks on the valve housing and rack housing.
(b) Remove the 2 bolts.
(c) Pull out the control valve assembly with the valve housing.
(d) Remove the O-ring from the valve housing.

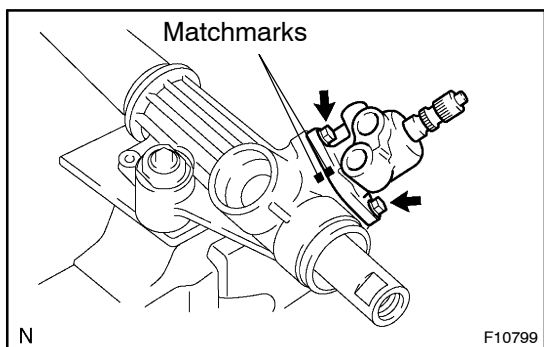

10. REMOVE CONTROL VALVE ASSEMBLY

- (a) Using SST, loosen the bearing guide nut.
SST 09631-20060

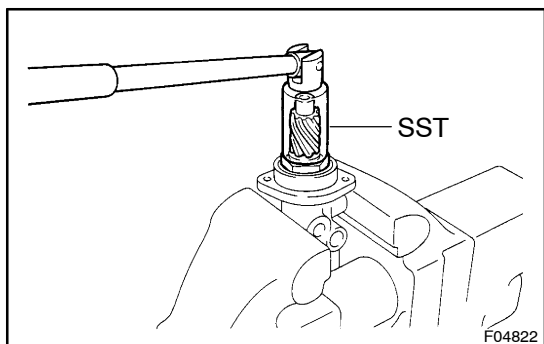

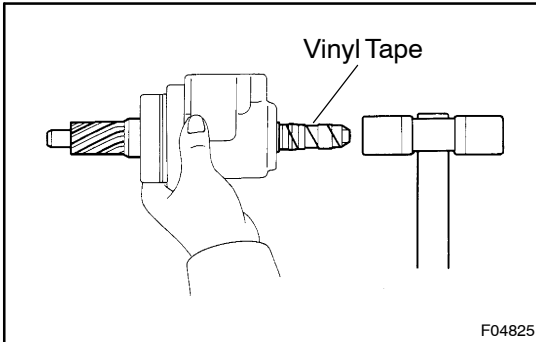

- (b) Wind vinyl tape to the control valve shaft.
- (c) Using a plastic hammer, tap out the valve assembly with the nut from the control valve housing.

NOTICE:

Be careful not to damage the oil seal lip.

- (d) Remove the nut from the valve assembly.

NOTICE:

Be careful not to damage the oil seal lip.

- (e) Remove the O-ring from the nut.

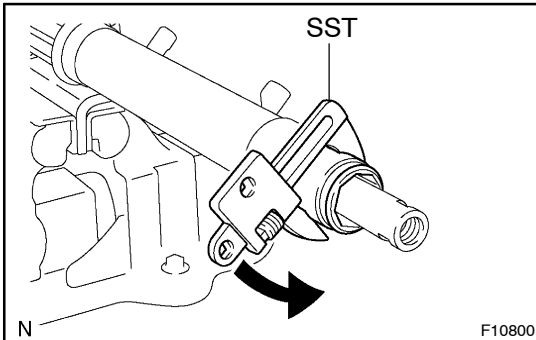
**11. REMOVE CYLINDER END STOPPER AND SPACER**

- (a) Using SST, remove the stopper.

SST 09922-10010

NOTICE:

Use SST 09922-10010 in the direction shown in the illustration.

- (b) Remove the O-ring from the stopper.

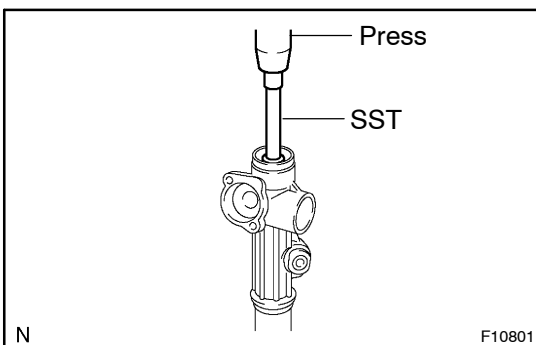
**12. REMOVE STEERING RACK AND OIL SEAL**

- (a) Using SST, press out the rack and oil seal.

NOTICE:

Take care not to drop the rack.

SST 09950-70010 (09951-07200)

- (b) Remove the oil seal from the rack.